

# MICHIGAN DEPARTMENT OF PUBLIC HEALTH WATER WELL AND PUMP RECORD

TAX NO:

PERMIT NO:  
**14836**

1. LOCATION OF WELL  
 County **MASON** Township Name **FREE SOIL** Fraction **SW 1/4 NW 1/4 NW 1/4** Section No. **9** Town No. **20N** Range No. **16W**

Distance and Direction from Road Intersection  
**On the east side of Tuttle Road**

Street Address & City of Well Location

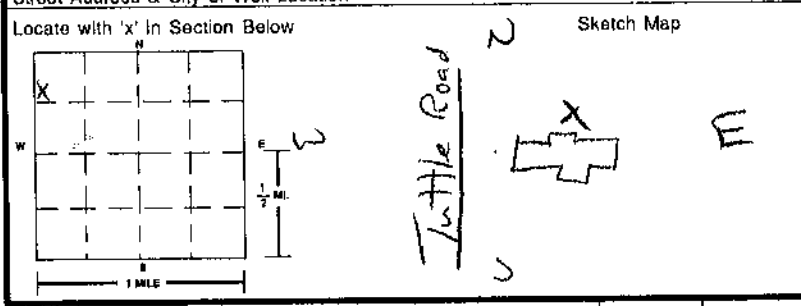

3. OWNER OF WELL  
 Address **E.C. Green  
Tuttle Road  
Free Soil, MI 49411**  
 Address Same as Well Location  Yes  No

4. WELL DEPTH: **40** ft. Date Completed **7/16/97**  New Well  Replacement Well

5.  Cable Tool  Rotary  Driven  Dug  
 Hollow Rod  Auger/Bored  Jettied

6. USE:  Household  Type I Public  Type III Public  
 Irrigation  Type IIa Public  Heat Pump  
 Test Well  Type IIb Public

7. CASING:  Steel  Threaded  Plastic  Welded  
 Other  
 Diameter: **4** in. to **36** ft. depth  
 BORE HOLE: **N/A** ft. depth  
 Height: Above/Below Surface: **1** ft  
 Weight: **11** lbs./ft.  
 Drive Shoe  Shale Packer

8. SCREEN:  Not Installed  Gravel-Packed  
 Type **Stainless Steel** Diameter **4"**  
 Slot **7** Length: **4'**  
 Set Between **36** ft. and **40** ft.  
 FITTINGS:  K-Packer  Bremer Check  
 Blank Above Screen  Other

9. STATIC WATER LEVEL:  
**7** ft. Below Land Surface  Flowing

10. PUMPING LEVEL: Below Land Surface  
**15** ft. After **1/2** hrs. Pumping at **10** G.P.M.  
 Plunger  Bailor  Air  Test Pump

11. WELL HEAD COMPLETION:  
 Pitless Adapter  12" Above Grade  
 Basement Offset  Well House

12. WELL GROUTED?  No  Yes From **0** to **36** ft.  
 Neat Cement  Bentonite  Other  
 No. of Bags **1** Additives

13. NEAREST SOURCE OF POSSIBLE CONTAMINATION:  
 Type **Septic** Distance **50+** ft. Direction **South**  
 Type \_\_\_\_\_ Distance \_\_\_\_\_ ft. Direction \_\_\_\_\_

14. PUMP:  Not Installed  Pump Installation Only  
 Manufacturer's Name **STA-RITE**  
 Model Number **10SP4C02H** HP **1/2** Volts **230**  
 Length of Drop Pipe **27'** ft. Capacity **10** G.P.M.  
 TYPE:  Submersible  Other  
 PRESSURE TANK:  
 Manufacturer's Name **Well-X-Trol**  
 Model Number **WX050UG** Capacity \_\_\_\_\_ Gallons **44**

2. FORMATION DESCRIPTION	THICKNESS OF STRATUM	DEPTH TO BOTTOM OF STRATUM
Sand	20	20
Gray Clay	14	34
Coarse Sand	6	40
Sand & Red Clay 40' ----		
<b>RECEIVED ON</b>		
<b>JUL 28 1997</b>		
<b>MANISTEE-MASON DISTRICT HEALTH DEPARTMENT</b>		

15. ABANDONED WELL PLUGGED?  Yes  No  
 Casing Diameter **1 1/4** in. Depth **20** ft.  
 PLUGGING MATERIAL:  Neat Cement  Bentonite Slurry  
 Cement/Bentonite Slurry  Concrete Grout  Bentonite Chips  
 No. of Bags **1/2** Casing Removed?  Yes  No

16. REMARKS: (Elevation, Source of Data, etc.)

17. DRILLING MACHINE OPERATOR:  
 Employee  Subcontractor  
 Name **Daniel Cameron**

15. WATER WELL CONTRACTOR'S CERTIFICATION:  
 This well was drilled under my jurisdiction and this report is true to the best of my knowledge and belief.  
**Cameron Brothers, Inc.** 1960  
 REGISTERED BUSINESS NAME REGISTRATION NO.  
 Address **8736 N. U.S. 31 Free Soil, MI 49411**  
 Signed **Daniel Cameron** Date **7-22-97**  
 AUTHORIZED REPRESENTATIVE





