

TAX NO:

MICHIGAN DEPARTMENT OF PUBLIC HEALTH  
WATER WELL AND PUMP RECORD

PERMIT NO:

1. LOCATION OF WELL  
County Barry

Township Name Assyria

Fraction 1/4 1/4 1/4

Section No. 27

Town No. 1 N

Range No. 7 W

Distance and Direction from Road Intersection

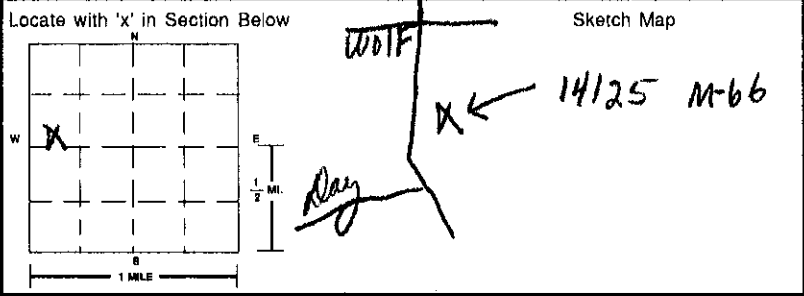

3. OWNER OF WELL  
Address Daisy Hoag  
14125 M-66  
Bellevue MI 49021  
Address Same as Well Location  Yes  No

4. WELL DEPTH: 117 ft. Date Completed 1-24-96  
 New Well  Replacement Well

5.  Cable Tool  Rotary  Driven  Dug  
 Hollow Rod  Auger/Bored  Jetted

6. USE:  Household  Type I Public  Type III Public  
 Irrigation  Type IIa Public  Heat Pump  
 Test Well  Type IIb Public

7. CASING:  Steel  Threaded  Welded  
 Plastic  Other  
Height: 0 Above Below Surface: 1 1/2 ft.  
Diameter: 4 in. to 108 ft. depth Weight: 11 lbs./ft.  
BORE HOLE:  Drive Shoe  Shale Packer  
Diameter: \_\_\_\_\_ in. to \_\_\_\_\_ ft. depth

8. SCREEN:  Not Installed  Gravel-Packed  
Type \_\_\_\_\_ Diameter \_\_\_\_\_  
Slot/Gauze \_\_\_\_\_ Length: \_\_\_\_\_  
Set Between \_\_\_\_\_ ft. and \_\_\_\_\_ ft.  
FITTINGS:  K-Packer  Bremer Check  
 Blank Above Screen \_\_\_\_\_ ft. Other \_\_\_\_\_

9. STATIC WATER LEVEL: 20 ft. Below Land Surface  Flowing

10. PUMPING LEVEL: Below Land Surface 40 ft. Alter 1 hrs. Pumping at 15 G.P.M.  
 Plunger  Bailer  Air  Test Pump

11. WELL HEAD COMPLETION:  Pitless Adapter  12" Above Grade  
 Basement Offset  Well House

12. WELL GROUTED?  No  Yes From 0 to 108 ft.  
 Neat Cement  Bentonite  Other \_\_\_\_\_  
No. of Bags 4 Additives \_\_\_\_\_

13. NEAREST SOURCE OF POSSIBLE CONTAMINATION:  
Type fuel oil Distance 50+ ft. Direction W  
Type Septic Distance 80+ ft. Direction W

2. FORMATION DESCRIPTION	THICKNESS OF STRATUM	DEPTH TO BOTTOM OF STRATUM
Sandy Clay	10	10
UN-KNOWN	30	40
Muddy Sand <u>128ppm very very stinky water</u>	16	56
Clay	12	72
Stones (cobble)	4	76
sand	4	80
Clay	17	97
Sand	2	99
Sand Rock	18	117

14. PUMP:  Not Installed  Pump Installation Only  
Manufacturer's Name Grundfos  
Model Number JS1005 HP 1/2 Volts 230  
Length of Drop Pipe 50 ft. Capacity 10 G.P.M.  
TYPE:  Submersible  Jet  Other \_\_\_\_\_  
PRESSURE TANK:  
Manufacturer's Name used WellX Tron - WellX Tron  
Model Number WX200-WX200 Capacity 5-5 Gallons 2020

15. ABANDONED WELL PLUGGED?  Yes  No  
Casing Diameter 2 in. Depth 17 ft. open  
PLUGGING MATERIAL:  Neat Cement  Bentonite Slurry  
 Cement/Bentonite Slurry  Concrete Grout  Bentonite Chips  
No. of Bags 42 Casing Removed?  Yes  No

16. REMARKS: (Elevation, Source of Data, etc.)  
1 iron slight odor  
16 hard ONitrate

17. DRILLING MACHINE OPERATOR:  
 Employee  Subcontractor  
Name RAY

15. WATER WELL CONTRACTOR'S CERTIFICATION:  
This well was drilled under my jurisdiction and this report is true to the best of my knowledge and belief.  
Ray Leonard Cable Tool Well Drilling 13-0769  
REGISTERED BUSINESS NAME REGISTRATION NO.  
Address 12248 E. High Hat Crk. MI 49017  
Signed Ray Leonard Date 24 Jan 96  
AUTHORIZED REPRESENTATIVE

**BARRY**

1. LOCATION OF WELL

County: ~~Washtenaw~~ Township Name: **ASSURIA** Fraction:  $\frac{1}{4}$   $\frac{1}{4}$   $\frac{1}{4}$  Section Number: **27** Town Number: **T1** Range Number: **R7E W**

Distance And Direction From Road Intersection  
**1.2 mi S. of Day Rd on m-66 E. side**

Street Address & City of Well Location

3. OWNER OF WELL: **Steve Danlap**  
Address: **Rt 3 Bellevue MI 49021**  
Address Same As Well Location?  Yes  No

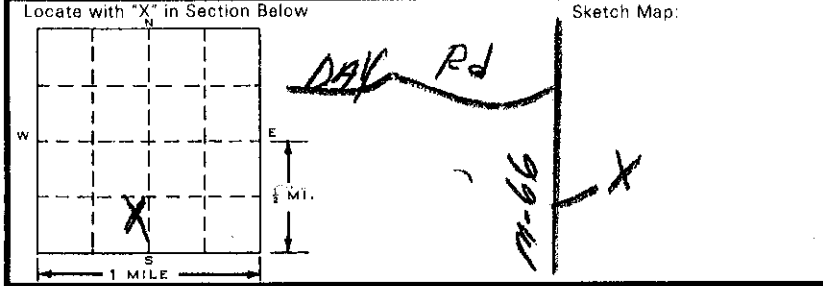

4. WELL DEPTH: (completed) **1-06'** ft. Date of Completion **1-16-87**

2. FORMATION DESCRIPTION

FORMATION DESCRIPTION	THICKNESS OF STRATUM	DEPTH TO BOTTOM OF STRATUM
<b>SAND &amp; GRAVEL</b>	<b>49</b>	<b>49</b>
<b>GRAY CLAY</b>	<b>2</b>	<b>51</b>
<b>SAND GRAVEL</b>	<b>55</b>	<b>106</b>

5.  Cable tool  Rotary  Driven  Dug  
 Hollow rod  Auger  Jetted

6. USE:  Domestic  Type I Public  Type III Public  
 Irrigation  Type IIa Public  Heat pump  
 Test Well  Type IIb Public

7. CASING: Diameter  Steel  Threaded  Plastic  Welded  
Height: Above/Below Surface **1** ft.  
Weight: \_\_\_\_\_ lbs./ft.  
Drive Shoe  Yes  No

8. SCREEN:  Not Installed  
Type: **stainless steel** Diameter: **4"**  
Slot/Groove: **1/2"** Length: **4'**  
Set between: **102** ft. and **106** ft.  
FITTINGS:  K-Packer  Lead Packer  Bronner Check  Blank above screen \_\_\_\_\_ ft. **Plastic Coupling**

9. STATIC WATER LEVEL: **30** ft. below land surface  Flow

10. PUMPING LEVEL: below land surface  
**40** ft. after **2** hrs. pumping at **15** G.P.M.  
\_\_\_\_\_ ft. after \_\_\_\_\_ hrs. pumping at \_\_\_\_\_ G.P.M.

11. WELL HEAD COMPLETION:  Pitless adapter  12" above grade  
 Basement offset  Approved pit

12. WELL GROUTED?  No  Yes From **0** to **102** ft.  
 Neat cement  Bentonite  Other: **DRILL TAILINGS Hole Plug**  
No. of bags of cement \_\_\_\_\_ Additives \_\_\_\_\_

13. Nearest source of possible contamination  
Type: **SEPTIC** Distance: **65** ft. Direction: **SW**  
Well disinfected upon completion?  Yes  No

14. PUMP:  Not Installed  Pump Installation Only  
Manufacturer's name: **TAIT**  
Model number: \_\_\_\_\_ HP: **1/2** Volts: **230**  
Length of Drop Pipe: **40** ft. capacity: **15** G.P.M.  
TYPE:  Submersible  Jet  
PRESSURE TANK: **WELL X TROL**  
Manufacturer's name: \_\_\_\_\_  
Model number: **203** Capacity: **10 GDD** Gallons

15. Remarks, elevation, source of data, etc.  
**RECEIVED**  
Mich. Dept. of Public Health  
**APR 10 1987**  
Bureau of Environmental Health Services  
Departmental Health Services

16. WATER WELL CONTRACTOR'S CERTIFICATION:  
This well was drilled under my jurisdiction and this report is true to the best of my knowledge and belief.  
**Edward Sullivan 23-1748**  
REGISTERED BUSINESS NAME: \_\_\_\_\_ REGISTRATION NO. \_\_\_\_\_  
Address: **210 N. Poplar Rd. Farmingtonville**  
Signed: **Richard C. ...** Date: **1-16-87**  
AUTHORIZED REPRESENTATIVE







MICHIGAN DEPARTMENT OF ENVIRONMENTAL QUALITY  
DRINKING WATER & RADIOLOGICAL PROTECTION DIVISION  
**WATER WELL AND PUMP RECORD**

Completion is required under authority of Part 127 Act 368 PA 1978  
Failure to comply is a misdemeanor

TAX NO:

PERMIT NO:

1. LOCATION OF WELL

County BARRY

Township Name ASSYRIA

Fraction NE 1/4 NW 1/4

Section No. 27

Town No. TIN

Range No. R7W

Distance and Direction from Road Intersection

Street Address & City of Well Location 8902 Wolf Rd

Locate with 'X' in Section Below

Sketch Map

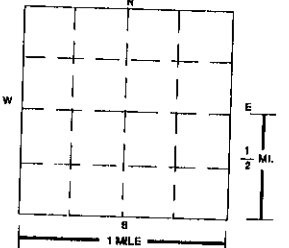

2. FORMATION DESCRIPTION

THICKNESS OF STRATUM DEPTH TO BOTTOM OF STRATUM

Brown Clay w/ gravel strks	6	6
Coarse gravel + sand	26	32
Brown Clay	1	33
Gravel w/ Brown Clay strks	4	37
Sand	7	44
Coarse gravel + sand	57	101
Gravel w/ gray clay strks.	20	121
Gray Clay	3	124
Clay w/ gravel strks.	16	140
Gravel w/ clay strks.	10	150
Soft broken rock	19	169
Water Bearing Rock	21	190

USE A 2ND SHEET IF NEEDED

15. ABANDONED WELL PLUGGED?  Yes  No  
Casing Diameter 2 in. Depth 111 ft.  
PLUGGING MATERIAL:  Neat Cement  Bentonite Slurry  
 Cement/Bentonite Slurry  Concrete Grout  Bentonite Chips  
No. of Bags 3/4 Casing Removed?  Yes  No

16. REMARKS: (Elevation, Source of Data, etc.)

17. DRILLING MACHINE OPERATOR:  
 Employee  Subcontractor  
Name Stan Schmanske

3. OWNER OF WELL  
Address Carol Kidden  
8902 Wolf Rd  
Address same as Well Location  Yes  No

4. WELL DEPTH: 190 ft. Date Completed 8-18-97  New Well  Replacement Well

5.  Cable Tool  Rotary  Driven  Dug  
 Hollow Rod  Auger/Bored  Jetted

6. USE:  Household  Type I Public  Type III Public  
 Irrigation  Type IIa Public  Heat Pump  
 Test Well  Type IIb Public

7. CASING:  Steel  Threaded  Plastic  Welded  
 Other \_\_\_\_\_ Height: 9 Above/Below Surface: \_\_\_\_\_ ft.  
Diameter: 5 in. to 169 ft. depth Weight: 3 lbs./ft.  
BORE HOLE: \_\_\_\_\_ in. to \_\_\_\_\_ ft. depth  
Diameter: 4.5 in. to 169 ft. depth  Drive Shoe  Shale Packer  
Diameter: 190 in. to \_\_\_\_\_ ft. depth

8. SCREEN:  Not Installed  Gravel-Packed  
Type \_\_\_\_\_ Diameter \_\_\_\_\_  
Slot/Gauze \_\_\_\_\_ Length: \_\_\_\_\_  
Set Between \_\_\_\_\_ ft. and \_\_\_\_\_ ft.  
FITTINGS:  K-Packer  Bremer Check  
 Blank Above Screen \_\_\_\_\_ ft. Other \_\_\_\_\_

9. STATIC WATER LEVEL: 55 ft. Below Land Surface  Flowing

10. PUMPING LEVEL: Below Land Surface 80 ft. After 15 hrs. Pumping at 65 G.P.M.  
 Plunger  Bailor  Air  Test Pump

11. WELL HEAD COMPLETION:  Pitless Adapter  12" Above Grade  Well House  
 Basement Offset

12. WELL GROUTED?  No  Yes From 0 to 169 ft.  
 Neat Cement  Bentonite  Other \_\_\_\_\_  
No. of Bags 19 Additives \_\_\_\_\_

13. NEAREST SOURCE OF POSSIBLE CONTAMINATION:  
Type SPS Distance 504 ft. Direction E.  
Type \_\_\_\_\_ Distance \_\_\_\_\_ ft. Direction \_\_\_\_\_

14. PUMP:  Not Installed  Pump Installation Only  
Manufacturer's Name Myers  
Model Number PP2st-72-12 HP 3/4 Volts 220  
Length of Drop Pipe 88 ft. Capacity 12 G.P.M.  
TYPE:  Submersible  Jet  Other \_\_\_\_\_

PRESSURE TANK:  
Manufacturer's Name Myers  
Model Number 52 Capacity 18 Gallons 18

18. WATER WELL CONTRACTOR'S CERTIFICATION:  
This well was drilled under my jurisdiction and this report is true to the best of my knowledge and belief.  
Katz Well Drilling Inc. 13-1593  
REGISTERED BUSINESS NAME REGISTRATION NO.  
Address 14779 E. Mich. Ave.  
Signed Stan Schmanske Date 8-18-97  
AUTHORIZED REPRESENTATIVE

TAX NO:

# MICHIGAN DEPARTMENT OF PUBLIC HEALTH WATER WELL AND PUMP RECORD

PERMIT NO:

9692

1. LOCATION OF WELL

County **BARRY**

Township Name **ASSYRIA**

Fraction **SE 1/4 SW 1/4**

Section No. **27**

Town No. **1N**

Range No. **7W**

Distance and Direction from Road Intersection  
**ON WEST SIDE OF M-66 1/4 MILE SOUTH OF DAY RD.**

3. OWNER OF WELL **SUSAN TOWNSEND**  
Address **14890 - M-66**

Street Address & City of Well Location

Address Same as Well Location  Yes  No

Locate with 'x' in Section Below

Sketch Map

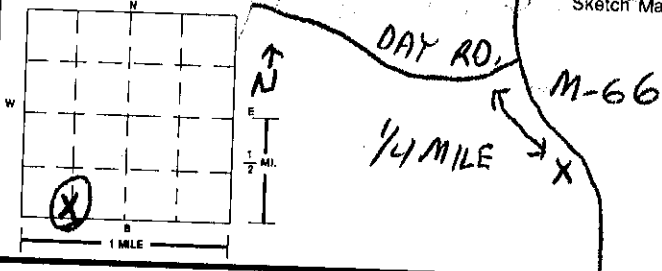

2. FORMATION DESCRIPTION

THICKNESS OF STRATUM

DEPTH TO BOTTOM OF STRATUM

0-7 CLAY + SAND	7	7
7-62 SAND + GRAVEL	55	62
62-70 CLAY	8	70
70-77 SAND	7	77
77-82 WATER BEARING SAND	5	82

4. WELL DEPTH: **82** ft. Date Completed **4/22/94**  New Well  Replacement Well

5.  Cable Tool  Rotary  Driven  Dug  
 Hollow Rod  Auger/Bored  Jetted

6. USE:  Household  Type I Public  Type III Public  
 Irrigation  Type IIa Public  Heat Pump  
 Test Well  Type IIb Public

7. CASING:  Steel  Threaded  Plastic  Welded  
 Other

Height: **Above** Below Surface: **0** ft

Diameter: **5** in. to **77** ft. depth Weight: **3** lbs./ft.

BORE HOLE: Diameter: **8** in. to **77** ft. depth  Drive Shoe  Shaile Packer

8. SCREEN:  Not Installed  Gravel-Packed  
Type **STAINLESS** Diameter **4"**  
Slot/auze **.015** Length: **4'**  
Set Between **77** ft. and **82** ft.  
FITTINGS:  X-Packer  Bremer Check  
 Blank Above Screen **1** ft. Other

9. STATIC WATER LEVEL: **16** ft. Below Land Surface  Flowing

10. PUMPING LEVEL: Below Land Surface **17** ft. After **1** hrs. Pumping at **30** G.P.M.  
 Plunger  Bailer  Air  Test Pump

11. WELL HEAD COMPLETION:  Pitless Adapter  12" Above Grade  
 Basement Offset  Well House

12. WELL GROUTED?  No  Yes From **0** to **77** ft.  
 Neat Cement  Bentonite  Other  
No. of Bags **4** Additives

13. NEAREST SOURCE OF POSSIBLE CONTAMINATION:  
Type **SOS** Distance **50+** Direction **N**  
Type \_\_\_\_\_ Distance \_\_\_\_\_ ft. Direction \_\_\_\_\_

14. PUMP:  Not Installed  Pump Installation Only  
Manufacturer's Name **MCDONALD**  
Model Number **21050K2** HP **1/2** Volts **230**  
Length of Drop Pipe **30** ft. Capacity **10** G.P.M.  
TYPE:  Submersible  Jet  Other

PRESSURE TANK:  
Manufacturer's Name **PERMA-AIR**  
Model Number **PAD-20** Capacity \_\_\_\_\_ Gallons

15. ABANDONED WELL PLUGGED?  Yes  No  
Casing Diameter **2** in. Depth **35** ft.  
PLUGGING MATERIAL:  Neat Cement  Bentonite Slurry  
 Cement/Bentonite Slurry  Concrete Grout  Bentonite Chips  
No. of Bags **13/4** Casing Removed?  Yes  No

16. REMARKS: (Elevation, Source of Data, etc.)

17. DRILLING MACHINE OPERATOR: **REG # 13-1605**  
 Employee  Subcontractor  
Name **MARC McKEAGUE**

15. WATER WELL CONTRACTOR'S CERTIFICATION:  
This well was drilled under my jurisdiction and this report is true to the best of my knowledge and belief.  
**KATZ WELL DRILLING INC. 13-1593**  
REGISTERED BUSINESS NAME REGISTRATION NO.  
Address **1479 E. MICH. AVE. BATTLE CREEK**  
Signed **Marc McKeague** Date **4-22-94**  
AUTHORIZED REPRESENTATIVE

RECEIVED  
MICH. DEPT. OF PUBLIC HEALTH  
APR 29 94  
BUREAU OF ENVIRONMENTAL  
AND OCCUPATIONAL HEALTH

USE A 2ND SHEET IF NEEDED



