

JUL-07 1999

**WATER WELL AND PUMP RECORD**

Completion is required under authority of Part 127 Act 368 PA 1978  
Failure to comply is a misdemeanor

PERMIT NO: 29592

TAX NO: 2211-24-2201

1. LOCATION OF WELL  
County: Westford

Township Name: IRWIN Fraction: 1/4 1/4 1/4 Section No: 22 Range No: 12

Distance and Direction from Road Intersection  
301 East Houston Street

Street Address & City of Well Location

3. OWNER: Renata J. Okoren  
Address: 301 East Houston St. Boon, MI 49618  
Address Same as Well Location:  Yes  No

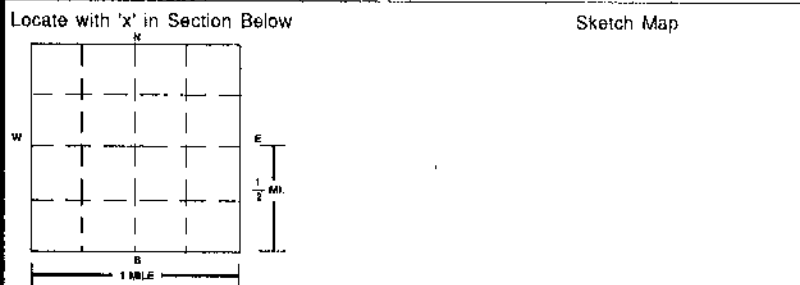

4. WELL DEPTH: 225 ft. Date Completed: 6/14/99  
 New Well  Replacement Well

5.  Cable Tool  Rotary  Driven  Dug  
 Hollow Rod  Auger/Bored  Jetted

6. USE:  Household  Type I Public  Type III Public  
 Irrigation  Type IIa Public  Heat Pump  
 Test Well  Type IIb Public

7. CASING:  Steel  Threaded  Plastic  Welded  Other  
Height: Above/Below Surface: 1 ft.  
Diameter: 5 in. to 28 ft. depth  
Weight: 500 lbs./ft.  
BORE HOLE: Diameter: 8 1/2 in. to 225 ft. depth  
 Drive Shoe  Shale Packer

2. FORMATION DESCRIPTION	THICKNESS OF STRATUM	DEPTH TO BOTTOM OF STRATUM
Top	1	1
Sand & Gravel & Clay	4	5
Sand & Gravel Mix	9	14
Clay & Sand Mix	11	25
Sand & Gravel & Clay Stringer	95	100
Sand & Gravel	15	135
Fine Sand & Clay Stringer	60	195
Med Sand & Clay Stringer	10	205
Med & Fine Sand Mix	20	225

8. SCREEN:  Not Installed  Gravel-Packed  
Type: Johnson Wap Diameter: Full 4"  
Slot/Gauze: 0.12 Length: 5'  
Set Between: 28 ft. and 225 ft.  
FITTINGS:  K-Packer  Bremer Check  
 Blank Above Screen 2 ft. Other

9. STATIC WATER LEVEL: 140 ft. Below Land Surface  Flowing

10. PUMPING LEVEL: Below Land Surface 205 ft. After \_\_\_\_\_ hrs. Pumping at \_\_\_\_\_ G.P.M.  
 Plunger  Bailor  Air  Test Pump

11. WELL HEAD COMPLETION:  Pitless Adapter  12" Above Grade  
 Basement Offset  Well House

12. WELL GROUTED?  No  Yes From 0 to 210 ft.  
 Neat Cement  Bentonite  Other  
No. of Bags: 12 Additives: E-Z MUD

13. NEAREST SOURCE OF POSSIBLE CONTAMINATION:  
Type: Septic Distance: 50' ft. Direction: E  
Type: \_\_\_\_\_ Distance: \_\_\_\_\_ ft. Direction: \_\_\_\_\_

USE A 2ND SHEET IF NEEDED

15. ABANDONED WELL PLUGGED?  Yes  No  
Casing Diameter \_\_\_\_\_ in. Depth \_\_\_\_\_ ft.  
PLUGGING MATERIAL:  Neat Cement  Bentonite Slurry  
 Cement/Bentonite Slurry  Concrete Grout  Bentonite Chips  
No. of Bags \_\_\_\_\_ Casing Removed?  Yes  No

14. PUMP:  No: Installed  Pump Installation Only  
Manufacturer's Name: Flint & Walling  
Model Number: 10 GPM HP 1 Volts: 230  
Length of Drop Pipe: 200 ft. Capacity: 10 G.P.M.  
TYPE:  Submersible  Jet  Other  
PRESSURE TANK: Manufacturer's Name: Well Rite  
Model Number: WR-140 Capacity: 44 Gallons

16. REMARKS: (Elevation, Source of Data, etc.)

17. DRILLING MACHINE OPERATOR:  
 Employee  Subcontractor  
Name: Rivara

18. WATER WELL CONTRACTOR'S CERTIFICATION:  
This well was drilled under my jurisdiction and this report is true to the best of my knowledge and belief.  
Jim Jeffers Well Drilling 87-1981  
REGISTERED BUSINESS NAME REGISTRATION NO.  
Address: 4498 13 Road Mendon, MI 49668  
Signed: Jim Jeffers Date: 7-5-99  
AUTHORIZED REPRESENTATIVE

**WATER WELL AND PUMP RECORD**

Completion is required under authority of Part 127 Act 368 PA 1978  
Failure to comply is a misdemeanor

TAX NO: **2111-34-2201**

PERMIT NO: **29149**

1. LOCATION OF WELL

County: **Westford** Township Name: **Boon** Fraction: **1/4 1/4** Section No.: **24** Town No.: **22** Range No.: **11**

Distance and Direction from Road Intersection  
**South 23 Road**

Street Address & City of Well Location

3. OWNER OF WELL  
Address: **William O'Koren**  
**381 East Houston St**  
**Boon, MI 49618**

Address Same as Well Location  Yes  No

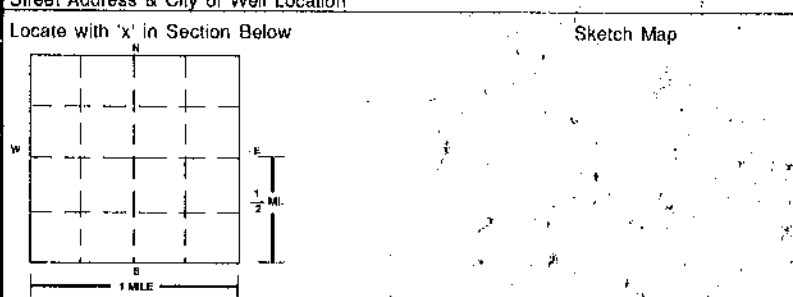

4. WELL DEPTH: **140** ft. Date Completed: **6-28-99**

New Well  
 Replacement Well

5.  Cable Tool  Rotary  Driven  Dug  
 Hollow Rod  Auger/Bored  Jetted

6. USE:  Household  Type I Public  Type III Public  
 Irrigation  Type IIa Public  Heat Pump  
 Test Well  Type IIb Public

7. CASING:  Steel  Threaded  Plastic  Welded  Other

Height: Above/Below Surface: 1 ft

Diameter: 5 in. to 135 ft. depth  
Weight: \_\_\_\_\_ lbs./ft.

BORE HOLE:  Drive Shoe  Shale Packer  
Diameter: 7/8 in. to 140 ft. depth

2. FORMATION DESCRIPTION	THICKNESS OF STRATUM	DEPTH TO BOTTOM OF STRATUM
Top Soil	1	1
SAND, GRAVEL	3	4
GRAVEL	11	15
SAND	42	57
SAND, (FINE)	23	80
SAND, RED CLAY STRINGERS	30	110
SAND, MEDIUM	36	140

8. SCREEN:  Not Installed  Gravel-Packed  
Type: PVC Diameter: 4"  
Slot Gauge: 20 Length: 5'  
Set Between: 135 ft. and 140 ft.

FITTINGS:  K-Packer  Bremer Check  
 Blank Above Screen  Other

9. STATIC WATER LEVEL: 80 ft. Below Land Surface  Flowing

10. PUMPING LEVEL: Developed Below Land Surface  
ft. After 12 hrs. Pumping at \_\_\_\_\_ G.P.M.

Plunger  Bailor  Air  Test Pump

11. WELL HEAD COMPLETION:  Bitless Adapter  12" Above Grade  
 Basement Offset  Well House

12. WELL GROUTED?  No  Yes From 0 to 125 ft.  
 Neat Cement  Bentonite  Other  
No. of Bags: 12 Additives

13. NEAREST SOURCE OF POSSIBLE CONTAMINATION:  
Type: Septic Distance: 50ft Direction: East  
Type: \_\_\_\_\_ Distance: \_\_\_\_\_ ft. Direction: \_\_\_\_\_

15. ABANDONED WELL PLUGGED?  Yes  No  
Casing Diameter \_\_\_\_\_ in. Depth \_\_\_\_\_ ft.

PLUGGING MATERIAL:  Neat Cement  Bentonite Slurry  
 Cement/Bentonite Slurry  Concrete Grout  Bentonite Chips  
No. of Bags \_\_\_\_\_ Casing Removed?  Yes  No

14. PUMP:  Not Installed  Pump Installation Only  
Manufacturer's Name: Myers  
Model Number: 25N75 HP: 3/4 Volts: 230  
Length of Drop Pipe: \_\_\_\_\_ ft. Capacity: \_\_\_\_\_ G.P.M.  
TYPE:  Submersible  Jet  Other

PRESSURE TANK: CHALLENGER  
Manufacturer's Name: PC III  
Model Number: \_\_\_\_\_ Capacity: 14 Gallons

16. REMARKS: (Elevation, Source of Data, etc.)

17. DRILLING MACHINE OPERATOR:  
 Employee  Subcontractor  
Name: Robert Stachnik

18. WATER WELL CONTRACTOR'S CERTIFICATION:  
This well was drilled under my jurisdiction and this report is true to the best of my knowledge and belief.

B.T. Sweetwater Drilling 2168  
REGISTERED BUSINESS NAME REGISTRATION NO. \_\_\_\_\_  
Address: 1637 M-37 South Lansing City  
Signed: Robert Stachnik Date: 7/9/99  
AUTHORIZED REPRESENTATIVE

RECEIVED SEP - 9 1999

MICHIGAN DEPARTMENT OF PUBLIC HEALTH  
**WATER WELL AND PUMP RECORD**

PERMIT NO: **23811**

TAX NO: **2211-14-4103**

1. LOCATION OF WELL  
 County **Wexford**

Township Name **Boon**

Fraction **1/4 1/4 1/4**

Section No. **24**

Town No. **22**

Range No. **11**

Distance and Direction from Road Intersection  
**3660 S 25 Rd**

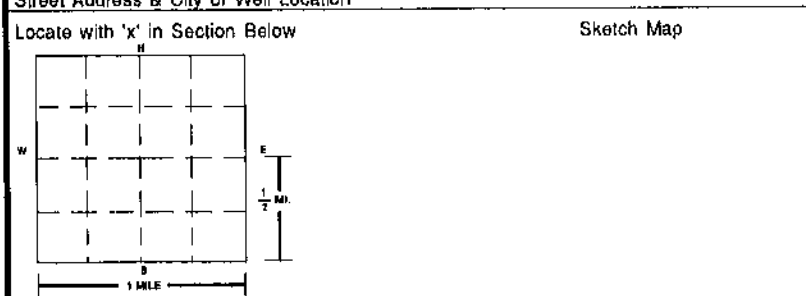

3. OWNER OF WELL  
 Address **Sherry Warfield**  
**3660 S 25 Rd**  
**Cadillac, MI 49601**

Address Same as Well Location  Yes  No

4. WELL DEPTH: **112** ft. Date Completed **9/22/95**

New Well  
 Replacement Well

5.  Cable Tool  Rotary  Driven  Dug  
 Hollow Rod  Auger/Bored  Jetted

6. USE:  Household  Type I Public  Type III Public  
 Irrigation  Type IIa Public  Heat Pump  
 Test Well  Type IIb Public

7. CASING:  Steel  Threaded  Plastic  Welded  
 Other

Height: **0** ft. Above/Below Surface

Diameter: **4** in. to **108** ft. depth

Weight: \_\_\_\_\_ lbs./ft.

BORE HOLE:  Drive Shoe  
 Shale Packer

8. SCREEN:  Not Installed  Gravel-Packed

Type **Stainless** Diameter **4"**

Slot/Gauze **7** Length: **4'**

Set Between **108** ft. and **112** ft.

FITTINGS:  K-Packer  Bremer Check  
 Blank Above Screen **1.5** ft. Other \_\_\_\_\_

9. STATIC WATER LEVEL:  
**82'** ft. Below Land Surface  Flowing

10. PUMPING LEVEL: Below Land Surface \_\_\_\_\_ ft. After \_\_\_\_\_ hrs. Pumping at \_\_\_\_\_ G.P.M.

Plunger  Bailor  Air  Test Pump

11. WELL HEAD COMPLETION:  
 Pitless Adapter  12" Above Grade  
 Basement Offset  Well House

12. WELL GROUTED?  No  Yes From **bentonite added**  
 Neat Cement  Bentonite  Other **as pipe was driven**

No. of Bags \_\_\_\_\_ Additives \_\_\_\_\_

13. NEAREST SOURCE OF POSSIBLE CONTAMINATION:  
 Type **septic** Distance **60** ft. Direction **S**  
 Type \_\_\_\_\_ Distance \_\_\_\_\_ ft. Direction \_\_\_\_\_

14. PUMP:  Not Installed  Pump Installation Only

Manufacturer's Name **Starrite**

Model Number **SP400J-02** HP **1/2** Volts **230**

Length of Drop Pipe **107** ft. Capacity **10** G.P.M.

TYPE:  Submersible  Jet  Other

PRESSURE TANK:  
 Manufacturer's Name **Well Mate**  
 Model Number **WM-11WB** Capacity \_\_\_\_\_ Gallons **20**

2. FORMATION DESCRIPTION	THICKNESS OF STRATUM	DEPTH TO BOTTOM OF STRATUM
med. brown sand	2'	2'
reddish brown sand	2'	4'
fine-med. tan sand	11'	15'
med tan water sand	7'	22'
reddish brown clay	11'	33'
Med. tan sand	49'	82'
med. tan water sand		112'+
RECEIVED Mich. Dept. of Public Health AUG 18 1996 BL ENVIRONMENTAL AND OCCUPATIONAL HEALTH DIVISION		

15. ABANDONED WELL PLUGGED?  Yes  No

Casing Diameter \_\_\_\_\_ in. Depth \_\_\_\_\_ ft.

PLUGGING MATERIAL:  Neat Cement  Bentonite Slurry  
 Cement/Bentonite Slurry  Concrete Grout  Bentonite Chips  
 No. of Bags \_\_\_\_\_ Casing Removed?  Yes  No

16. REMARKS: (Elevation, Source of Data, etc.)

17. DRILLING MACHINE OPERATOR:  
 Employee  Subcontractor  
 Name **Eric Shepler**

15. WATER WELL CONTRACTOR'S CERTIFICATION:  
 This well was drilled under my jurisdiction and this report is true to the best of my knowledge and belief.

**Shepler Well Drilling** **0115**  
 REGISTERED BUSINESS NAME REGISTRATION NO.

Address **9238 E 14th Rd. Marquette MI 49863**

Signed **[Signature]** Date **9/22/96**  
 AUTHORIZED REPRESENTATIVE

<b>1 LOCATION OF WELL</b>		
County <b>WEXFORD</b>	Township Name <b>BOON</b>	Fraction $\frac{1}{4}$ $\frac{1}{4}$ $\frac{1}{4}$ Section Number <b>24</b> Town Number <b>220</b> Range Number <b>11 E/W</b>
Distance And Direction From Road Intersection <b>742 WEST 34 ROAD</b>		<b>3 OWNER OF WELL:</b> FELIX ZOSSO Address <b>742 WEST 34 ROAD BOON, MI</b> Address Same As Well Location? <input checked="" type="checkbox"/> Yes <input type="checkbox"/> No
Street Address & City of Well Location		<b>4 WELL DEPTH:</b> <b>93</b> FT. Date Completed <b>3-28-94</b> <input checked="" type="checkbox"/> New Well <input type="checkbox"/> Replacement Well
Locate with "X" in Section Below		<input type="checkbox"/> Cable tool <input checked="" type="checkbox"/> Rotary <input type="checkbox"/> Driven <input type="checkbox"/> Dug <input type="checkbox"/> Hollow rod <input type="checkbox"/> Auger <input type="checkbox"/> Jotted <input type="checkbox"/>
Sketch Map: 		<b>6 USE:</b> <input checked="" type="checkbox"/> Domestic <input checked="" type="checkbox"/> Type I Public <input type="checkbox"/> Type III Public <input type="checkbox"/> Irrigation <input type="checkbox"/> Type IIa Public <input type="checkbox"/> Heat pump <input type="checkbox"/> Test Well <input type="checkbox"/> Type IIb Public <input type="checkbox"/>
<b>2 FORMATION DESCRIPTION</b>		<b>7 CASING:</b> Diameter <input type="checkbox"/> Steel <input checked="" type="checkbox"/> Plastic <input type="checkbox"/> Threaded <input type="checkbox"/> Welded <b>5</b> in. to <b>88</b> ft depth Grouted Drill Hole Diameter _____ in. to _____ ft depth _____ in. to _____ ft depth
		Height: Above/Below Surface <b>1</b> ft. Weight _____ lbs./ft. Drive Shoe <input type="checkbox"/> Yes <input checked="" type="checkbox"/> No
		<b>8 SCREEN:</b> <input type="checkbox"/> Not Installed Type <b>Johnson</b> Diameter _____ Slot/Gauze <b>40</b> Length <b>93</b> ft. Set between <b>88</b> ft. and <b>93</b> ft. FITTINGS: <input checked="" type="checkbox"/> K-Packer <input type="checkbox"/> Lead Packer <input type="checkbox"/> Bremer Check <input type="checkbox"/> Blank above screen _____ ft. Other _____
		<b>9 STATIC WATER LEVEL:</b> <b>67</b> ft. below land surface <input type="checkbox"/> Flow
		<b>10 PUMPING LEVEL:</b> below land surface <b>80</b> ft. after <b>1</b> hrs. pumping at <b>10</b> G.P.M. _____ ft. after _____ hrs. pumping at _____ G.P.M.
		<b>11 WELL HEAD COMPLETION:</b> <input checked="" type="checkbox"/> Fitness adapter <input type="checkbox"/> 12" above grade <input type="checkbox"/> Basement offset <input type="checkbox"/> Approved pit
		<b>12 WELL GROUTED?</b> <input type="checkbox"/> No <input checked="" type="checkbox"/> Yes From <b>0</b> to <b>25</b> ft. <input type="checkbox"/> Neat cement <input checked="" type="checkbox"/> Bentonite <input type="checkbox"/> Other _____ No. of bags of cement _____ Additives _____
		<b>13 Nearest source of possible contamination</b> Type <b>Septic</b> Distance <b>60</b> ft. Direction <b>W</b> Well disinfected upon completion? <input checked="" type="checkbox"/> Yes <input type="checkbox"/> No Was old well plugged? <input checked="" type="checkbox"/> Yes <input type="checkbox"/> No
USE A 2ND SHEET IF NEEDED		<b>14 PUMP:</b> <input type="checkbox"/> Not Installed <input type="checkbox"/> Pump Installation Only Manufacturer's name <b>GUANFOR</b> Model number _____ HP <b>10</b> Volts <b>220</b> Length of Drop Pipe <b>78</b> ft. capacity <b>10</b> G.P.M. TYPE: <input checked="" type="checkbox"/> Submersible <input type="checkbox"/> Jet PRESSURE TANK: Manufacturer's name <b>XTIOL</b> Model number <b>203</b> Capacity <b>60</b> Gallons
		<b>15. Remarks, elevation, source of data, etc.</b>
		<b>16. WATER WELL CONTRACTOR'S CERTIFICATION:</b> This well was drilled under my jurisdiction and this report is true to the best of my knowledge and belief. <b>REGISTERED BUSINESS NAME: Rogers Well Drilling 1567</b> Address <b>2031 E 34 RD CADILLAC</b> Signed <b>James Rogers</b> Date <b>3-28-94</b> AUTHORIZED REPRESENTATIVE
		<b>17. Rig Operator's Name:</b>

TAX NO:

2211 2d 3101

MICHIGAN DEPARTMENT OF ENVIRONMENTAL QUALITY

## WATER WELL AND PUMP RECORD

PERMIT NO:

25685

1. LOCATION OF WELL

County

Wexford

Township Name

Boon

Fraction

1/4 1/4 1/4

Section No.

24

Town No.

22

Range No.

11

Distance and Direction from Road Intersection

West 34 Rd., Boon

Street Address &amp; City of Well Location

Locate with 'x' in Section Below

Sketch Map

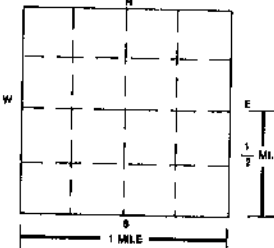

2. FORMATION DESCRIPTION

THICKNESS OF STRATUM

DEPTH TO BOTTOM OF STRATUM

FORMATION DESCRIPTION	THICKNESS OF STRATUM	DEPTH TO BOTTOM OF STRATUM
Top	1	1
Sand + Gravel	7	8
sand + Gravel + Clay Mix	22	30
sand + Clay + some Gravel some Clay stringer + stringer	45	75
Sand + Clay Mix	20	95
SAND	31	126

USE A 2ND SHEET IF NEEDED

15. ABANDONED WELL PLUGGED?  Yes  No

Casing Diameter \_\_\_\_\_ in. Depth \_\_\_\_\_ ft.

PLUGGING MATERIAL:

 Cement/Bentonite Slurry Neat Cement Bentonite Slurry Concrete Grout Bentonite Chips

No. of Bags \_\_\_\_\_

Casing Removed?  Yes  No

16. REMARKS: (Elevation, Source of Data, etc.)

17. DRILLING MACHINE OPERATOR:

 Employee  Subcontractor

Name

Rivard

3. OWNER OF WELL

Address Richard G. Porteous Jr.

West 32 Road

Cadillac, MI 49601

Address Same as Well Location  Yes  No

4. WELL DEPTH:

Date Completed

 New Well Replacement Well

126 ft.

5/14/97

5.  Cable Tool Rotary Driven Dug Hollow Rod Auger/Bored Jetted6. USE:  Household Type I Public Type III Public Irrigation Type IIa Public Heat Pump Test Well Type IIb Public7. CASING:  Steel Threaded

Height: Above/Below

 Plastic Welded

Surface: \_\_\_\_\_ ft.

 Other \_\_\_\_\_

Diameter: 5 in. to 11 1/2 ft. depth

Weight: SDR 21 lbs./ft.

\_\_\_\_\_ in. to \_\_\_\_\_ ft. depth

BORE HOLE:

Diameter: 8 1/8 in. to 126 ft. depth

 Drive Shoe

\_\_\_\_\_ in. to \_\_\_\_\_ ft. depth

 Shale Packer8. SCREEN:  Not Installed Gravel-Packed

Type Johnson 40p

Diameter 4 1/4"

Slot/Gauze 0.125

Length:

Set Between 119 ft. and 130 ft.

FITTINGS:  K-Packer Bremer Check Blank Above Screen \_\_\_\_\_ ft. Other \_\_\_\_\_

9. STATIC WATER LEVEL:

77 ft. Below Land Surface  Flowing

10. PUMPING LEVEL: Below Land Surface

105 ft. After \_\_\_\_\_ hrs. Pumping at \_\_\_\_\_ G.P.M.

 Plunger Bailer Air Test Pump

11. WELL HEAD COMPLETION:

 Pitless Adapter 12" Above Grade Basement Offset Well House12. WELL GROUTED?  No  Yes

From 0 to 111 ft.

 Neat Cement Bentonite Other \_\_\_\_\_

No. of Bags 10

Additives Aqua Grout

13. NEAREST SOURCE OF POSSIBLE CONTAMINATION:

Type Septic Distance 100 ft. Direction N

Type \_\_\_\_\_ Distance \_\_\_\_\_ ft. Direction \_\_\_\_\_

14. PUMP:  Not Installed Pump Installation Only

Manufacturer's Name Fiat + Walling

Model Number 106pm HP 3/4 Volts 230

Length of Drop Pipe 100 ft. Capacity 10 G.P.M.

TYPE:  Submersible  Jet  Other \_\_\_\_\_

PRESSURE TANK:

Manufacturer's Name Well Rite

Model Number WR 20 Capacity 26 Gallons

18. WATER WELL CONTRACTOR'S CERTIFICATION:

This well was drilled under my jurisdiction and this report is true to the best of my knowledge and belief.

Jim Jeffers Well Drilling 83-1981

REGISTERED BUSINESS NAME

REGISTRATION NO.

Address 11498 13 Road Mesick MI 49668

Signed

AUTHORIZED REPRESENTATIVE

Date 5-16-97

MAY 26 1981

**WATER WELL RECORD**  
ACT 284 PA 1965

MICHIGAN DEPARTMENT  
OF  
PUBLIC HEALTH

1 LOCATION OF WELL			3 OWNER OF WELL:		
County <b>WEXFORD</b>	Township Name <b>BOON</b>	Fraction <b>1/4 Sec 1/4</b>	Section Number <b>24</b>	Town Number <b>22 N.S.</b>	Range Number <b>11 E.W.</b>
Distance And Direction from Road Intersections			Address <b>Douglas Scott 402 HASKINS BOON, Mich. 49618</b>		
Street address & City of Well Location Locate with "X" in section below			4 WELL DEPTH: (completed) Date of Completion <b>112 ft. 5-13-80</b>		
Sketch Map: 			5 <input type="checkbox"/> Cable tool <input type="checkbox"/> Rotary <input type="checkbox"/> Driven <input type="checkbox"/> Dug <input checked="" type="checkbox"/> Hollow rod <input type="checkbox"/> Jotted <input type="checkbox"/> Bored <input type="checkbox"/>		
			6 USE: <input checked="" type="checkbox"/> Domestic <input type="checkbox"/> Public Supply <input type="checkbox"/> Industry <input type="checkbox"/> Irrigation <input type="checkbox"/> Air Conditioning <input type="checkbox"/> Commercial <input type="checkbox"/> Test Well <input type="checkbox"/>		
2 FORMATION			7 CASING: Threaded <input checked="" type="checkbox"/> Welded <input type="checkbox"/> Height: Above/Below Diam. Surface <b>1</b> ft.		
			2 in. to <b>108</b> ft. Depth Weight <b>3.25</b> lbs./ft. in. to _____ ft. Depth Drive Shoe? Yes <input checked="" type="checkbox"/> No <input type="checkbox"/>		
SAND			8 SCREEN:		
CHAY AND STONE			Type <b>Johnson S/S</b> Dia.: <b>1 1/2</b>		
SAND AND STONE			Slot/Gauge <b>60</b> Length <b>48</b>		
SAND AND WATER			Set between <b>108</b> ft. and <b>112</b> ft.		
			Fittings: <b>K-PACKER, BREMER CHECK</b>		
			9 STATIC WATER LEVEL <b>90</b> ft. below land surface		
			10 PUMPING LEVEL below land surface <b>98</b> ft. after <b>1</b> hrs. pumping <b>10</b> g.p.m.		
			_____ ft. after _____ hrs. pumping _____ g.p.m.		
			11 WATER QUALITY in Parts Per Million: Iron (Fe) _____ Chlorides (Cl) _____ Hardness _____ Other _____		
			12 WELL HEAD COMPLETION: <input checked="" type="checkbox"/> In Approved Pit <input type="checkbox"/> Pitless Adapter <input type="checkbox"/> 12" Above Grade		
			13 Well Grouted? <input type="checkbox"/> Yes <input type="checkbox"/> No <input type="checkbox"/> Neat Cement <input type="checkbox"/> Bentonite <input type="checkbox"/> Depth: From _____ ft. to _____ ft.		
			14 Nearest Source of possible contamination <b>50</b> foot <b>S-W</b> Direction <b>SEPTIC</b> Type Well disinfected upon completion <input checked="" type="checkbox"/> Yes <input type="checkbox"/> No		
			15 PUMP: <input type="checkbox"/> Not installed Manufacturer's Name <b>Goulds</b> Model Number <b>VS15</b> H.P. <b>220</b> Volts <b>220</b> Length of Drop Pipe <b>96</b> ft. capacity <b>8</b> G.P.M. Type: <input type="checkbox"/> Submersible <input checked="" type="checkbox"/> Jet <input type="checkbox"/> Reciprocating		
16 Remarks, elevation, source of data, etc.  ADDED INFO BY DRILLER, ITEM NO. *CORRECTED BY **ADDITION BY ELEVATION DEPTH TO ROCK			17 WATER WELL CONTRACTOR'S CERTIFICATION: This well was drilled under my jurisdiction and this report is true to the best of my knowledge and belief. <b>ROGERS WELL DRILLING</b> <b>1562</b> REGISTERED BUSINESS NAME REGISTRATION NO. Address <b>2031 E 34 RD</b> Signed <b>George Rogers</b> Date <b>5-13-80</b> AUTHORIZED REPRESENTATIVE		

DEC 03 1979

**WATER WELL RECORD**  
ACT 294 PA 1985

MICHIGAN DEPARTMENT  
OF  
PUBLIC HEALTH

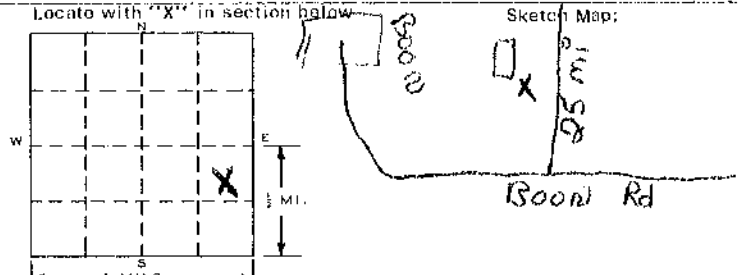
1 LOCATION OF WELL			3 OWNER OF WELL:		
County <b>WEXFORD</b>	Township Name <b>BOON</b>	Fraction 1/4 1/4 1/4	Section Number <b>24</b>	Town Number <b>22 N.</b>	Range Number <b>11 W.</b>
Distance And Direction from Road Intersections <b>Boon Rd West To 25 mi Rd. Turn North, go 1/8 mile left hand side</b>			Address <b>6522 WOODHAVEN UNION LAKE</b>		
Street address & City of Well Location			4 WELL DEPTH: (completed) Date of Completion <b>40 ft. 8-2-79</b>		
Locate with "X" in section below			5 <input type="checkbox"/> Cable tool <input type="checkbox"/> Rotary <input type="checkbox"/> Driven <input type="checkbox"/> Dug <input checked="" type="checkbox"/> Hollow rod <input type="checkbox"/> Jotted <input type="checkbox"/> Bored <input type="checkbox"/>		
Sketch Map: 			6 USE: <input checked="" type="checkbox"/> Domestic <input type="checkbox"/> Public Supply <input type="checkbox"/> Industry <input type="checkbox"/> Irrigation <input type="checkbox"/> Air Conditioning <input type="checkbox"/> Commercial <input type="checkbox"/> Test Well <input type="checkbox"/>		
2 FORMATION			7 CASING: Threaded <input checked="" type="checkbox"/> Welded <input type="checkbox"/>		Height: Above/Below Surface <b>1</b> ft.
			2 in. to <b>36</b> ft. Depth		Weight <b>3.25</b> lbs./ft.
SAND			23		23
CHAU			11		32
SAND AND WATER			8		40
			8 SCREEN: Type: _____ Dia.: <b>1 1/4</b> Slot/Gauze <b>80</b> Length <b>48</b> Set between <b>36</b> ft. and <b>40</b> ft. Fittings: <b>K PACKER - BREMER check</b>		
			9 STATIC WATER LEVEL <b>23</b> ft. below land surface		
			10 PUMPING LEVEL below land surface <b>32</b> ft. after <b>1</b> hrs. pumping <b>5</b> g.p.m.		
			11 WATER QUALITY in Parts Per Million: Iron (Fe) _____ Chlorides (Cl) _____ Hardness _____ Other _____		
			12 WELL HEAD COMPLETION: <input checked="" type="checkbox"/> In Approved Pit <input type="checkbox"/> Pitless Adaptor <input type="checkbox"/> 12" Above Grade		
			13 Well Grouted? <input type="checkbox"/> Yes <input type="checkbox"/> No <input type="checkbox"/> Neat Cement <input type="checkbox"/> Bentonite <input type="checkbox"/> _____ Depth: From _____ ft. to _____ ft.		
			14 Nearest Source of possible contamination <b>70</b> feet <b>N-W</b> Direction <b>SEPTIC</b> Type Well disinfected upon completion <input checked="" type="checkbox"/> Yes <input type="checkbox"/> No		
			15 PUMP: <input type="checkbox"/> Not installed Manufacturer's Name <b>GOULD'S</b> Model Number <b>Y05N</b> HP <b>1/2</b> Volts <b>110</b> Length of Drop Pipe <b>30</b> ft. capacity _____ G.P.M. Type: <input type="checkbox"/> Submersible <input checked="" type="checkbox"/> Jet <input type="checkbox"/> Reciprocating		
16 Remarks, elevation, source of data, etc. ADDED INFO BY DRILLER, ITEM NO. *CORRECTED BY <b>SY</b> **ADDITION BY ELEVATION DEPTH TO ROCK			17 WATER WELL CONTRACTOR'S CERTIFICATION: This well was drilled under my jurisdiction and this report is true to the best of my knowledge and belief. <b>Rogers &amp; Son</b> <b>1567</b> REGISTERED BUSINESS NAME REGISTRATION NO. Address <b>2031 E 34 Rd. Cadillac</b> Signed <b>George Rogers</b> Date <b>8-2-79</b> AUTHORIZED REPRESENTATIVE		



4905

MAY 26 1981

**WATER WELL RECORD**  
ACT 294 PA 1965

MICHIGAN DEPARTMENT  
OF  
PUBLIC HEALTH

**1 LOCATION OF WELL**

County <i>Wayne</i>	Township Name <i>BOON</i>	Fraction <i>SF 55 1/2</i>	Section Number <i>24</i>	Town Number <i>22 N.P.</i>	Range Number <i>11 N.W.</i>
------------------------	------------------------------	------------------------------	-----------------------------	-------------------------------	--------------------------------

Distance And Direction from Road Intersections



Street address & City of Well Location

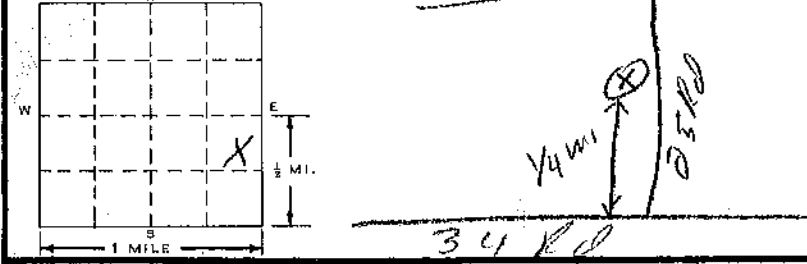

**3 OWNER OF WELL:**

*Carl Wright*  
Address *6520 Wood Haven Apt 2 Union Lake, 48085*

**4 WELL DEPTH: (completed) Date of Completion**

*107* ft. *June 14, 1980*

<input type="checkbox"/> Cable tool	<input type="checkbox"/> Rotary	<input type="checkbox"/> Driven	<input type="checkbox"/> Dug
<input checked="" type="checkbox"/> Hollow rod	<input type="checkbox"/> Jotted	<input type="checkbox"/> Bored	<input type="checkbox"/>

**6 USE:**

<input checked="" type="checkbox"/> Domestic	<input type="checkbox"/> Public Supply	<input type="checkbox"/> Industry
<input type="checkbox"/> Irrigation	<input type="checkbox"/> Air Conditioning	<input type="checkbox"/> Commercial
<input type="checkbox"/> Test Well	<input type="checkbox"/>	<input type="checkbox"/>

**7 CASING: Threaded  Welded  Diam.**

*I* in. to *103* ft. Depth  
Height: Above/Below Surface *1* ft.  
Weight *3.75* lbs./ft.  
Drive Shoe? Yes  No

**2 FORMATION**

FORMATION	THICKNESS OF STRATUM	DEPTH TO BOTTOM OF STRATUM
<i>Sand</i>	<i>33</i>	<i>3.3</i>
<i>fine sand Clay water</i>	<i>8</i>	<i>41</i>
<i>Clay</i>	<i>11</i>	<i>52</i>
<i>Sand</i>	<i>40</i>	<i>92</i>
<i>Clay</i>	<i>5</i>	<i>97</i>
<i>Sand and fine gravel</i>	<i>10</i>	<i>107</i>

**8 SCREEN:**

Type: *Clayton Mark's S.S.* Dia.: *1 1/4*  
Slot/Gauze *80* Length *4 48*  
Set between *103* ft. and *107* ft.  
Fittings: *K-packer and Bremer*

**9 STATIC WATER LEVEL**

*83* ft. below land surface

**10 PUMPING LEVEL below land surface**

*97* ft. after *7* hrs. pumping *7* g.p.m.  
\_\_\_\_ ft. after \_\_\_\_ hrs. pumping \_\_\_\_ g.p.m.

**11 WATER QUALITY in Parts Per Million:**

Iron (Fe) \_\_\_\_\_ Chlorides (Cl) \_\_\_\_\_  
Hardness \_\_\_\_\_ Other \_\_\_\_\_

**12 WELL HEAD COMPLETION:**

In Approved Pit  
 Pitless Adapter  12" Above Grade

**13 Well Grouted?  Yes  No**

Neat Cement  Bentonite  \_\_\_\_\_  
Depth: From \_\_\_\_\_ ft. to \_\_\_\_\_ ft.

**14 Nearest Source of possible contamination**

*70* feet *N-W* Direction *Septic* Type  
Well disinfected upon completion  Yes  No

**15 PUMP:**

Not installed  
Manufacturer's Name *Goulds*  
Model Number *VSS15* H.P. *1/2* Volts *220*  
Length of Drop Pipe *97* ft. capacity *7* G.P.M.  
Type:  Submersible  Jet  Reciprocating

**16 Remarks, elevation, source of data, etc.**

ADDED INFO BY DRILLER, ITEM NO.  
CORRECTED BY *[Signature]*  
ADDITION BY *[Signature]*  
ELEVATION  
DEPTH TO ROCK

**17 WATER WELL CONTRACTOR'S CERTIFICATION:**

This well was drilled under my jurisdiction and this report is true to the best of my knowledge and belief.  
*Rogers and Sone* *1567*  
REGISTERED BUSINESS NAME REGISTRATION NO.  
Address *2031 E 34 Rd. Cadillac*  
Signed *George Rogers* Date *6/14/80*  
AUTHORIZED REPRESENTATIVE



**FEB 06 1980**

**WATER WELL RECORD**  
ACT 294 PA 1985

MICHIGAN DEPARTMENT  
OF  
PUBLIC HEALTH

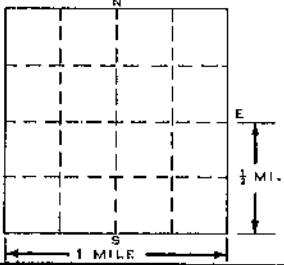
<b>1 LOCATION OF WELL</b>											
County <b>WEXFORD</b>		Township Name <b>Boon</b>		Fraction 1/4 1/4 1/4		Section Number <b>24</b>		Town Number <b>22</b> N/S.		Range Number <b>1B</b> E/W.	
Distance And Direction from Road Intersections <b>710 S 35 rd</b>				3 OWNER OF WELL: <b>ROY ZIETZ</b> Address <b>710 S 35 rd</b>							
Street address & City of Well Location <b>Boon</b>				4 WELL DEPTH: (completed) Date of Completion <b>443</b> ft. <b>1979</b>				5 <input type="checkbox"/> Cable tool <input checked="" type="checkbox"/> Rotary <input type="checkbox"/> Driven <input type="checkbox"/> Dug <input type="checkbox"/> Hollow rod <input type="checkbox"/> Jetted <input type="checkbox"/> Bored <input type="checkbox"/>			
Sketch Map: 				6 USE: <input checked="" type="checkbox"/> Domestic <input type="checkbox"/> Public Supply <input type="checkbox"/> Industry <input type="checkbox"/> Irrigation <input type="checkbox"/> Air Conditioning <input type="checkbox"/> Commercial <input type="checkbox"/> Test Well <input type="checkbox"/>				7 CASING: Threaded <input type="checkbox"/> Welded <input checked="" type="checkbox"/> Height: Above/Below Surface _____ ft. <b>4</b> in. to _____ ft. Depth Weight <b>11</b> lbs./ft. _____ in. to _____ ft. Depth Drive Shoe? Yes <input checked="" type="checkbox"/> No <input type="checkbox"/>			
<b>2 FORMATION</b>		THICKNESS OF STRATUM		DEPTH TO BOTTOM OF STRATUM		8 SCREEN: Type: <b>S.S</b> Dia.: <b>3 3/4</b> Slot/Gauze <b>10</b> Length <b>8</b> Set between _____ ft. and _____ ft. Fittings: <b>HPACKER</b>					
<b>CLAY &amp; GRAVEL</b>		<b>40</b>		<b>40</b>		9 STATIC WATER LEVEL <b>300</b> ft. below land surface					
<b>GRAVEL</b>		<b>20</b>		<b>60</b>		10 PUMPING LEVEL below land surface _____ ft. after _____ hrs. pumping _____ g.p.m. _____ ft. after _____ hrs. pumping _____ g.p.m.					
<b>SAND</b>		<b>230</b>		<b>290</b>		11 WATER QUALITY in Parts Per Million: Iron (Fe) _____ Chlorides (Cl) _____ Hardness _____ Other _____					
<b>CLAY GRAVEL</b>		<b>130</b>		<b>400</b>		12 WELL HEAD COMPLETION: <input type="checkbox"/> In Approved Pit <input checked="" type="checkbox"/> Pitless Adapter <input type="checkbox"/> 12" Above Grade					
<b>GRAVEL</b>		<b>23</b>		<b>413</b>		13 Well Grouted? <input type="checkbox"/> Yes <input type="checkbox"/> No <input type="checkbox"/> Neat Cement <input type="checkbox"/> Bentonite <input type="checkbox"/> Depth: From _____ ft. to _____ ft.					
						14 Nearest Source of possible contamination <b>100</b> foot <b>NE</b> Direction <b>SEPTIC</b> Type Well disinfected upon completion <input checked="" type="checkbox"/> Yes <input type="checkbox"/> No					
						15 PUMP: <input type="checkbox"/> Not installed Manufacturer's Name <b>F &amp; W</b> Model Number _____ HP <b>2</b> Volts <b>240</b> Length of Drop Pipe _____ ft. capacity <b>20</b> G.P.M. Type: <input checked="" type="checkbox"/> Submersible <input type="checkbox"/> Jet <input type="checkbox"/> Reciprocating					
USE A 2ND SHEET IF NEEDED											
16 Remarks, elevation, source of data, etc. ADDED INFO BY DRILLER, ITEM NO. *CORRECTED BY **ADDITION BY ELEVATION DEPTH TO ROCK				17 WATER WELL CONTRACTOR'S CERTIFICATION: This well was drilled under my jurisdiction and this report is true to the best of my knowledge and belief. <b>THOS FRINT &amp; SON INC 0519</b> REGISTERED BUSINESS NAME REGISTRATION NO. Address <b>Cadillac</b> Signed <b>Mike Flint</b> Date <b>1979</b> AUTHORIZED REPRESENTATIVE							



