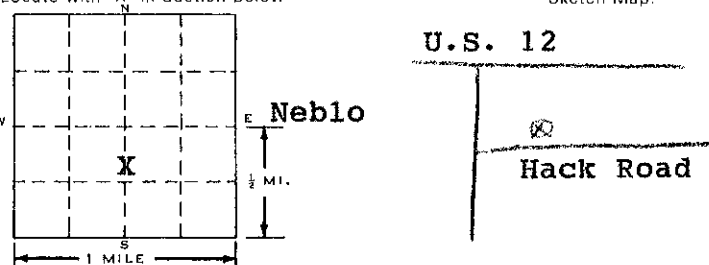

**WATER WELL AND PUMP RECORD**

B	W	1	7	9	1	R
---	---	---	---	---	---	---

PERMIT NUMBER

<b>1 LOCATION OF WELL</b>		<b>3 OWNER OF WELL:</b>	
County <b>Washtenaw</b>	Township Name <b>Bridgewater</b>	Fraction <b>SE 1/4 1/4 1/4</b>	Section Number <b>36</b>
Distance And Direction From Road Intersection <b>N. Side of Hack road between Neblo and Able roads.</b>		Town Number <b>4 N/SO</b>	
Street Address & City of Well Location <b>9000 Hack Road Clinton, MI</b>		Range Number <b>4 @/W</b>	
Locate with "X" in Section Below 		Date Completed <b>8 15 91</b>	
2 FORMATION DESCRIPTION		4 WELL DEPTH: <b>98</b> FT.	
		Date Completed MO. DAY YEAR <b>8 15 91</b>	
THICKNESS OF STRATUM		5 <input type="checkbox"/> Cable tool <input checked="" type="checkbox"/> Rotary <input type="checkbox"/> Driven <input type="checkbox"/> Dug	
		6 USE: <input type="checkbox"/> Domestic <input type="checkbox"/> Type I Public <input type="checkbox"/> Type III Public	
DEPTH TO BOTTOM OF STRATUM		7 CASING: Diameter <input type="checkbox"/> Steel <input type="checkbox"/> Threaded <input checked="" type="checkbox"/> Plastic <input type="checkbox"/> Welded	
		8 SCREEN: <input type="checkbox"/> Not Installed	
YELLOW CLAY & GRAVEL		Type <b>Stainless</b> Diameter <b>3"</b>	
YELLOW SAND & GRAVEL (H <sub>2</sub> O)		Slot/Gauze <b>15</b> Length <b>4'</b>	
YELLOW CLAY & GRAVEL (SAND)		Set between <b>98</b> ft. and <b>94</b> ft.	
GRAY CLAY		FITTINGS: <input checked="" type="checkbox"/> K-Packer <input type="checkbox"/> Lead Packer <input type="checkbox"/> Bremer Check	
GRAY SAND & GRAVEL, H <sub>2</sub> O		<input checked="" type="checkbox"/> Blank above screen <b>1.5</b> ft. Other _____	
		9 STATIC WATER LEVEL: <b>65</b> ft. below land surface <input type="checkbox"/> Flow	
		10 PUMPING LEVEL: below land surface	
		<b>70</b> ft. after <b>2</b> hrs. pumping at <b>35</b> G.P.M.	
		_____ ft. after _____ hrs. pumping at _____ G.P.M.	
		11 WELL HEAD COMPLETION: <input checked="" type="checkbox"/> Pitless adapter <input type="checkbox"/> 2" above grade	
		<input type="checkbox"/> Basement offset <input type="checkbox"/> Approved pit	
		12 WELL GROUTED? <input type="checkbox"/> No <input checked="" type="checkbox"/> Yes From <b>0</b> to <b>73</b> ft.	
		<input checked="" type="checkbox"/> Neat cement <input type="checkbox"/> Bentonite <input type="checkbox"/> Other _____	
		<b>Grout pump &amp; pipe were used</b>	
		No. of bags of cement <b>20</b> Additives _____	
		13 Nearest source of possible contamination	
		Type <b>Septic</b> Distance <b>50'</b> Direction <b>sw</b>	
		Well disinfected upon completion? <input checked="" type="checkbox"/> Yes <input type="checkbox"/> No	
		Was old well plugged? <input checked="" type="checkbox"/> Yes <input type="checkbox"/> No	
		PUMP: <input type="checkbox"/> Not installed <input type="checkbox"/> Pump Installation Only	
		Manufacturer's name <b>Red Jacket</b>	
		Model number <b>50UW19BC</b> HP <b>1/2</b> Volts <b>115</b>	
		Length of Drop Pipe <b>80</b> ft. capacity <b>15</b> G.P.M.	
		PUMP TYPE: <input checked="" type="checkbox"/> Submersible <input type="checkbox"/> Jet	
		PRESSURE TANK:	
		Manufacturer's name <b>Well Rite</b>	
		Model number <b>WR202</b> Capacity <b>40</b> Gallons	
15. Remarks, elevation, source of data, etc.		16. WATER WELL CONTRACTOR'S CERTIFICATION:	
		This well was drilled under my jurisdiction and this report is true to the best of my knowledge and belief.	
		# 1940	
		<b>CLYMER &amp; SONS WATER SPECIALTIES, INC.</b>	
		REGISTERED BUSINESS NAME REGISTRATION NO.	
17. Rig Operator's Name: <b>Terry L. Clymer</b>		Address <b>1204 W. Chicago Blvd. Tecumseh</b>	
		Signed <i>Terry L. Clymer</i> Date <b>8-15-91</b>	
		AUTHORIZED REPRESENTATIVE	

Authority: Act 368 PA 1978  
 Completion: Required  
 Penalty: Conviction of a violation of any provision is a misdemeanor.

<b>1 LOCATION OF WELL</b>			<b>3 OWNER OF WELL:</b>																							
County <i>Washtenaw</i>	Township Name <i>Bridgewater</i>	Fraction <i>SW 1/4 SE 1/4 SE 1/4</i>	Section Number <i>36</i>	Town Number <i>4 N/S</i>	Range Number <i>4 E/W</i>																					
Distance And Direction From Road Intersection <i>1/2 mi. East of Neble, 75 S. of HACK</i>			Address <i>HARRY MILLER 9008 HACK Rd. CLINTON, MI.</i>																							
Street Address & City of Well Location <i>9008 HACK RD, CLINTON</i>			Address Same As Well Location? <input type="checkbox"/> Yes <input type="checkbox"/> No																							
Locate with "X" in Section Below			4 WELL DEPTH: <i>108</i> FT. Date Completed <i>4/14/88</i>																							
			<input checked="" type="checkbox"/> New Well <input type="checkbox"/> Replacement Well																							
			5 <input checked="" type="checkbox"/> Cable tool <input type="checkbox"/> Rotary <input type="checkbox"/> Driven <input type="checkbox"/> Dug <input type="checkbox"/> Hollow rod <input type="checkbox"/> Auger <input type="checkbox"/> Jetted <input type="checkbox"/>																							
<table border="1" style="width: 100%; border-collapse: collapse;"> <tr> <th style="width: 30%;">2 FORMATION DESCRIPTION</th> <th style="width: 10%;">THICKNESS OF STRATUM</th> <th style="width: 10%;">DEPTH TO BOTTOM OF STRATUM</th> </tr> <tr> <td><i>CLAY</i></td> <td><i>28</i></td> <td><i>28</i></td> </tr> <tr> <td><i>GRAY SAND</i></td> <td><i>2</i></td> <td><i>30</i></td> </tr> <tr> <td><i>CLAY &amp; SAND</i></td> <td><i>52</i></td> <td><i>82</i></td> </tr> <tr> <td><i>GRAY SAND</i></td> <td><i>26</i></td> <td><i>108</i></td> </tr> <tr> <td><i>Below</i></td> <td></td> <td></td> </tr> <tr> <td><i>GRAY SAND</i></td> <td></td> <td></td> </tr> </table>			2 FORMATION DESCRIPTION	THICKNESS OF STRATUM	DEPTH TO BOTTOM OF STRATUM	<i>CLAY</i>	<i>28</i>	<i>28</i>	<i>GRAY SAND</i>	<i>2</i>	<i>30</i>	<i>CLAY &amp; SAND</i>	<i>52</i>	<i>82</i>	<i>GRAY SAND</i>	<i>26</i>	<i>108</i>	<i>Below</i>			<i>GRAY SAND</i>			6 USE: <input checked="" type="checkbox"/> Domestic <input type="checkbox"/> Type I Public <input type="checkbox"/> Type III Public <input type="checkbox"/> Irrigation <input type="checkbox"/> Type IIa Public <input type="checkbox"/> Heat pump <input type="checkbox"/> Test Well <input type="checkbox"/> Type IIb Public <input type="checkbox"/>		
			2 FORMATION DESCRIPTION	THICKNESS OF STRATUM	DEPTH TO BOTTOM OF STRATUM																					
<i>CLAY</i>	<i>28</i>	<i>28</i>																								
<i>GRAY SAND</i>	<i>2</i>	<i>30</i>																								
<i>CLAY &amp; SAND</i>	<i>52</i>	<i>82</i>																								
<i>GRAY SAND</i>	<i>26</i>	<i>108</i>																								
<i>Below</i>																										
<i>GRAY SAND</i>																										
			7 CASING: Diameter <input checked="" type="checkbox"/> Steel <input checked="" type="checkbox"/> Threaded <input type="checkbox"/> Plastic <input type="checkbox"/> Welded																							
			Height: Above/Below Surface <i>1</i> ft. Weight <i>11</i> lbs./ft. Drive Shoe <input checked="" type="checkbox"/> Yes <input type="checkbox"/> No																							
			8 SCREEN: <input type="checkbox"/> Not Installed																							
			Type <i>STAINLESS STEEL</i> Diameter <i>4"</i>																							
			Slot/Gauze <i>#10</i> Length <i>4'</i>																							
			Set between _____ ft. and _____ ft.																							
			FITTINGS: <input checked="" type="checkbox"/> K-Packer <input type="checkbox"/> Lead Packer <input type="checkbox"/> Bremer Check <input type="checkbox"/> Blank above screen _____ ft. Other _____																							
			9 STATIC WATER LEVEL: <i>71</i> ft. below land surface <input type="checkbox"/> Flow																							
			10 PUMPING LEVEL: below land surface <i>100</i> ft. after <i>1</i> hrs. pumping at <i>30</i> G.P.M.																							
			_____ ft. after _____ hrs. pumping at _____ G.P.M.																							
			11 WELL HEAD COMPLETION: <input checked="" type="checkbox"/> Pitless adapter <input type="checkbox"/> 12" above grade <input type="checkbox"/> Basement offset <input type="checkbox"/> Approved pit																							
			12 WELL GROUTED? <input checked="" type="checkbox"/> No <input type="checkbox"/> Yes From _____ to _____ ft. <input type="checkbox"/> Neat cement <input type="checkbox"/> Bentonite <input type="checkbox"/> Other _____																							
			No. of bags of cement _____ Additives _____																							
			13 Nearest source of possible contamination																							
			Type <i>SEPTIC</i> Distance <i>75</i> ft. Direction <i>EAST</i>																							
			Well disinfected upon completion? <input checked="" type="checkbox"/> Yes <input type="checkbox"/> No																							
			Was old well plugged? <input type="checkbox"/> Yes <input type="checkbox"/> No																							
			14 PUMP: <input type="checkbox"/> Not Installed <input type="checkbox"/> Pump Installation Only																							
			Manufacturer's name <i>GRINFOS</i>																							
			Model number <i>SP210</i> HP <i>1/2</i> Volts <i>230</i>																							
			Length of Drop Pipe <i>89</i> ft. capacity <i>12</i> G.P.M.																							
			TYPE: <input checked="" type="checkbox"/> Submersible <input type="checkbox"/> Jet																							
			PRESSURE TANK: Manufacturer's name <i>CONAIR</i> <i>42</i>																							
			Model number _____ Capacity _____ Gallons																							
15. Remarks, elevation, source of data, etc. <i>Unconventional</i>			16 WATER WELL CONTRACTOR'S CERTIFICATION:																							
			This well was drilled under my jurisdiction and this report is true to the best of my knowledge and belief. <i>Tom's Well Pump Service Inc. 0021</i> REGISTERED BUSINESS NAME REGISTRATION NO. Address <i>13626 Rexford Rd. Manitou Beach</i> Signed <i>Thomas D. Mayo</i> Date <i>5-17-88</i> AUTHORIZED REPRESENTATIVE																							
17. Rig Operator's Name: <i>Richard Mayo</i>																										



MICHIGAN DEPARTMENT OF PUBLIC HEALTH  
WATER WELL AND PUMP RECORD

1 LOCATION OF WELL					
County	Township Name	Fraction	Section Number	Town Number	Range Number
WASHTENAW	BRIDGEWATER	SW ¼ NE ¼ SW ¼	36	4 S	4 E

Distance And Direction From Road Intersection

13885 NEBLO  
CLINTON 49236

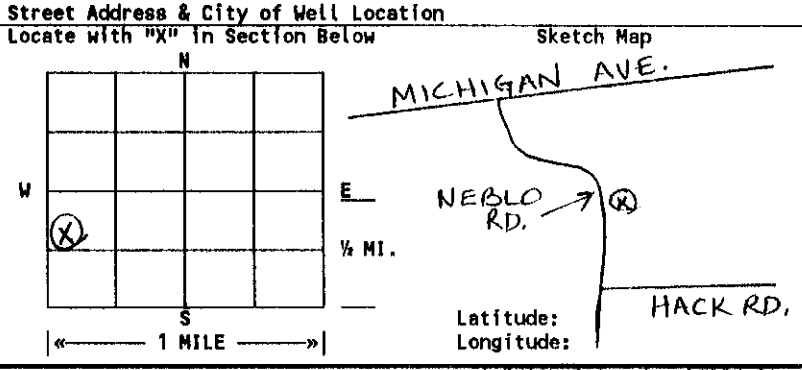

3 OWNER OF WELL

DAVID R. SCHRYER  
Address 5530 BARR  
CANTON, MI 48188

Address Same As Well Location? NO

4 WELL DEPTH: 120 FT. Date Completed 09/01/95 NEW WELL

5 DRILLING METHOD: ROTARY

6 USE: DOMESTIC

7 CASING: PLASTIC

Diameter 5" to 110 ft. depth  
Diameter " to " ft. depth

Grouted Drill Hole Diameter  
9" to 110 ft. depth  
" to " ft. depth

Height: ABOVE  
Surface 1'  
Weight SDR 21  
Drive Shoe: NO

2 FORMATION DESCRIPTION	THICKNESS OF STRATUM	DEPTH TO BOTTOM OF STRATUM
YELLOW CLAY	14	14
GRAY CLAY	56	70
SAND	25	95
GRAY CLAY	11	106
SAND	14	120

8 SCREEN: Type PVC Diameter 5" Nominal  
SLOT 12 Length 10 ft.  
Set Between 110 ft. and 120 ft.

FITTINGS: BLANK Blank above screen 1 ft.

9 STATIC WATER LEVEL 68 ft. below land surface Flow: NO

10 PUMPING LEVEL: below land surface  
73 ft. after 2 hrs. pumping at 10 G.P.M.  
ft. after hrs. pumping at G.P.M.

11 WELL HEAD COMPLETION: 1' ABOVE GRADE

12 WELL GROUDED? YES  
BEN-SEAL From 0 to 110 ft.  
5 bags of cement. Additives

13 Nearest source of contamination  
Type NONE YET Distance ft Direction  
Well disinfected upon completion? YES  
Was old well plugged?

14 PUMP: NOT INSTALLED

Manufacturers name  
Model number HP VOLTS  
Length of Drop Pipe ft. capacity G.P.M.  
Type  
PRESSURE TANK:  
Manufacturers Name Capacity Gallons

RECEIVED  
Mich. Dept. of Public Health  
OCT 04 1995  
BUREAU OF ENVIRONMENTAL AND  
OCCUPATIONAL HEALTH-GWOS

15. Remarks, elevation, source of data, etc.  
1000 #SAND PACK WELL FIRST

17. Rig Operator's Name:  
KEN PEARCE

16. WATER WELL CONTRACTOR'S CERTIFICATION:  
This well was drilled under my jurisdiction and this report is true to the best of my knowledge and belief.

Cribley Drilling Co., Inc. 81-0524  
REGISTERED BUSINESS NAME REGISTRATION NO.  
Address 8300 Dexter Chelsea Rd Dexter MI 48130  
Signed Jack A. Clark Date 9/6/95  
AUTHORIZED REPRESENTATIVE

D67d 2/89 CDCW11959P

IMPORTANT: File with deed.

ENV. HEALTH  
GEOLOGICAL SURVEY COPY

Authority: Act 368 PA 1978  
Completion: Required  
Penalty: Conviction of a violation of an Ordinance is a misdemeanor.