

AUG 20 1976

**WATER WELL RECORD**

ACT 294 PA 1965

MICHIGAN DEPARTMENT OF PUBLIC HEALTH

<b>1 LOCATION OF WELL</b>										
County <b>St. Joseph</b>	Township Name <b>Burr Oak</b>	Fraction <b>nw ¼ ne ¼ ne ¼</b>								
		Section Number <b>32</b>								
		Town Number <b>7</b> W.S.								
		Range Number <b>9</b> E.W.								
Distance And Direction from Road Intersections <b>½ mi. East of Bigg Hill Rd. on the S. side of Witt Lake Rd.</b>										
Street address & City of Well Location Locate with "X" in section below										
	Sketch Map: <i>Witt Lake Rd.</i> <i>Big Hill Rd.</i>									
<b>2 FORMATION</b>										
	THICKNESS OF STRATUM	DEPTH TO BOTTOM OF STRATUM								
<b>Dry Gravel</b>	<b>57</b>	<b>57</b>								
<b>Sand, Gravel, Little Clay</b>	<b>21</b>	<b>78</b>								
<b>Little Sand &amp; Trace of Clay</b>	<b>4</b>	<b>82</b>								
<b>Sand, Gravel, Trace of Clay</b>	<b>27</b>	<b>109</b>								
<b>Sand, Trace of Clay</b>	<b>11</b>	<b>120</b>								
<b>Sand</b>	<b>5</b>	<b>125</b>								
<b>Vein</b>	<b>4</b>	<b>129</b>								
USE A 2ND SHEET IF NEEDED										
<b>3 OWNER OF WELL:</b> <b>Jerry Mounts</b> Address <b>Mrs. Louis Mounts, 842 Witt Lk. Rd. Sturgis</b>										
<b>4 WELL DEPTH: (completed) Date of Completion</b> <b>129 ft. 7/22/76</b>										
<table style="width: 100%; border: none;"> <tr> <td style="width: 33%;"><input type="checkbox"/> Cable tool</td> <td style="width: 33%;"><input type="checkbox"/> Rotary</td> <td style="width: 33%;"><input type="checkbox"/> Driven</td> <td><input type="checkbox"/> Dug</td> </tr> <tr> <td><input type="checkbox"/> Hollow rod</td> <td><input checked="" type="checkbox"/> Jetted</td> <td><input type="checkbox"/> Bored</td> <td><input type="checkbox"/></td> </tr> </table>			<input type="checkbox"/> Cable tool	<input type="checkbox"/> Rotary	<input type="checkbox"/> Driven	<input type="checkbox"/> Dug	<input type="checkbox"/> Hollow rod	<input checked="" type="checkbox"/> Jetted	<input type="checkbox"/> Bored	<input type="checkbox"/>
<input type="checkbox"/> Cable tool	<input type="checkbox"/> Rotary	<input type="checkbox"/> Driven	<input type="checkbox"/> Dug							
<input type="checkbox"/> Hollow rod	<input checked="" type="checkbox"/> Jetted	<input type="checkbox"/> Bored	<input type="checkbox"/>							
<b>6 USE:</b> <input checked="" type="checkbox"/> Domestic <input type="checkbox"/> Public Supply <input type="checkbox"/> Industry <input type="checkbox"/> Irrigation <input type="checkbox"/> Air Conditioning <input type="checkbox"/> Commercial <input type="checkbox"/> Test Well <input type="checkbox"/>										
<b>7 CASING:</b> Threaded <input checked="" type="checkbox"/> Welded <input type="checkbox"/> Diam. _____ Height: Above/Below Surface _____ ft. <b>2</b> in. to <b>126</b> ft. Depth Weight <b>3.75</b> lbs./ft. _____ in. to _____ ft. Depth Drive Shoe? Yes <input type="checkbox"/> No <input checked="" type="checkbox"/>										
<b>8 SCREEN:</b> Type: <b>Redhead</b> Dia.: <b>1 1/4"</b> Slot: <del>xxxx</del> <b>10</b> Length <b>36"</b> Set between <b>126</b> ft. and <b>129</b> ft. Fittings: <b>1 1/4" x 24" stem, Bremer chekk</b>										
<b>9 STATIC WATER LEVEL</b> <b>57</b> ft. below land surface										
<b>10 PUMPING LEVEL</b> below land surface _____ ft. after _____ hrs. pumping <b>NA</b> g.p.m. _____ ft. after _____ hrs. pumping _____ g.p.m.										
<b>11 WATER QUALITY</b> in Parts Per Million: Iron (Fe) _____ Chlorides (Cl) <b>NA</b> Hardness _____ Other _____										
<b>12 WELL HEAD COMPLETION:</b> <input type="checkbox"/> In Approved Pit <input type="checkbox"/> Pitless Adapter <input type="checkbox"/> 12" Above Grade										
<b>13 Well Grouted?</b> <input type="checkbox"/> Yes <input checked="" type="checkbox"/> No <input type="checkbox"/> Neat Cement <input type="checkbox"/> Bentonite <input type="checkbox"/> Depth: From _____ ft. to _____ ft.										
<b>14 Nearest Source of possible contamination</b> <b>50 feet from any</b> direction <b>septic</b> Type Well disinfected upon completion <input checked="" type="checkbox"/> Yes <input type="checkbox"/> No										
<b>15 PUMP:</b> <input type="checkbox"/> Not installed <i>(INST. their pump ON New Well)</i> Manufacturer's Name <b>L&amp;S</b> Model Number <b>IS-5</b> HP <b>1/2</b> Volts <b>110</b> Length of Drop Pipe <b>63</b> ft. capacity _____ G.P.M. Type: <input type="checkbox"/> Submersible <input checked="" type="checkbox"/> Jet <input type="checkbox"/> Reciprocating										
<b>16 Remarks, elevation, source of data, etc.</b> ADDED INFO BY DRILLER, ITEM NO. *CORRECTED BY **ADDITION BY <i>(initials)</i> ELEVATION DEPTH TO ROCK										
<b>17 WATER WELL CONTRACTOR'S CERTIFICATION:</b> This well was drilled under my jurisdiction and this report is true to the best of my knowledge and belief. <b>Geo. P. Reid &amp; Son</b> <b>0360</b> REGISTERED BUSINESS NAME REGISTRATION NO. Address <b>Box 5 Howe, IN 46746</b> Signed <i>(Signature)</i> Date <b>8/9/76</b> AUTHORIZED REPRESENTATIVE										



**FEB 24 1977**

**WATER WELL RECORD**  
ACT 294 PA 1965

MICHIGAN DEPARTMENT  
OF  
PUBLIC HEALTH

<b>1 LOCATION OF WELL</b>			<b>3 OWNER OF WELL:</b>														
County <b>ST. JOSEPH</b>	Township Name <b>BURR OAK</b>	Fraction <b>NW 1/4 NW 1/4</b>	Section Number <b>32</b>	Town Number <b>7 X.S.</b>	Range Number <b>9 X/W.</b>												
Distance And Direction from Road Intersections <b>CORNER OF WITT LAKE ROAD AND BIG HILL ROAD.</b>			Address <b>ROSS FRY 609 BIG HILL ROAD STURGIS, MI. 49091</b>														
Street address & City of Well Location Locate with "X" in section below			4 WELL DEPTH: (completed) Date of Completion <b>111</b> ft. <b>12/13/76</b>														
Sketch Map: 			5 <input type="checkbox"/> Cable tool <input type="checkbox"/> Rotary <input type="checkbox"/> Driven <input type="checkbox"/> Dug <input type="checkbox"/> Hollow rod <input checked="" type="checkbox"/> Jetted <input type="checkbox"/> Bored														
			6 USE: <input checked="" type="checkbox"/> Domestic <input type="checkbox"/> Public Supply <input type="checkbox"/> Industry <input type="checkbox"/> Irrigation <input type="checkbox"/> Air Conditioning <input type="checkbox"/> Commercial <input type="checkbox"/> Test Well														
<b>2 FORMATION</b> <table border="1" style="width: 100%; border-collapse: collapse;"> <thead> <tr> <th style="width: 60%;">FORMATION</th> <th style="width: 20%;">THICKNESS OF STRATUM</th> <th style="width: 20%;">DEPTH TO BOTTOM OF STRATUM</th> </tr> </thead> <tbody> <tr> <td><b>Sand &amp; Gravel</b></td> <td style="text-align: center;"><b>90</b></td> <td style="text-align: center;"><b>90</b></td> </tr> <tr> <td><b>Clay &amp; Gravel</b></td> <td style="text-align: center;"><b>10</b></td> <td style="text-align: center;"><b>100</b></td> </tr> <tr> <td><b>Vein - Yellow</b></td> <td style="text-align: center;"><b>11</b></td> <td style="text-align: center;"><b>111</b></td> </tr> </tbody> </table>			FORMATION	THICKNESS OF STRATUM	DEPTH TO BOTTOM OF STRATUM	<b>Sand &amp; Gravel</b>	<b>90</b>	<b>90</b>	<b>Clay &amp; Gravel</b>	<b>10</b>	<b>100</b>	<b>Vein - Yellow</b>	<b>11</b>	<b>111</b>	7 CASING: Threaded <input checked="" type="checkbox"/> Welded <input type="checkbox"/> Height: Above/Below Surface _____ ft. Diam. _____ ft. Weight <b>11</b> lbs./ft. 4 in. to _____ ft. Depth Drive Shoe? Yes <input type="checkbox"/> No <input type="checkbox"/>		
			FORMATION	THICKNESS OF STRATUM	DEPTH TO BOTTOM OF STRATUM												
			<b>Sand &amp; Gravel</b>	<b>90</b>	<b>90</b>												
			<b>Clay &amp; Gravel</b>	<b>10</b>	<b>100</b>												
<b>Vein - Yellow</b>	<b>11</b>	<b>111</b>															
8 SCREEN: Type: <b>Stainless</b> Dia.: <b>3 7/8"</b> Slot <del>XXXX</del> <b>12</b> Length <b>48"</b> Set between <b>107</b> ft. and <b>111</b> ft. Fittings: <b>4 x 3 K-Packer, 4" x 3' stem</b>																	
9 STATIC WATER LEVEL <b>87</b> ft. below land surface																	
10 PUMPING LEVEL below land surface <b>NA</b> ft. after _____ hrs. pumping _____ g.p.m. _____ ft. after _____ hrs. pumping _____ g.p.m.																	
11 WATER QUALITY in Parts Per Million: Iron (Fe) _____ Chlorides (Cl) _____ <b>NA</b> Hardness _____ Other _____																	
12 WELL HEAD COMPLETION: <input type="checkbox"/> In Approved Pit <input checked="" type="checkbox"/> Pitless Adapter <input type="checkbox"/> 12" Above Grade																	
13 Well Grouted? <input type="checkbox"/> Yes <input checked="" type="checkbox"/> No <input type="checkbox"/> Neat Cement <input type="checkbox"/> Bentonite <input type="checkbox"/> _____ Depth: From _____ ft. to _____ ft.																	
14 Nearest Source of possible contamination <b>50</b> feet <b>from any</b> Direction <b>septic</b> Type Well disinfected upon completion <input checked="" type="checkbox"/> Yes <input type="checkbox"/> No																	
15 PUMP: <input type="checkbox"/> Not installed Manufacturer's Name <b>Flint &amp; Walling</b> Model Number <b>10BK9</b> HPI _____ Volts <b>220</b> Length of Drop Pipe <b>91</b> ft. capacity <b>19</b> G.P.M. Type: <input checked="" type="checkbox"/> Submersible <input type="checkbox"/> Jet <input type="checkbox"/> Reciprocating																	
16 Remarks, elevation, source of data, etc.  ADDED INFO BY DRILLER, ITEM NO. *CORRECTED BY <i>[Signature]</i> **ADDITION BY <i>[Signature]</i> ELEVATION _____ DEPTH TO ROCK _____			17 WATER WELL CONTRACTOR'S CERTIFICATION: This well was drilled under my jurisdiction and this report is true to the best of my knowledge and belief. <b>GEO. P. REID &amp; SON</b> <b>0369</b> REGISTERED BUSINESS NAME REGISTRATION NO. Address <b>Box 5 Howe, IN 46746</b> Signed <i>William T. Reid</i> Date <b>12/21/86</b> AUTHORIZED REPRESENTATIVE														

TAX NO:

MICHIGAN DEPARTMENT OF PUBLIC HEALTH  
WATER WELL AND PUMP RECORD

PERMIT NO:  
W19862

1. LOCATION OF WELL  
County St Joseph

Township Name Burn Oak

Fraction SW 1/4 SE 1/4

Section No. 32

Town No. 75

Range No. 9W

Distance and Direction from Road Intersection  
Street Address & City of Well Location

3. OWNER OF WELL  
Address Richard Long  
29790 E Lafayette  
Sturgis MI  
Address Same as Well Location  Yes  No

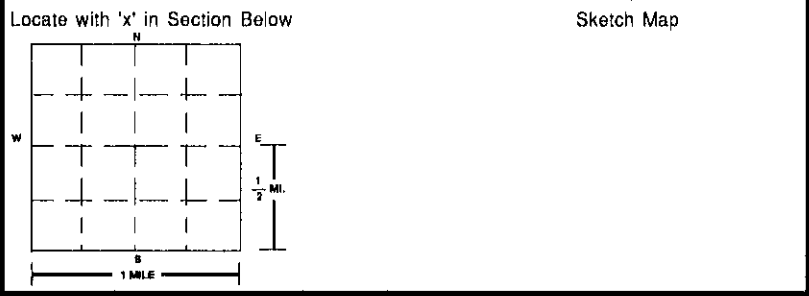

4. WELL DEPTH: 112 ft. Date Completed 4/10/98  
 New Well  
 Replacement Well

5.  Cable Tool  Rotary  Driven  Dug  
 Hollow Rod  Auger/Bored  Jetted

6. USE:  Household  Type I Public  Type III Public  
 Irrigation  Type IIa Public  Heat Pump  
 Test Well  Type IIb Public

7. CASING:  Steel  Threaded  Plastic  Welded  
 Other

Height: Above/Below Surface: 1 ft  
Diameter: 5" in. to 107 ft. depth  
Weight: 50R21 lbs./ft.

BORE HOLE: Diameter: 8 1/8 in. to 107 ft. depth  
 Drive Shoe  Shale Packer

2. FORMATION DESCRIPTION	THICKNESS OF STRATUM	DEPTH TO BOTTOM OF STRATUM
Surface	2	2
Gravel & Rocks	17	19
Rocks	7	26
Sand	14	48
Blue Clay	50	98
Sand & Gravel	14	112

8. SCREEN:  Not Installed  Gravel-Packed  
Type plastic Diameter 4"  
Slot/Gauze 18 Length: 5'  
Set Between 107 ft. and 112 ft.  
FITTINGS:  K-Packer  Bremer Check  
 Blank Above Screen ft. Other

9. STATIC WATER LEVEL: 60 ft. Below Land Surface  Flowing

10. PUMPING LEVEL: Below Land Surface  
ft. After \_\_\_\_\_ hrs. Pumping at \_\_\_\_\_ G.P.M.  
 Plunger  Bailor  Air  Test Pump

11. WELL HEAD COMPLETION:  
 Pitless Adapter  12" Above Grade  
 Basement Offset  Well House

12. WELL GROUTED?  No  Yes From 0 to 100 ft.  
 Neat Cement  Bentonite  Other Quidgrout  
No. of Bags 12 Additives

13. NEAREST SOURCE OF POSSIBLE CONTAMINATION:  
Type Septic Distance 50+ ft. Direction N-W  
Type \_\_\_\_\_ Distance \_\_\_\_\_ ft. Direction \_\_\_\_\_

15. ABANDONED WELL PLUGGED?  Yes  No  
Casing Diameter \_\_\_\_\_ in. Depth \_\_\_\_\_ ft.  
PLUGGING MATERIAL:  Neat Cement  Bentonite Slurry  
 Cement/Bentonite Slurry  Concrete Grout  Bentonite Chips  
No. of Bags \_\_\_\_\_ Casing Removed?  Yes  No

14. PUMP:  Not Installed  Pump Installation Only  
Manufacturer's Name Red Jacket  
Model Number \_\_\_\_\_ HP 12 Volts 220  
Length of Drop Pipe \_\_\_\_\_ ft. Capacity 12 G.P.M.  
TYPE:  Submersible  Jet  Other \_\_\_\_\_  
PRESSURE TANK:  
Manufacturer's Name Well & Tool  
Model Number 250 Capacity \_\_\_\_\_ Gallons 120

16. REMARKS: (Elevation, Source of Data, etc.)

17. DRILLING MACHINE OPERATOR:  
 Employee  Subcontractor  
Name Nicko Grabel

15. WATER WELL CONTRACTOR'S CERTIFICATION:  
This well was drilled under my jurisdiction and this report is true to the best of my knowledge and belief. 14-1708  
Mahl + Son Well Drilling Co LLC  
REGISTERED BUSINESS NAME REGISTRATION NO.  
Address 1125 M60 East Cassopolis MI  
Signed Michael H Grabel Date 4-30-98  
AUTHORIZED REPRESENTATIVE

MICHIGAN DEPARTMENT OF PUBLIC HEALTH  
WATER WELL AND PUMP RECORD

Tax no:

Permit no: 17594

1. Location of well  
County: St. Joseph

Township name: Burr Oak

Fraction: NW 1/4 NW 1/4 NE 1/4

Section: 32

Town no: 7S

Range no: 9W

Distance and Direction from Road Intersection  
.75 mile East of Big Hill Rd. on South side of  
Witt Lake Rd.

3. Owner of well: Fred Penner  
Address: 29753 Witt Lake Rd.  
Sturgis, MI 49091  
Address same as well location? Yes

SPEC HOUSE  
29753 Witt Lake Rd., Sturgis  
Street address & city of well location

4. Well depth: 49 ft.  
Date completed: 10/03/96 New well

Locate with "x" in section below

Sketch map

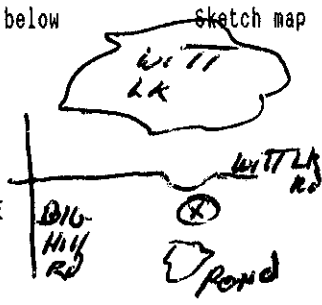
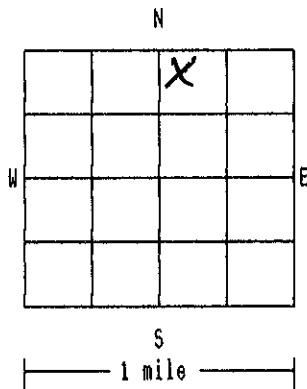

5. Drilling method: Jetted

6. Use: domestic

7. Casing: Steel, threaded  
Casing diameter: 4.00 in. to 45.00 ft. depth  
in. to ft. depth  
Bore hole diameter: in. to ft. depth  
in. to ft. depth

Height: Above/Below  
Surface: ft.  
Weight: 11.0 lbs./ft.  
Drive shoe: No  
Shale packer:

8. Screen  
Type: stainless Diameter: 3.75 in.  
Slot/Gauze: 12 slot Length: 48 in.  
Set between: 45.00 ft. and 49 ft.  
Fittings: K-Packer  
Blank above screen: 2.00 ft. Other:

2. Formation description	Thickness of stratum	Depth to bottom of stratum
black muck, sand & grav	5	5
brown clay, sand & grav	25	30
blue sand & gravel	19	49

9. Static water level: 3.5 ft. below land surface

10. Pumping level: Below land surface  
ft. after hrs. pumping at 50 G.P.M.  
Using: Plunger

RECEIVED  
MICH DEPT OF PUBLIC HEALTH

JAN 13 1997

BUREAU OF SURVEYING AND  
GEOLOGICAL RESEARCH

11. Well head completion: pitless adapter

12. Well grouted? Yes  
Granular bentonite  
No. of bags: 1

13. Nearest source of possible contamination  
Type Distance ft. Direction  
Type Distance ft. Direction

15. Abandoned well plugged?  
Casing diameter in. Depth ft.  
Plugging material:  
No. of bags: Casing removed?

14. Pump  
Manufacturer: F&W  
Model number: 4F10G05-305  
Length of drop pipe: 21.00 ft. Capacity: 12 G.P.M.  
Type:  
Pressure tank --  
Manufacturer: Amtrol  
Model number: WX-202 Capacity: 20 gallons

16. Remarks:

17. Drilling machine operator  
Employee  
Name: Todd Gotshall

15. Water well contractor's certification  
This well was drilled under my jurisdiction and this report is true to the best of my  
knowledge and belief.  
George P. Reid & Son 91-2059  
P.O. Box 10, Howe, IN 46746  
Signed Thomas P. Reid Date: 11/20/96



JAN 04 1978

**WATER WELL RECORD**

ACT 294 PA 1965

*SW* *SPZ*

MICHIGAN DEPARTMENT OF PUBLIC HEALTH

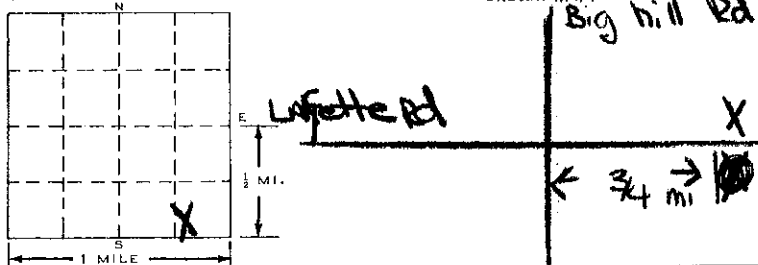
<b>1 LOCATION OF WELL</b>		<b>3 OWNER OF WELL:</b>													
County <b>St. Joseph</b>	Township Name <b>Burr Oak</b>	Fraction <b>SE 1/4 SE 1/4 SW 1/4</b>	Section Number <b>32</b>												
Distance And Direction from Road Intersections <b>3/4 mile E. of Big Hill Rd. on N. side of E. LaFayette Rd.</b>		Town Number <b>7</b> S. Range Number <b>9</b> W.													
Street address & City of Well Location <b>3/4 mile E. of Big Hill Rd. on N. side of E. LaFayette Rd.</b>		Address <b>R.R. 1 Sturgis MI 49091</b>													
Locate with "X" in section below 		Date of Completion <b>4/7/77</b>													
<table border="1" style="width: 100%; border-collapse: collapse;"> <tr> <th style="width: 50%;">FORMATION</th> <th style="width: 15%;">THICKNESS OF STRATUM</th> <th style="width: 15%;">DEPTH TO BOTTOM OF STRATUM</th> </tr> <tr> <td><b>Gravel</b></td> <td><b>40</b></td> <td><b>40</b></td> </tr> <tr> <td><b>Clay</b></td> <td><b>90</b></td> <td><b>130</b></td> </tr> <tr> <td><b>Gravel</b></td> <td><b>9</b></td> <td><b>139</b></td> </tr> </table>		FORMATION	THICKNESS OF STRATUM	DEPTH TO BOTTOM OF STRATUM	<b>Gravel</b>	<b>40</b>	<b>40</b>	<b>Clay</b>	<b>90</b>	<b>130</b>	<b>Gravel</b>	<b>9</b>	<b>139</b>	4 WELL DEPTH: (completed) <b>139</b> ft.	
		FORMATION	THICKNESS OF STRATUM	DEPTH TO BOTTOM OF STRATUM											
		<b>Gravel</b>	<b>40</b>	<b>40</b>											
<b>Clay</b>	<b>90</b>	<b>130</b>													
<b>Gravel</b>	<b>9</b>	<b>139</b>													
5 <input type="checkbox"/> Cable tool <input type="checkbox"/> Rotary <input type="checkbox"/> Driven <input type="checkbox"/> Dug <input type="checkbox"/> Hollow rod <input checked="" type="checkbox"/> Jetted <input type="checkbox"/> Bored <input type="checkbox"/>		6 USE: <input checked="" type="checkbox"/> Domestic <input type="checkbox"/> Public Supply <input type="checkbox"/> Industry <input type="checkbox"/> Irrigation <input type="checkbox"/> Air Conditioning <input type="checkbox"/> Commercial <input type="checkbox"/> Test Well <input type="checkbox"/>													
7 CASING: Threaded <input checked="" type="checkbox"/> Welded <input type="checkbox"/> Diam. _____ Height: Above/Below Surface _____ ft. <b>4</b> in. to <b>135</b> ft. Depth Weight <b>11</b> lbs./ft. _____ in. to _____ ft. Depth Drive Shoe? Yes <input checked="" type="checkbox"/> No <input type="checkbox"/>		8 SCREEN: Type: <b>Stainless</b> Dia.: <b>3 7/8"</b> Slot/ <del>Gauge</del> <b>12</b> Length <b>4'</b> Set between <b>135</b> ft. and <b>139</b> ft. Fittings: <b>4 x 3 k-packer 3 1/2" stem</b>													
9 STATIC WATER LEVEL <b>44</b> ft. below land surface		10 PUMPING LEVEL below land surface _____ ft. after _____ hrs. pumping _____ g.p.m. <b>NA</b> ft. after _____ hrs. pumping _____ g.p.m.													
11 WATER QUALITY in Parts Per Million: Iron (Fe) _____ Chlorides (Cl) _____ <b>NA</b> Hardness _____ Other _____		12 WELL HEAD COMPLETION: <input type="checkbox"/> In Approved Pit <input checked="" type="checkbox"/> Pitless Adapter <input type="checkbox"/> 12" Above Grade													
13 Well Grouted? <input type="checkbox"/> Yes <input checked="" type="checkbox"/> No <input type="checkbox"/> Neat Cement <input type="checkbox"/> Bentonite _____ Depth: From _____ ft. to _____ ft.		14 Nearest Source of possible contamination <b>50</b> feet <b>from any</b> Direction <b>septic</b> Type Well disinfected upon completion <input checked="" type="checkbox"/> Yes <input type="checkbox"/> No													
15 PUMP: <input type="checkbox"/> Not installed Manufacturer's Name <b>F &amp; W</b> Model Number <b>7BK7</b> HP <b>3/4</b> volts <b>220</b> Length of Drop Pipe <b>63' x 1 1/4"</b> Capacity <b>19</b> G.P.M. Type: <input checked="" type="checkbox"/> Submersible <input type="checkbox"/> Jet <input type="checkbox"/> Reciprocating		16 Remarks, elevation, source of data, etc. <i>OB</i>													
17 WATER WELL CONTRACTOR'S CERTIFICATION: This well was drilled under my jurisdiction and this report is true to the best of my knowledge and belief. <b>GEO. P. REID &amp; SON</b> REGISTRATION NO. <b>0869</b> Address <b>Box 5 Howe, IN 46746</b> Signed <i>William T. Reid</i> Date <b>12/29/77</b> AUTHORIZED REPRESENTATIVE		USE A 2ND SHEET IF NEEDED													







MICHIGAN DEPARTMENT OF CONSERVATION  
GEOLOGICAL SURVEY DIVISION

Permit No.

Page \_\_\_\_\_ of \_\_\_\_\_  
Sample No. \_\_\_\_\_

WATER WELL RECORD

Owner No.

County St. Joseph Twp. Butt Oak NW 4 NW 4 NE 4 Sec. 32 Town 7S N/S. 9W E/W. 9

Distance from Roads, Section Lines, etc.

1 mile N., 1 1/2 m. E. of Sturgis on Witt lake road

Surface dirt

FORMATION	THICKNESS OF STRATUM	DEPTH TO BOTTOM OF STRATUM	Owner:
Surface dirt	5	5	E. J. Poorman
Sand	30	35	Address: Sturgis, Michigan
Sand and clay	7	42	Driller and Address: B. J. Lewis & Sons, Cassopolis, Mich
Heavy sand	6	48	Well Depth: <u>48</u> ft. Date of Completion _____
			<input checked="" type="checkbox"/> Cable tool <input type="checkbox"/> Rotary <input type="checkbox"/> Dug <input type="checkbox"/> R.C. <input type="checkbox"/> Driven <input type="checkbox"/> Jetted <input type="checkbox"/> Bored
			Use: <input type="checkbox"/> Domestic <input type="checkbox"/> Public Supply <input type="checkbox"/> Industry <input type="checkbox"/> Irrigation <input type="checkbox"/> Air Conditioning <input type="checkbox"/> Dewatering <input type="checkbox"/> Test Well <input type="checkbox"/> _____
			Casing: Diam. <u>2</u> in. to <u>4</u> ft. Depth _____ ft. Height: Above/Below surface _____ ft. Type-Weight _____ In. to _____ ft. Depth _____
			Screen: Type: _____ Dia: _____ Slot/Gauze _____ Length _____ Set between _____ ft. and _____ ft.
			Accessories: _____
			Water level: <u>35</u> ft. above/below _____ _____ ft. above/below _____
			Meas. by _____ Date _____
			Drawdown: _____ ft. after _____ hrs. pumping _____ g.p.m. _____ ft. after _____ hrs. pumping _____ g.p.m. Meas. by _____ Date _____
			Flow: _____ g.p.w./g.p.h. Temp: _____ °F
			Water Quality in Parts Per Million: Iron (Fe) _____ Chlorides (Cl) _____ Hardness _____
			Elevation: _____ ft. above _____
			Source of data: _____ Dick Willard
			Record by: _____ JB Date: 2/21/64

Remarks:

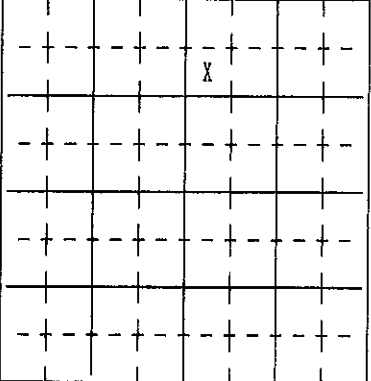
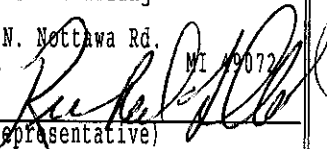
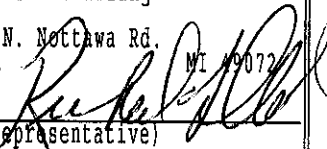
1. Location of Well		County St. Joseph	Township Burr Oak	Fraction NW 1/4 NW 1/4 NE 1/4	Section Number 32	Town Number 7 S	Range Number 9 W
Distance & Direction From Road Intersection 3/4 mile east of Big Hill Rd. on south side of Witt Lake Rd.				3. Owner of Well: Marvin Ailstock			
Street & City of Well 29611 Witt Lale Rd. Sturgis				Address 29611 Witt Lale Rd. Sturgis MI 49091			
Address Same as Well Location? Yes				4. Well Depth 73 Date Completed 09/03/98 Type New			
Sketch Map 				5. METHOD: Rotary Other			
				6. USE: Household Other			
2. FORMATION DESCRIPTION				7. CASING: Plastic		Height Above/Below Above Surface 1 ft.	
				Diameter 5 in to 73 ft. depth		Weight lbs/ft.	
Med Br. Sand W/Clay 4 4				BORE HOLE Diameter 8 in to 73 ft. depth		Drive Shoe Yes X No	
Coarse Lt. Br. Sand 4 8						Shale Packer Yes X No	
Fine Lt. Br. Gravel 24 32				8. SCREEN: Not Installed			
Gray Clay 36 68				Type PVC Diameter 5 inch			
Coarse Lt. Gray Sand 5 73				Slot/Gauze Slot 18 Length 5 ft			
GROUND WATER ONLY SEC.				Set Between 68 ft and 73 ft			
				Fittings Blank Above Screen 0 Other			
GROUND WATER ONLY SEC.				9. STATIC WATER LEVEL 15 Ft. Below Land Surface Flow			
				10. PUMPING LEVEL: below land surface			
GROUND WATER ONLY SEC.				15 Ft. after 1 hrs. pumping at 25 G.P.M.			
				Plunger Bailer X Air Test Pump G.P.M.			
GROUND WATER ONLY SEC.				11. WELL HEAD COMPLETION X Pitless Adapter X 12" abv grade			
				Basement Offset Well House			
GROUND WATER ONLY SEC.				12. WELL GROUTED No X Yes From 0 to 65 Ft.			
				Neat Cement X Bentonite Other			
GROUND WATER ONLY SEC.				No. Bags Cement 3.50 Additives			
				13. NEAREST SOURCE OF POSSIBLE CONTAMINATION			
GROUND WATER ONLY SEC.				Type septic Distance ni Ft. Direction s			
				Type Distance Ft. Direction			
15. ABANDONED WELL PLUGGED? Yes No				14. PUMP Not Installed Pump Installation Only			
Casing Diameter ft. Depth ft.				Manufacturer's Name F&W			
PLUGGING MATERIAL				Model Number 4F10G05305 HP 1/2 Volts 220			
No. of Bags Casing Removed Yes No				Length of drop pipe 40 Ft. Capacity 10 GPM			
16. REMARKS				Type X Submersible Jet			
				Pressure Tank Name Xtrol			
17. Rig Operator's Name: Rick Clark				Pressure Tank Model 203 Capacity 80 Gallons			
				X Employee Subcontractor			
AUTHORITY: Act 368 PA 1978 COMPLETION: Required				18. WATER WELL CONTRACTORS CERTIFICATION			
				PENALTY: Conviction of a violation of any provision is a misdemeanor.			
IMPORTANT: File with deed.				This well was drilled under my jurisdiction, and this report is true to the best of my knowledge and belief			
				REGISTERED BUSINESS NAME: Clark Well Drilling			
DATE: 8/4/98 SIGNED: 				REGISTRATION NUMBER: 1794			
				ADDRESS: 51833 N. Nottawa Rd. Mendon MI 49072			
				DATE: 8/4/98 SIGNED: 			
				(Authorized Representative)			
				(Geological Survey Copy)			



FEB 25 1983

MICHIGAN DEPARTMENT OF PUBLIC HEALTH  
WATER WELL AND PUMP RECORD

PERMIT NUMBER

PART 127 ACT 368, P.A. 1978

**1 LOCATION OF WELL**

County **St. Joseph** Township Name **Burr Oak** Fraction **SW 1/4 NW 1/4 SW 1/4** Section Number **32** Town Number **7** Range Number **9**

Distance And Direction From Road Intersection  
**1/10 mi. N. of LaFayette Rd. on the E. side of Big Hill Rd.**

Street Address & City of Well Location  
**Big Hill Rd. Sturgis, MI 49091**

Address Same As Well Location?  Yes  No

Locate with "X" in Section Below

Sketch Map:

**2 FORMATION DESCRIPTION**

FORMATION DESCRIPTION	THICKNESS OF STRATUM	DEPTH TO BOTTOM OF STRATUM
Sand & Gravel & Rocks	90	90
Clay	10	100
Sand & Gravel	10	110

**3 OWNER OF WELL:**  
**Chauncey Jim Gilhams**  
Address **Big Hill Rd. Sturgis, MI 49091**  
Address Same As Well Location?  Yes  No

**4 WELL DEPTH: (completed)** **110** ft. Date of Completion **6/1/82**

**5**  Cable tool  Rotary  Driven  Dug  
 Hollow rod  Auger  Jetted

**6 USE:**  Domestic  Type I Public  Type III Public  
 Irrigation  Type IIa Public  Heat pump  
 Test Well  Type IIb Public

**7 CASING:** Diameter  Steel  Threaded  Plastic  Welded  
**2** in. to **107** ft. depth  
Height: Above/Below Surface \_\_\_\_\_ ft.  
Weight **3.75** lbs./ft.  
GROUTED DRILL HOLE DIAMETER \_\_\_\_\_ in. to \_\_\_\_\_ ft. depth  
Drive Shoe  Yes  No

**8 SCREEN:**  Not installed  
Type **Stainless** Diameter **1 1/2"**  
Slot/Screen **10** Length **36"**  
Set between **107** ft. and **110** ft.  
FITTINGS:  K-Packer  Lead Packer  Bremer Check  
 Blank above screen \_\_\_\_\_ ft. Other \_\_\_\_\_

**9 STATIC WATER LEVEL:** **76** ft. below land surface  Flow

**10 PUMPING LEVEL:** below land surface **900 GPH**  
\_\_\_\_\_ ft. after \_\_\_\_\_ hrs. pumping at \_\_\_\_\_ G.P.M.  
\_\_\_\_\_ ft. after \_\_\_\_\_ hrs. pumping at \_\_\_\_\_ G.P.M.

**11 WELL HEAD COMPLETION:**  Pitless adapter  12" above grade  
 Basement offset  Approved pit

**12 WELL GROUTED?**  No  Yes From \_\_\_\_\_ to \_\_\_\_\_ ft.  
 Neat cement  Bentonite  Other \_\_\_\_\_  
No. of bags of cement \_\_\_\_\_ Additives \_\_\_\_\_

**13 NEAREST SOURCE OF POSSIBLE CONTAMINATION**  
Type **septic** Distance **50** ft. Direction **any**  
Well disinfected upon completion?  Yes  No

**14 PUMP:**  Not Installed  Pump Installation Only  
Manufacturer's name **Flint & Walling**  
Model number **C62720H-8204 2** Volts **230**  
Length of Drop Pipe **84** ft. capacity **10** G.P.M.  
TYPE:  Submersible  Jet  
PRESSURE TANK:  
Manufacturer's name **Antrol**  
Model number **WX-202** Capacity **42** Gallons

**15. Remarks, elevation, source of data, etc.**  
ADDED INFO BY DRILLER, ITEM NO. \_\_\_\_\_  
\*CORRECTED BY \_\_\_\_\_  
\*\*ADDITION BY *W/S*  
ELEVATION \_\_\_\_\_  
DEPTH TO ROCK \_\_\_\_\_

**16. WATER WELL CONTRACTOR'S CERTIFICATION:**  
This well was drilled under my jurisdiction and this report is true to the best of my knowledge and belief.  
**GEO. P. REID & SON** **91-0369**  
REGISTERED BUSINESS NAME REGISTRATION NO.  
Address **BOX 5 HOWE, IN 46746**  
Signed *Geo. P. Reid* Date **1/19/83**  
AUTHORIZED REPRESENTATIVE



**WATER WELL RECORD**  
ACT 294 PA 1965

MICHIGAN DEPARTMENT  
OF  
PUBLIC HEALTH

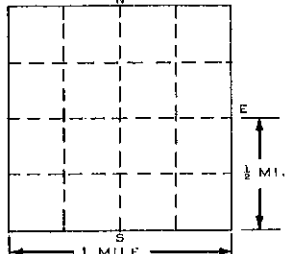
1 LOCATION OF WELL		3 OWNER OF WELL:	
County: <u>St. Joseph</u>	Township Name: <u>Burns Oak</u>	Fraction: <u>N 1/4 S 1/4 W 1/4</u>	Section Number: <u>32</u> Town Number: <u>7</u> Range Number: <u>9</u>
Distance And Direction from Road Intersections: <u>900 ft west of Big Hill Road</u>		Address: <u>Harold Lung</u> <u>67805 Big Hill Road</u> <u>Sturgis, Mich.</u>	
Street address & City of Well Location		4 WELL DEPTH: (completed) Date of Completion <u>94</u> ft. <u>June 28 - 1984</u>	
Locate with "X" in section below		5 <input type="checkbox"/> Cable tool <input type="checkbox"/> Rotary <input type="checkbox"/> Driven <input type="checkbox"/> Dug <input type="checkbox"/> Hollow rod <input checked="" type="checkbox"/> Jetted <input type="checkbox"/> Bored <input type="checkbox"/>	
Sketch Map: 		6 USE: <input checked="" type="checkbox"/> Domestic <input type="checkbox"/> Public Supply <input type="checkbox"/> Industry <input type="checkbox"/> Irrigation <input type="checkbox"/> Air Conditioning <input type="checkbox"/> Commercial <input type="checkbox"/> Test Well <input type="checkbox"/>	
2 FORMATION		7 CASING: Threaded <input checked="" type="checkbox"/> Welded <input type="checkbox"/> Height: Above/Below Surface <u>1</u> ft. Weight _____ lbs./ft. Drive Shoe? Yes <input type="checkbox"/> No <input checked="" type="checkbox"/>	
		8 SCREEN: Type: <u>9" slotted steel</u> Dia.: <u>1 1/2"</u> Slot/Gauge <u>7</u> Length <u>49"</u> Set between <u>90</u> ft. and <u>94</u> ft. Fittings: <u>4 couplings &amp; head</u>	
		9 STATIC WATER LEVEL <u>47</u> ft. below land surface	
		10 PUMPING LEVEL below land surface <u>47</u> ft. after _____ hrs. pumping _____ g.p.m. _____ ft. after _____ hrs. pumping _____ g.p.m.	
		11 WATER QUALITY in Parts Per Million: Iron (Fe) _____ Chlorides (Cl) _____ Hardness _____ Other _____	
12 WELL HEAD COMPLETION: <input type="checkbox"/> In Approved Pit <input type="checkbox"/> Pitless Adapter <input checked="" type="checkbox"/> 12" Above Grade			
13 Well Grouted? <input type="checkbox"/> Yes <input checked="" type="checkbox"/> No <input type="checkbox"/> Neat Cement <input type="checkbox"/> Bentonite <input type="checkbox"/> Depth: From _____ ft. to _____ ft.			
14 Nearest Source of possible contamination <u>system &amp; drums not installed</u> feet _____ Direction _____ Type _____ Well disinfected upon completion <input checked="" type="checkbox"/> Yes <input type="checkbox"/> No			
15 PUMP: <input checked="" type="checkbox"/> Not installed Manufacturer's Name _____ Model Number _____ HP _____ Volts _____ Length of Drop Pipe _____ ft. capacity _____ G.P.M. Type: <input type="checkbox"/> Submersible <input type="checkbox"/> Jet <input type="checkbox"/> Reciprocating			
16 Remarks, elevation, source of data, etc.		17 WATER WELL CONTRACTOR'S CERTIFICATION: This well was drilled under my jurisdiction and this report is true to the best of my knowledge and belief. <u>Harold Lung</u> <u>75-0205</u> REGISTERED BUSINESS NAME REGISTRATION NO. Address <u>325 Lakeside Ave Sturgis Mich.</u> Signed <u>Harold Lung</u> Date <u>June 28 1984</u> AUTHORIZED REPRESENTATIVE	

RECEIVED  
Mich. Dept. of Public Health  
APR 23 1985  
Bureau of Environmental and  
Occupational Health - GWQS

MICHIGAN DEPARTMENT OF PUBLIC HEALTH  
**WATER WELL AND PUMP RECORD**

--	--	--	--	--	--	--	--

**PERMIT NUMBER**

<b>1 LOCATION OF WELL</b>					
County <b>St. Joseph</b>	Township Name <b>Burr Oak</b>	Fraction <b>SW 1/4 SW 1/4 SW 1/4</b>	Section Number <b>32</b>	Town Number <b>76 N/S</b>	Range Number <b>9W E/W</b>

Distance And Direction From Road Intersection  
**.22 mile East of Big Hill Rd. on North side of E. Lafayette Rd.**  
**NEW WELL**

Street Address & City of Well Location **29220 E. Lafayette Rd., Sturgis**

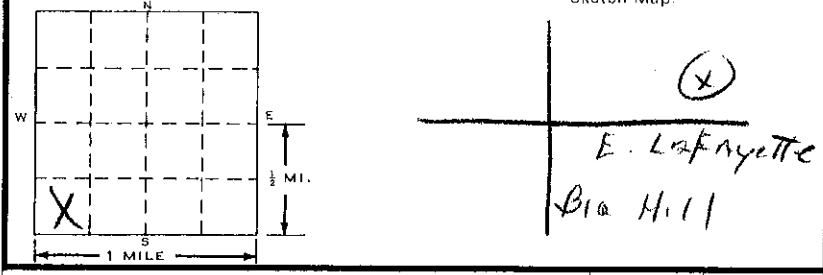

**3 OWNER OF WELL:**  
**Steve Coker**  
 Address **29220 E. Lafayette Rd. Sturgis, MI 49091**  
 Address Same As Well Location?  Yes  No

**4 WELL DEPTH:** Date Completed  New Well  
**58 FT.** **07 25 92**  Replacement Well

**5**  Cable tool  Rotary  Driven  Dug  
 Hollow rod  Auger  Jetted

**6 USE:**  Domestic  Type I Public  Type III Public  
 Irrigation  Type IIa Public  Heat pump  
 Test Well  Type IIb Public

**7 CASING:**  Steel  Threaded  Plastic  Welded  
 Diameter **4.00** in. to **54.00** ft. depth  
 Height: Above/Below Surface \_\_\_\_\_ ft.  
 Weight **11.00** lbs./ft.  
 Grouted Drill Hole Diameter \_\_\_\_\_ in. to \_\_\_\_\_ ft. depth  
 Drive Shoe  Yes  No

**2 FORMATION DESCRIPTION**

FORMATION DESCRIPTION	THICKNESS OF STRATUM	DEPTH TO BOTTOM OF STRATUM
<b>brown clay &amp; gravel</b>	<b>34</b>	<b>34</b>
<b>yellow sand &amp; gravel</b>	<b>24</b>	<b>58</b>

**8 SCREEN:**  Not Installed  
 Type **stainless** Diameter **3.75** in.  
 Slot/Gauze **12 slot** Length **48** in.  
 Set between **54.00** ft. and **58** ft.  
 FITTINGS:  K-Packer  Lead Packer  Bromer Check  
 Blank above screen **2.00** ft. Other \_\_\_\_\_

**9 STATIC WATER LEVEL:** \_\_\_\_\_ ft. below land surface  Flow

**10 PUMPING LEVEL:** below land surface  
 \_\_\_\_\_ ft. after \_\_\_\_\_ hrs. pumping at **35** G.P.M.  
 \_\_\_\_\_ ft. after \_\_\_\_\_ hrs. pumping at \_\_\_\_\_ G.P.M.

**11 WELL HEAD COMPLETION:**  Pitless adaptor  12" above grade  
 Basement offset  Approved pit

**12 WELL GROUTED?**  No  Yes From \_\_\_\_\_ to \_\_\_\_\_ ft.  
 Neat cement  Bentonite  Other **granular**  
 No. of bags of cement \_\_\_\_\_ Additives \_\_\_\_\_

**13 Nearest source of possible contamination**  
 Type \_\_\_\_\_ Distance \_\_\_\_\_ ft. Direction \_\_\_\_\_  
 Well disinfected upon completion?  Yes  No  
 Was old well plugged?  Yes  No

**14 PUMP:**  Not Installed  Pump Installation Only  
 Manufacturer's name **F&W**  
 Model number **4E19A07-301** HP **3/4** Volts **230**  
 Length of Drop Pipe **42.00** ft. capacity **17** G.P.M.  
 TYPE:  Submersible  Jet

**PRESSURE TANK:**  
 Manufacturer's name **Astral**  
 Model number **WX-250** Capacity **44** Gallons

15. Remarks, elevation, source of data, etc.  
**WP#13598**  
**pH: 8.0** Hardness in gpg: **13**  
**Iron in mg/l: .1** Nitrates in mg/l: **2.0**

17. Rig Operator's Name:  
**Todd Gotshall**

**16. WATER WELL CONTRACTOR'S CERTIFICATION:**  
 This well was drilled under my jurisdiction and this report is true to the best of my knowledge and belief.

**George P. Reid & Son** **91-2059**  
 REGISTERED BUSINESS NAME REGISTRATION NO.  
 Address **P.O. Box 101, Howard, IN 46746**  
 Signed *Thomas Reid* Date **08/04/92**  
 AUTHORIZED REPRESENTATIVE

**RECEIVED**  
 Mich. Dept. of Public Health  
**AUG 6 1992**  
 BUREAU OF ENVIRONMENTAL AND OCCUPATIONAL HEALTH-GWOS

**Authority:** Act 368 PA 1978  
**Completion:** Required  
**Penalty:** Conviction of a violation of any provision is a misdemeanor.



JUN 28 1978

**WATER WELL RECORD**

ACT 294 PA 1965

MICHIGAN DEPARTMENT OF PUBLIC HEALTH

<b>1 LOCATION OF WELL</b>			<b>3 OWNER OF WELL:</b>		
County <b>ST. JOSEPH</b>	Township Name <b>BURR OAK</b>	Fraction <b>SW 1/4 SW 1/4 SW 1/4</b>	Section Number <b>32</b>	Town Number <b>9</b> W.S.	Range Number <b>9</b> E/W.
Distance And Direction from Road Intersections <b>EAST LAFAYETTE ST. EAST OF BIG HILL RD. ON NORTH SIDE.</b>			Address <b>MARVIN WOOD EAST LAFAYETTE STURGIS, MI. 49091</b>		
Street address & City of Well Location Locate with "X" in section below			4 WELL DEPTH: (completed) Date of Completion <b>52'</b> ft. <b>6/5/78</b>		
Sketch Map 			5 <input type="checkbox"/> Cable tool <input type="checkbox"/> Rotary <input type="checkbox"/> Driven <input type="checkbox"/> Dug <input type="checkbox"/> Hollow rod <input checked="" type="checkbox"/> Jetted <input type="checkbox"/> Bored <input type="checkbox"/>		
			6 USE: <input checked="" type="checkbox"/> Domestic <input type="checkbox"/> Public Supply <input type="checkbox"/> Industry <input type="checkbox"/> Irrigation <input type="checkbox"/> Air Conditioning <input type="checkbox"/> Commercial <input type="checkbox"/> Test Well <input type="checkbox"/>		
2 FORMATION			7 CASING: Threaded <input checked="" type="checkbox"/> Welded <input type="checkbox"/> Height: Above/Below Surface _____ ft.		
			2" in. to <b>48 1/2</b> ft. Depth Weight <b>3.75</b> lbs./ft. Drive Shoe? Yes <input checked="" type="checkbox"/> No <input type="checkbox"/>		
little clay & dry gravel			8 SCREEN:		
little clay & sand & gravel			Type: <b>redhead</b> Dia.: <b>1 1/2"</b>		
gravel vein			Slot: <del>xxxx</del> <b>10</b> Length <b>42"</b>		
			Set between <b>48 1/2</b> ft. and <b>52</b> ft.		
			Fittings: <b>K-packer &amp; bremer 2' stem</b>		
			9 STATIC WATER LEVEL <b>38</b> ft. below land surface		
			10 PUMPING LEVEL below land surface _____ ft. after _____ hrs. pumping _____ g.p.m.		
			_____ ft. after _____ hrs. pumping <b>900 GPH.</b> g.p.m.		
			11 WATER QUALITY in Parts Per Million: Iron (Fe) _____ Chlorides (Cl) _____		
			Hardness <b>NA</b> Other _____		
			12 WELL HEAD COMPLETION: <input type="checkbox"/> In Approved Pit <input checked="" type="checkbox"/> Pitless Adapter <input type="checkbox"/> 12" Above Grade		
			13 Well Grouted? <input type="checkbox"/> Yes <input checked="" type="checkbox"/> No <input type="checkbox"/> Neat Cement <input type="checkbox"/> Bentonite <input type="checkbox"/>		
			Depth: From _____ ft. to _____ ft.		
			14 Nearest Source of possible contamination <b>50</b> feet from <b>any</b> Direction <b>septic</b> Type Well disinfected upon completion <input checked="" type="checkbox"/> Yes <input type="checkbox"/> No		
			15 PUMP: <input type="checkbox"/> Not installed Manufacturer's Name <b>Flint &amp; Walling</b> Model Number <b>CP-5</b> HP <b>1/2</b> Volts <b>110</b> Length of Drop Pipe <b>39</b> ft. capacity <b>9</b> G.P.M. Type: <input type="checkbox"/> Submersible <input checked="" type="checkbox"/> Jet <input type="checkbox"/> Reciprocating		
16 Remarks, elevation, source of data, etc. ADDED INFO BY DRILLER, ITEM NO. *CORRECTED BY **ADDITION BY <i>Jo</i> ELEVATION DEPTH TO ROCK <b>PERMIT # 2963</b>			17 WATER WELL CONTRACTOR'S CERTIFICATION: This well was drilled under my jurisdiction and this report is true to the best of my knowledge and belief. <b>GEORGE P. REID &amp; SON</b> <b>0369</b> REGISTERED BUSINESS NAME REGISTRATION NO. Address <b>BOX 5 HOWE, IN 46746</b> Signed <i>Wm. T. Reid</i> Date <b>6/7/78</b> AUTHORIZED REPRESENTATIVE <b>13</b>		

**OCT 18 1977**

**WATER WELL RECORD**  
ACT 294 PA 1965

MICHIGAN DEPARTMENT  
OF  
PUBLIC HEALTH

<b>1 LOCATION OF WELL</b>											
County <b>St. Joseph</b>		Township Name <b>Burr Oak</b>		Fraction <b>SW 1/4 SW 1/4 NW 1/4</b>		Section Number <b>32</b>		Town Number <b>7 XKS.</b>		Range Number <b>9 XR/W.</b>	
Distance And Direction from Road Intersections <b>1/4 mi. E. of E. Lafayette Rd. on the E. side of Big Hill Rd., 1/8 mi. E. of Rd. <del>XXXXXXXX</del></b>						3 OWNER OF WELL: <b>Tom Franks</b> Address <b>Route 1 Big Hill Rd. Sturgis, MI 49091</b>					
Street address & City of Well Location Locate with "X" in section below						4 WELL DEPTH: (completed) Date of Completion <b>225'</b> ft. <b>9/9/77</b>					
						5 <input type="checkbox"/> Cable tool <input type="checkbox"/> Rotary <input type="checkbox"/> Driven <input type="checkbox"/> Dug <input type="checkbox"/> Hollow rod <input checked="" type="checkbox"/> Jetted <input type="checkbox"/> Bored <input type="checkbox"/>					
						6 USE: <input checked="" type="checkbox"/> Domestic <input type="checkbox"/> Public Supply <input type="checkbox"/> Industry <input type="checkbox"/> Irrigation <input type="checkbox"/> Air Conditioning <input type="checkbox"/> Commercial <input type="checkbox"/> Test Well <input type="checkbox"/>					
						7 CASING: Threaded <input checked="" type="checkbox"/> Welded <input type="checkbox"/> Height: Above/Below Diam. _____ Surface _____ ft. <b>4</b> in. to <b>225</b> ft. Depth Weight <b>11</b> lbs./ft. _____ in. to _____ ft. Depth Drive Shoe? Yes <input checked="" type="checkbox"/> No <input type="checkbox"/>					
<b>2 FORMATION</b>		THICKNESS OF STRATUM		DEPTH TO BOTTOM OF STRATUM		8 SCREEN: Type: <b>None</b> Dia.: _____ Slot/Gauze _____ Length _____ Set between _____ ft. and _____ ft. Fittings: _____					
<b>Sand &amp; Gravel</b>		<b>120</b>		<b>120</b>		9 STATIC WATER LEVEL <b>63</b> ft. below land surface					
<b>Clay &amp; Sand</b>		<b>82</b>		<b>202</b>		10 PUMPING LEVEL below land surface <b>na</b> ft. after _____ hrs. pumping _____ g.p.m. _____ ft. after _____ hrs. pumping _____ g.p.m.					
<b>Gravel, Fine Sand</b>		<b>2</b>		<b>204</b>		11 WATER QUALITY in Parts Per Million: Iron (Fe) _____ Chlorides (Cl) _____ <b>na</b> Hardness _____ Other _____					
<b>Shale &amp; Gravel</b>		<b>7</b>		<b>211</b>		12 WELL HEAD COMPLETION: <input type="checkbox"/> In Approved Pit <input checked="" type="checkbox"/> Pitless Adapter <input type="checkbox"/> 12" Above Grade					
<b>Shale - Blue</b>		<b>14</b>		<b>225</b>		13 Well Grouted? <input type="checkbox"/> Yes <input checked="" type="checkbox"/> No <input type="checkbox"/> Neat Cement <input type="checkbox"/> Bentonite <input type="checkbox"/> Depth: From _____ ft. to _____ ft.					
						14 Nearest Source of possible contamination <b>50</b> feet from any direction <b>septic</b> Type _____ Well disinfected upon completion <input checked="" type="checkbox"/> Yes <input type="checkbox"/> No					
						15 PUMP: <input type="checkbox"/> Not installed Manufacturer's Name <b>Flint &amp; Walling</b> Model Number <b>10BK9</b> HP <b>1</b> Volts <b>220</b> Length of Drop Pipe <b>84</b> ft. capacity <b>19</b> G.P.M. Type: <input checked="" type="checkbox"/> Submersible <input type="checkbox"/> Jet <input type="checkbox"/> Reciprocating					
16 Remarks, elevation, source of data, etc. <i>o/p</i>						17 WATER WELL CONTRACTOR'S CERTIFICATION: This well was drilled under my jurisdiction and this report is true to the best of my knowledge and belief. <del>XXXXXXXXXXXX</del> <b>GEO. P. REID &amp; SON 0369</b> REGISTERED BUSINESS NAME REGISTRATION NO. Address <b>Box 5 Howe, IN 46746</b> Signed <i>William T. Reid</i> Date <b>9/19/77</b> AUTHORIZED REPRESENTATIVE					

