

TAX NO:

1. LOCATION OF WELL  
County: LIVINGSTON Township Name: SPRINGFIELD

Fraction: SW 1/4 NW 1/4 SE 1/4

Section No: 31

Town No: 4 N

Range Number: 8 E

Distance And Direction From Road Intersection  
Well Addr: 13683 NEAL ROAD HOLLY MI

3. Owner of Well: LOERCH DON  
Address: 576 FERNHURST LAKE ORION MI 48362  
Address Same as Well Location? YES

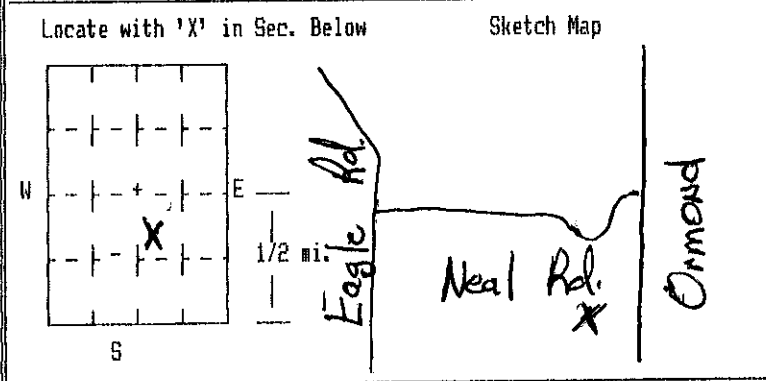

4. WELL DEPTH: 86 ft. Date Compl: 09/13/99 This is a: NEW WELL

5. EQUIPMENT USED: ROTARY  
6. WELL USE: HOUSEHOLD

7. CASING Type: PLASTIC Connection: THREADED  
Diam. 5 in. to 82 ft. Height ABOVE Surface 1 ft  
in. to ft. Weight lb./ft.  
Grouted Drill Hole Drive Shoe NO  
8.5 in. to 86 ft. Shale Packer NO  
in. to ft.

Formation Description	Thickness	Depth
SANDY BROWN CLAY	7	7
BROWN SAND	11	18
SANDY BROWN CLAY	7	25
BROWN SAND & GRAVEL	3	28
SANDY BROWN CLAY	34	62
SILTY BROWN SAND	4	66
SILTY GRAY SAND	12	78
GRAY SAND FINE - MEDIUM CLAY	8	86

8. Screen Type: S.S. Diam: 3 [ ] Not Inst.  
SLOT 7 Length: 4  
Set Between 82 ft. and 86 ft.  
Fittings: K-PACKER [ ] Blank above scrn: ft

9. Static Level: 44+ ft. Flow: [N]

10. Pumping Level below land surface:  
86 ft. after 1 hrs. @ 50 GPM  
[ ] Plunger [ ] Bailer [X] Air [ ] Test Pump

11. Well Head Completion: PITLESS ADAPTER

12. Grouted from 0 to 72 ft Material: BENTONITE  
Cement: 7 bags Additives: T-100

13. Nearest source of possible contamination:  
Type: SEPTIC TANK Distance: 90 ft. Dir: SE  
Type: Distance: ft. Dir:

14. Pump: [ ] Not Installed [ ] Installation Only  
Manufacturer's Name: RED JACKET  
Model: 100CNSW1-8 HP: 1 Voltage: 230  
Drop pipe: 60 ft. Capacity: 18 GPM  
Pump type: SUBMERSIBLE  
Pressure Tank Manufacturer's Name: WELL X-TROL  
Model: 251 Capacity: 62 Gal.

15. Abandoned Well Plugged? NO  
Casing Diameter in. Depth  
Plugging Material:  
No. of Bags Casing Removed?

16. Remarks, elevation, source of data, etc.

17. Drilling Machine Operator: [X] Employee [ ] Subcontractor  
Name GREG ADAMS - JEFF CDX

RECEIVED  
MICH DEPT OF ENVIRONMENTAL QUALITY  
SEP 30 1999

Drinking Water & Radiological Protection  
Ground Water Supply Section  
WELL CONSTRUCTION UNIT

WATER WELL CONTRACTOR'S CERTIFICATION:  
This well was drilled under my jurisdiction and this report is true to the best of my knowledge and belief.  
Registered Bus. Name ADAMS WELL DRILLING, INC. 47-1861  
Business Address 1122 S. Hacker Road Brighton MI 48116  
Signed: Mark Adams 09/13/99  
Authorized Representative Date

GW-2-228 9/93  
Authority: Act 368 PA 1978  
Completion: Required  
Penalty: Conviction of a violation of any provision is a misdemeanor.