

MICHIGAN DEPARTMENT OF ENVIRONMENTAL QUALITY  
 DRINKING WATER & RADIOLOGICAL PROTECTION DIVISION  
**WATER WELL AND PUMP RECORD**

Completion is required under authority of Part 127 Act 368 PA 1978  
 Failure to comply is a misdemeanor

TAX NO:

PERMIT NO:

99-0540NW

1. LOCATION OF WELL

County Livingston Township Name Iosco Fraction 1/4 1/4 1/4 Section No. 1 Town No. 2N Range No. 3E

Distance and Direction from Road Intersection  
1/2 mile E of Kerns Rd. on the S side of Crofoot Rd.

Street Address & City of Well Location 6472 Crofoot Road, Howell

Locate with 'x' in Section Below

Sketch Map

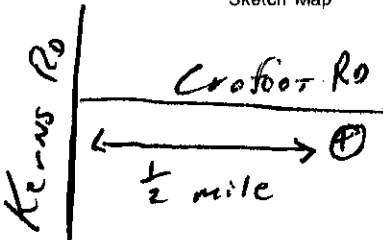
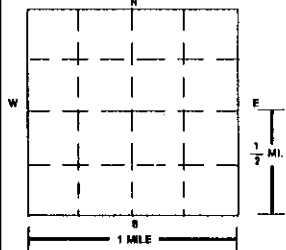

2. FORMATION DESCRIPTION

THICKNESS OF STRATUM DEPTH TO BOTTOM OF STRATUM

Brown clay	12	12
Sand	07	19
Brown clay	10	29
Gray clay	26	55
Medium-coarse gravel	03	58
Gray clay	15	73
Dolomite	03	76
Green shale	02	78
Limestone	04	82
Green sandstone/shale	30	112
Limestone	08	120
White sandstone	20	140

RECEIVED  
 DEPT. OF ENVIRONMENTAL QUALITY  
 AUG 9 1999  
 DIVISION OF DRINKING WATER & RADIOLOGICAL PROTECTION  
 GROUND WATER SECTION  
 WELL CONSTRUCTION UNIT  
 RECEIVED  
 JUL 16 1999  
 LIV. CTY. HEALTH DEPT.

15. ABANDONED WELL PLUGGED?  Yes  No  
 Casing Diameter \_\_\_\_\_ in. Depth \_\_\_\_\_ ft.  
 PLUGGING MATERIAL:  Neat Cement  Bentonite Slurry  
 Cement/Bentonite Slurry  Concrete Grout  Bentonite Chips  
 No. of Bags \_\_\_\_\_ Casing Removed?  Yes  No

16. REMARKS: (Elevation, Source of Data, etc.)

17. DRILLING MACHINE OPERATOR:  
 Employee  Subcontractor  
 Name Fred Wieting/Doni Blair

3. OWNER OF WELL

Address Grand Value Homes  
6791 Lansing Road  
Charlotte 48813  
 Address Same as Well Location  Yes  No

4. WELL DEPTH: 140' ft. Date Completed 06/21/99  New Well  Replacement Well

5.  Cable Tool  Rotary  Driven  Dug  
 Hollow Rod  Auger/Bored  Jetted

6. USE:  Household  Type I Public  Type III Public  
 Irrigation  Type IIa Public  Heat Pump  
 Test Well  Type IIb Public

7. CASING:  Steel  Threaded  Plastic  Welded  
 Other \_\_\_\_\_ Height: Above/Below Surface: \_\_\_\_\_ ft.  
 Diameter: 5 in. to 119 ft. depth Weight: SDR21 lbs./ft.  
 \_\_\_\_\_ in. to \_\_\_\_\_ ft. depth  
 BORE HOLE:  Drive Shoe  Shale Packer  
 Diameter: 8 1/2 in. to 119 ft. depth  
4 3/4 in. to 140 ft. depth

8. SCREEN:  Not Installed  Gravel-Packed  
 Type \_\_\_\_\_ Diameter \_\_\_\_\_  
 Slot/Gauze \_\_\_\_\_ Length: \_\_\_\_\_  
 Set Between \_\_\_\_\_ ft. and \_\_\_\_\_ ft.  
 FITTINGS:  K-Packer  Bremer Check  
 Blank Above Screen \_\_\_\_\_ ft. Other \_\_\_\_\_

9. STATIC WATER LEVEL: 25 ft. Below Land Surface  Flowing

10. PUMPING LEVEL: Below Land Surface 140 ft. After \_\_\_\_\_ hrs. Pumping at 50 G.P.M.  
 Plunger  Bailor  Air  Test Pump

11. WELL HEAD COMPLETION:  
 Pitless Adapter  12" Above Grade  
 Basement Offset  Well House

12. WELL GROUTED?  No  Yes From 0 to 119 ft.  
 Neat Cement  Bentonite  Other \_\_\_\_\_  
 No. of Bags 8 Additives Benseal

13. NEAREST SOURCE OF POSSIBLE CONTAMINATION:  
 Type septic Distance 50+ ft. Direction \_\_\_\_\_  
 Type \_\_\_\_\_ Distance \_\_\_\_\_ ft. Direction \_\_\_\_\_

14. PUMP:  Not Installed  Pump Installation Only  
 Manufacturer's Name Red Jacket  
 Model Number 50SEWL-8BC HP 1/2 Volts 230  
 Length of Drop Pipe 60 ft. Capacity 10 G.P.M.  
 TYPE:  Submersible  Jet  Other \_\_\_\_\_  
 PRESSURE TANK:  
 Manufacturer's Name Amtrol  
 Model Number 202 Capacity 20 Gallons 6

18. WATER WELL CONTRACTOR'S CERTIFICATION:  
 This well was drilled under my jurisdiction and this report is true to the best of my knowledge and belief.  
Dyer Well Drilling & Service, Inc. 2227  
 REGISTERED BUSINESS NAME REGISTRATION NO.  
 Address Lightsburg 48848-0370  
 Signed Michael Dyer Date 6-21-99  
 AUTHORIZED REPRESENTATIVE

MICHIGAN DEPARTMENT OF PUBLIC HEALTH  
WATER WELL AND PUMP RECORD

PERMIT NO: 98-1832NW Page of 1 1

TAX NO:

1. LOCATION OF WELL

County LIVINGSTON Township Name IOSCO

Fraction NW 1/4 NW 1/4 SE 1/4

Section No 1

Town No 2 N

Range Number 3 E

Distance And Direction From Road Intersection  
PARCEL 6

Well Addr: 6460 CROFOOT HOWELL MI

3. Owner of Well MEDALLION HOMES  
Address 5800 HIGHLAND ROAD  
WHITE LAKE MI 48383  
Address Same as Well Location? YES

4. WELL DEPTH 88 ft. Date Compl 02/11/99 This is a: NEW WELL

5. EQUIPMENT USED: ROTARY  
6. WELL USE: HOUSEHOLD

7. CASING Type: PLASTIC Connection: THREADED  
Diam. 5 in. to 73 ft. Height ABOVE Surface 1 ft  
3 in. to 88 ft. Weight 1b./ft.  
Grouted Drill Hole Drive Shoe NO  
8.5 in. to 73 ft. Shale Packer NO  
4.5 in. to 88 ft.

8. Screen Type: SLOTTED Diam: 3 [ ] Not Inst.  
SLOT SANDSTONE Length: 17  
Set Between 71 ft. and 88 ft.  
Fittings: K-PACKER [ ] Blank above scrn: ft

9. Static Level: 20'11 ft. Flow: [N]

10. Pumping Level below land surface:  
88 ft. after 1 hrs. @ 60 GPM  
[ ] Plunger [ ] Bailer [X] Air [ ] Test Pump

11. Well Head Completion: PITLESS ADAPTER

12. Grouted from 0 to 72 ft Material: BENTONITE  
Cement: 7 bags Additives: SUPERMUD

13. Nearest source of possible contamination:  
Type: SEPTIC TANK Distance: 100 ft. Dir: N  
Type: Distance: ft. Dir:

14. Pump: [ ] Not Installed [ ] Installation Only  
Manufacturer's Name: RED JACKET  
Model: 75CWS12BC HP: 0.75 Voltage: 230  
Drop pipe: 40 ft. Capacity: 12 GPM  
Pump type: SUBMERSIBLE  
Pressure Tank Manufacturer's Name : WELL X-TROL  
Model: 203 Capacity: 32 Gal.

WATER WELL CONTRACTOR'S CERTIFICATION:

This well was drilled under my jurisdiction and this report is true to the best of my knowledge and belief.  
Registered Bus. Name ADAMS WELL DRILLING, INC. 47-1861  
Business Address 1122 S. Hacker Road Brighton MI 48116

Signed Mark Adams 02/04/99  
Authorized Representative Date

Locate with 'X' in Sec. Below

Sketch Map

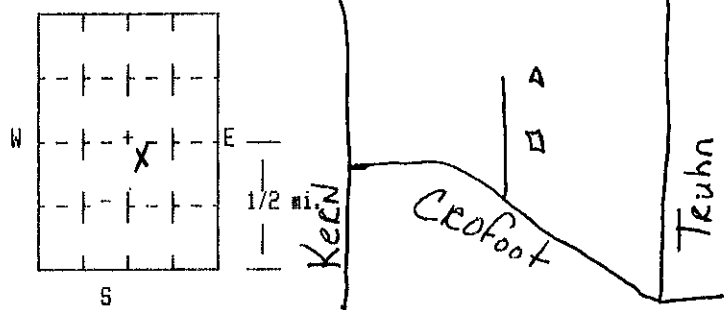

Formation Description

Thickness Depth

BROWN SANDY CLAY	4	4
BROWN CLAY	10	14
BROWN SAND GRAVEL	6	20
GRAY SAND GRAVEL	4	24
SANDY GRAY CLAY	42	66
GRAY SANDSTONE	3	69
LIMESTONE	330	72
GREEN SANDSTONE	2	74
GRAY SANDSTONE SOFT	7	81
GREEN SANDSTONE	7	88

**RECEIVED**

FEB 16 1999

LIV. CTY. HEALTH DEPT.

15. Abandoned Well Plugged? NO  
Casing Diameter in. Depth ft.  
Plugging Material:  
No. of Bags Casing Removed?

16. Remarks, elevation, source of data, etc.

17. Drilling Machine Operator: [X] Employee [ ] Subcontractor  
Name GREG ADAMS - JEFF COX

GW-2-228 9/93

Authority: Act 368 PA 1978  
Completion: Required  
Penalty: Conviction of a violation of any provision is a misdemeanor.

TAX NO:

PERMIT NO:  
98-1831NW

Page of  
1 1

1. LOCATION OF WELL

County LIVINGSTON Township Name IOSCO

Fraction NW 1/4 NW 1/4 SE 1/4

Section No  
1

Town No  
2 N

Range Number  
3 E

Distance And Direction From Road Intersection  
PARCEL 5

Well Addr: 6448 CROFOOT HOWELL MI 48843

3. Owner of Well MEDALLION HOMES  
Address 5800 HIGHLAND ROAD  
WHITE LAKE MI 48383  
Address Same as Well Location? NO

4. WELL DEPTH Date Compl This is a:  
94 ft. 02/11/99 NEW WELL

5. EQUIPMENT USED: ROTARY  
6. WELL USE: HOUSEHOLD

7. CASING Type: PLASTIC Connection: THREADED  
Diam. Height ABOVE  
5 in. to 71 ft. Surface 1 ft  
3 in. to 94 ft. Weight 1b./ft.  
Grouted Drill Hole Drive Shoe NO  
8.5 in. to 71 ft. Shale Packer NO  
4.5 in. to 94 ft.

8. Screen Type: SLOTTED Diam: 3 [ ] Not Inst.  
SLOT SHALE Length: 26  
Set Between 68 ft. and 94 ft.  
Fittings: K-PACKER [ ] Blank above scrn: ft

9. Static Level: 21'6" ft. Flow: [N]

10. Pumping Level below land surface:  
94 ft. after 1 hrs. @ 50 GPM  
[ ] Plunger [ ] Bailer [X] Air [ ] Test Pump

11. Well Head Completion: PITLESS ADAPTER

12. Grouted from 0 to 68 ft Material: BENTONITE  
Cement: 5 bags Additives: SUPERMUD

13. Nearest source of possible contamination:  
Type: SEPTIC TANK Distance: 100 ft. Dir: S  
Type: Distance: ft. Dir:

14. Pump: [ ] Not Installed [ ] Installation Only  
Manufacturer's Name: RED JACKET  
Model: 50CWS9BC HP: 0.5 Voltage: 230  
Drop pipe: 40 ft. Capacity: 10 GPM  
Pump type: SUBMERSIBLE  
Pressure Tank Manufacturer's Name: WELL X-TROL  
Model: 202 Capacity: 20 Gal.

WATER WELL CONTRACTOR'S CERTIFICATION:

This well was drilled under my jurisdiction and this report is true to the best of my knowledge and belief.  
Registered Bus. Name ADAMS WELL DRILLING, INC. 47-1861  
Business Address 1122 S. Hacker Road Brighton MI 48116

Signed Mark Adams 02/04/99  
Authorized Representative Date

Locate with 'X' in Sec. Below

Sketch Map

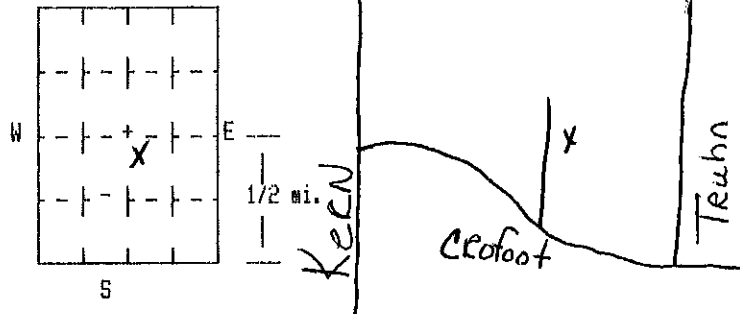

Formation Description

Thickness

Depth

SANDY BROWN CLAY	13	13
BROWN SAND	3	16
SANDY GRAY CLAY	2	18
GRAY CLAY	8	26
SANDY GRAY CLAY	11	37
GRAY SAND	11	48
SANDY GRAY CLAY	15	63
BLUE & GRAY SANDSTONE	4	67
LIMESTONE	7	74
GREEN SANDSTONE	10	84
GREEN & GRAY SOFT SANDSTONE	8	92
GRAY SANDSTONE	1	93
GREEN SHALE	1	94
LIMESTONE		

**RECEIVED**

FEB 16 1999

LIV. CTY. HEALTH DEPT.

15. Abandoned Well Plugged? NO

Casing Diameter in. Depth ft.

Plugging Material: \_\_\_\_\_

No. of Bags \_\_\_\_\_ Casing Removed? \_\_\_\_\_

16. Remarks, elevation, source of data, etc.

MAR 30 1999

17. Drilling Machine Operator: [X] Employee [ ] Subcontractor

Name GREG ADAMS - JEFF COX

GW-2-228 9/93

Authority: Act 368 PA 1978

Completion: Required

Penalty: Conviction of a violation of any provision is a misdemeanor.

MICHIGAN DEPARTMENT OF PUBLIC HEALTH  
WATER WELL AND PUMP RECORD

PERMIT NUMBER:

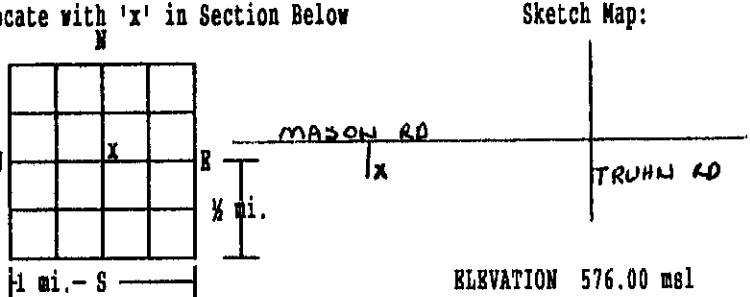
1 LOCATION OF WELL 47030201001		Tax Parcel No.			
County LIVINGSTON	Township Name IDSCO	Fraction SW 1/4 SW 1/4 NE 1/4	Section No. 01	Town No. 02 N	Range No. 03 E
Distance And Direction From Road Intersection 1 1/2 MI W OF TRUHN RD ON MASON RD S SIDE 6247 MASON RD, HOWELL 48843 Street Address & City of Well Location		3 OWNER OF WELL RUNYAN BRO S CONSTRUCT Address 6009 N LATSON RD HOWELL, MI 48843 Address Same As Well Location? <input type="checkbox"/> Yes <input checked="" type="checkbox"/> No			
Locate with 'x' in Section Below Sketch Map: 		4 WELL DEPTH: 120.0 ft. Date Completed 02/15/97 <input checked="" type="checkbox"/> New Well <input type="checkbox"/> Replacement Well			
		5 <input type="checkbox"/> Cable tool <input checked="" type="checkbox"/> Rotary <input type="checkbox"/> Driven <input type="checkbox"/> Dug <input type="checkbox"/> Hollow rod <input type="checkbox"/> Auger/Bored <input type="checkbox"/> Jetted			
		6 USE <input checked="" type="checkbox"/> Domestic <input type="checkbox"/> Type I Public <input type="checkbox"/> Type III Public <input type="checkbox"/> Irrigation <input type="checkbox"/> Type II Public <input type="checkbox"/> Heat Pump <input type="checkbox"/> Test Well <input type="checkbox"/> Type IIB Public			
		7 CASING: <input type="checkbox"/> Steel <input checked="" type="checkbox"/> Threaded <input type="checkbox"/> Height: Above <input checked="" type="checkbox"/> Plastic <input checked="" type="checkbox"/> Welded Surface 1.0 ft. Diameter 5.00 in. to 105.0 ft. depth Weight <sup>SPK</sup> lbs/ft. 0.00 in. to 0.0 ft. depth Grouted Drill Hole Diameter Drive Shoe <input type="checkbox"/> Yes 7.78 in. to 105.0 ft. depth <input checked="" type="checkbox"/> No 4.75 in. to 120.0 ft. depth			
2 FORMATION DESCRIPTION		THICKNESS OF STRATUM	DEPTH TO BOTTOM OF STRATUM		
CLAY		30.0	30.0		
CLAY & SAND		13.0	43.0		
CLAY		52.0	95.0		
SAND ROCK & GRAVEL		10.0	105.0		
OPEN HOLE		15.0	120.0		
		8 SCREEN <input checked="" type="checkbox"/> Not Installed Type Rock Well Diameter 0.00 SLOT 0.000 Length 0.0 Set between 0.00 ft. and 0.00 ft. FITTINGS: <input type="checkbox"/> K-Packer <input type="checkbox"/> Lead Packer <input type="checkbox"/> Bremmer Check <input type="checkbox"/> Blank above screen 0.0 ft. <input type="checkbox"/> Other			
		9 STATIC WATER LEVEL: 25.00 ft. below land surface <input type="checkbox"/> Flow			
		10 PUMPING LEVEL: below land surface 45 ft. after 2.0 hrs. pumping at 20 G.P.M. 0 ft. after 0.0 hrs. pumping at 0 G.P.M.			
		11 WELL HEAD COMPLETION: <input checked="" type="checkbox"/> Pitless adapter <input type="checkbox"/> 12" above grade <input type="checkbox"/> Basement offset <input type="checkbox"/> Approved pit			
		12 WELL GROUTED? <input type="checkbox"/> No <input checked="" type="checkbox"/> Yes From 0.0 to 105.0 ft. <input type="checkbox"/> Neat cement <input checked="" type="checkbox"/> Bentonite <input checked="" type="checkbox"/> Other BENSEAL No. of bags of cement 6 Additives E2 mud			
		13 Nearest source of possible contamination Type Septic Distance 75 ft. Direction S Well disinfected upon completion? <input checked="" type="checkbox"/> Yes <input type="checkbox"/> No Was old well plugged? <input type="checkbox"/> Yes <input type="checkbox"/> No			
		14 PUMP: <input type="checkbox"/> Not Installed <input type="checkbox"/> Pump Installation Only Manufacturer's name MYERS Model number HP 1 1/2 Volts Length of Drop Pipe 60 ft. Capacity 12 G.P.M. TYPE: <input checked="" type="checkbox"/> Submersible <input type="checkbox"/> Jet PRESSURE TANK: Manufacturers name CHAMPION Model number 4202 Capacity 30 Gallons 5.5			
15 Remarks, elevation, source of data, etc.  Data Source: MDNR		16 WATER WELL CONTRACTOR'S CERTIFICATION: This well was drilled under my jurisdiction and this report is true to the best of my knowledge and belief.  KLUESNER, PATRICK WELL DRIG 1854 REGISTERED BUSINESS NAME REGISTRATION NO. Address 4205 MUSSON ROAD HOWELL, MI 48843 Signed _____ Date 2/15/97 AUTHORIZED REPRESENTATIVE			
17 Rig Operator's Name: P/X					

MICHIGAN DEPARTMENT OF PUBLIC HEALTH  
WATER WELL AND PUMP RECORD

TAX NO:

PERMIT NO: 98-0505NW Page of 1 1

1. LOCATION OF WELL  
 County: LIVINGSTON Township Name: IOSCO Fraction: NE 1/4 SE 1/4 NE 1/4 Section No: 1 Town No: 2 N Range Number: 3 E

Distance And Direction From Road Intersection  
 Well Addr: 152 S. TRUHN HOWELL MI 48843

3. Owner of Well: CAL GILLET  
 Address: 2501 HUGHES HOWELL MI 48843  
 Address Same as Well Location? YES

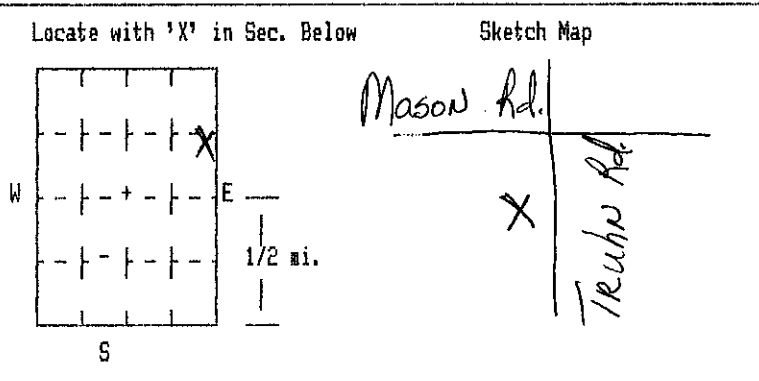

4. WELL DEPTH: 126 ft. Date Compl: 06/24/98 This is a: NEW WELL

5. EQUIPMENT USED: ROTARY  
 6. WELL USE: HOUSEHOLD

7. CASING Type: PLASTIC Connection: THREADED  
 Diam. 5 in. to 118 ft. Height ABOVE Surface 1 ft.  
 in. to ft. Weight 1b./ft.  
 Grouted Drill Hole 0.5 in. to 126 ft. Drive Shoe NO  
 in. to ft. Shale Packer NO

Formation Description	Thickness	Depth
TOP SPDIL SAND	3	3
SANDY BROWN CLAY	4	7
BROWN CLAY	4	11
BROWN SAND	2	13
BROWN SANDY CLAY	7	20
BROWN SAND	46	66
GRAY CLAY	18	84
GRAVELY GRAY CLAY & SANDSTONE	28	112
BLUE SHALE & SAND	14	126
SOLID SHALE		

8. Screen Type: S.S Diam: 3 [ ] Not Inst.  
 SLOT 7 Length: 8  
 Set Between 118 ft. and 126 ft.  
 Fittings: K-PACKER [ ] Blank above scrn: ft

9. Static Level: 45 ft. Flow: [N]

10. Pumping Level below land surface:  
 126 ft. after 1 hrs. @ 60 GPM  
 [ ] Plunger [ ] Bailer [X] Air [ ] Test Pump

11. Well Head Completion: PITLESS ADAPTER

12. Grouted from 0 to 115 ft Material: BENTONITE  
 Cement: 10 bags Additives: SUPERMUD

13. Nearest source of possible contamination:  
 Type: SEPTIC TANK Distance: 90 ft. Dir: W  
 Type: Distance: ft. Dir:

14. Pump: [ ] Not Installed [ ] Installation Only  
 Manufacturer's Name: RED JACKET  
 Model: 50CNSW1-9B HP: 0.5 Voltage: 230  
 Drop pipe: 60 ft. Capacity: 10 GPM  
 Pump type: SUBMERSIBLE  
 Pressure Tank Manufacturer's Name: WELL X-TROL  
 Model: 202 Capacity: 20 Gal.

15. Abandoned Well Plugged? NO  
 Casing Diameter in. Depth ft.  
 Plugging Material:  
 No. of Bags Casing Removed?

16. Remarks, elevation, source of data, etc.

17. Drilling Machine Operator: [X] Employee [ ] Subcontractor  
 Name GREG ADAMS \_ JEFF ABBOTT

GW-2-228 9/93  
 Authority: Act 368 PA 1978  
 Completion: Required  
 Penalty: Conviction of a violation of any provision is a misdemeanor.

WATER WELL CONTRACTOR'S CERTIFICATION:  
 This well was drilled under my jurisdiction and this report is true to the best of my knowledge and belief.  
 Registered Bus. Name ADAMS WELL DRILLING, INC. 47-1861  
 Business Address 1122 S. Hacker Road Brighton MI 48116  
 Signed Mark Adams 06/24/98  
 Authorized Representative Date

DEQ. PENNSYLVANIA DEPARTMENT OF ENVIRONMENTAL QUALITY  
 DRINKING WATER & RADIOLOGICAL PROTECTION DIVISION  
**WATER WELL AND PUMP RECORD**

Completion is required under authority of Part 127 Act 368 PA 1978  
 Failure to comply is a misdemeanor

TAX NO:

PERMIT NO:

1. LOCATION OF WELL  
 County Liv

Township Name 10560 Fraction SW 1/4 S 1/4 R 1/4 Section No. 1 Town No. T2N Range No. R3E

Distance and Direction from Road Intersection  
SOUTH OF MASON RD 1/2 MILE  
WEST OF TRUBN RD 400 FT

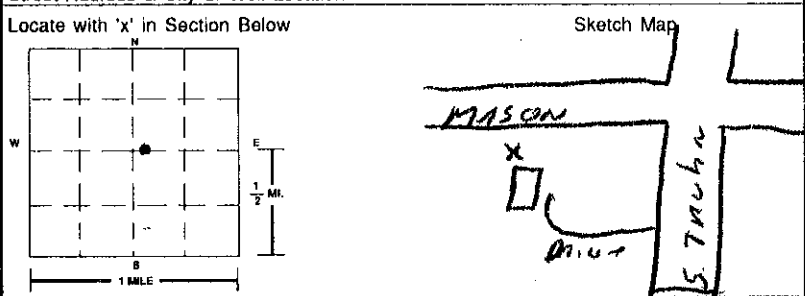

3. OWNER OF WELL  
 Address Mike Preble  
328 SOUTH TRUBN  
 Address Same as Well Location  Yes  No

4. WELL DEPTH: 118 ft. Date Completed Aug 19 1998  
 New Well  
 Replacement Well

5.  Cable Tool  Rotary  Driven  Dug  
 Hollow Rod  Auger/Bored  Jetted

6. USE:  Household  Type I Public  Type III Public  
 Irrigation  Type IIa Public  Heat Pump  
 Test Well  Type IIb Public

7. CASING:  Steel  Threaded  Plastic  Welded  
 Other  
 Height: Above Below Surface: 1 ft.  
 Diameter: 5 in. to 110 ft. depth  
 Weight: 2 lbs./ft.  
 BORE HOLE:  Drive Shoe  Shale Packer  
 Diameter: 2 1/2 in. to 110 ft. depth  
4 in. to 118 ft. depth

8. SCREEN:  Not Installed  Gravel-Packed  
 Type \_\_\_\_\_ Diameter \_\_\_\_\_  
 Slot/Gauze \_\_\_\_\_ Length: \_\_\_\_\_  
 Set Between \_\_\_\_\_ ft. and \_\_\_\_\_ ft.  
 FITTINGS:  K-Packer  Bremer Check  
 Blank Above Screen \_\_\_\_\_ ft. Other \_\_\_\_\_

9. STATIC WATER LEVEL:  
36 ft. Below Land Surface  Flowing

10. PUMPING LEVEL: Below Land Surface  
50 ft. After 2 hrs. Pumping at 40 G.P.M.  
 Plunger  Bailer  Air  Test Pump

11. WELL HEAD COMPLETION:  
 Pitless Adapter  12" Above Grade  
 Basement Offset  Well House

12. WELL GROUTED?  No  Yes From 0 to 110 ft.  
 Neat Cement  Bentonite  Other \_\_\_\_\_  
 No. of Bags 7 Additives Benzocel

13. NEAREST SOURCE OF POSSIBLE CONTAMINATION:  
 Type Syptic Distance 100 ft. Direction SE  
 Type \_\_\_\_\_ Distance \_\_\_\_\_ ft. Direction \_\_\_\_\_

14. PUMP:  Not Installed  Pump Installation Only  
 Manufacturer's Name Aeromaton  
 Model Number 712-50-B HP 1/2 Volts 230  
 Length of Drop Pipe 60 ft. Capacity 12 G.P.M.  
 TYPE:  Submersible  Jet  Other \_\_\_\_\_  
 PRESSURE TANK:  
 Manufacturer's Name Well x Tool  
 Model Number 203 Capacity 10 Gallons 10

2. FORMATION DESCRIPTION	THICKNESS OF STRATUM	DEPTH TO BOTTOM OF STRATUM
CLAY	16	16
SAND, GRAVELS	30	52
CLAY	48	90
SANDSTONE	28	118

**RECEIVED**  
 MAY 15 1998  
 LIV. CTY. HEALTH DEPT.  
 RECEIVED  
 PENNSYLVANIA DEPARTMENT OF ENVIRONMENTAL QUALITY  
 DIVISION OF DRINKING WATER & RADIOLOGICAL PROTECTION  
 JUN 15 1998  
 DIVISION OF DRINKING WATER & RADIOLOGICAL PROTECTION  
 USE A 2ND SHEET IF NEEDED

15. ABANDONED WELL PLUGGED?  Yes  No  
 Casing Diameter \_\_\_\_\_ in. Depth \_\_\_\_\_ ft.  
 PLUGGING MATERIAL:  Neat Cement  Bentonite Slurry  
 Cement/Bentonite Slurry  Concrete Grout  Bentonite Chips  
 No. of Bags \_\_\_\_\_ Casing Removed?  Yes  No

16. REMARKS: (Elevation, Source of Data, etc.)

17. DRILLING MACHINE OPERATOR:  
 Employee  Subcontractor  
 Name George

18. WATER WELL CONTRACTOR'S CERTIFICATION:  
 This well was drilled under my jurisdiction and this report is true to the best of my knowledge and belief.  
George  
 REGISTERED BUSINESS NAME \_\_\_\_\_ ADDRESS 7631 Lopez  
 Signed \_\_\_\_\_ Date May 11/98  
 AUTHORIZED REPRESENTATIVE REGISTRATION NO. 47-1833

TAX NO:

MICHIGAN DEPARTMENT OF ENVIRONMENTAL QUALITY  
WATER WELL AND PUMP RECORD

PERMIT NO:  
97-0454 NW

1. LOCATION OF WELL  
City/Town: **LIVINGSTON**

Township Name: **10000** Range No. **3E**  
Section No. **1** Township No. **21N**  
E 1/4 SW 1/4 SW 1/4

Distance and Direction from Road Intersection  
**1/2 MILE EAST OF KERN AND CROFOOT**

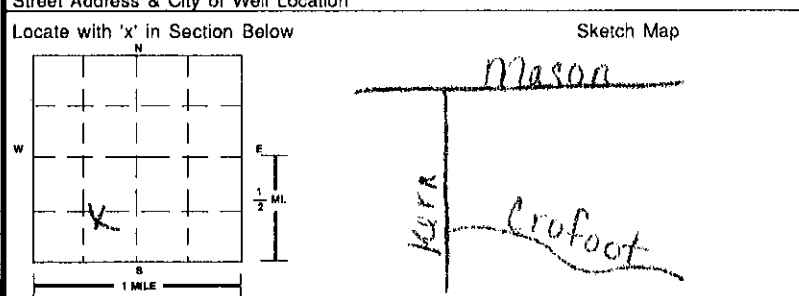

3. OWNER OF WELL: **LANNING, CHARLES**  
Address: **8432 DAYTES DRIVE BRIGHTON, MI. 48116**  
Address Same as Well Location  Yes  No

4. WELL DEPTH: **82** ft. Date Completed: **04/16/97**  
 New Well  Replacement Well

5.  Cable Tool  Rotary  Driven  Dug  
 Hollow Rod  Auger/Bored  Jetted

6. USE:  Household  Type I Public  Type III Public  
 Irrigation  Type IIa Public  Heat Pump  
 Test Well  Type IIb Public

7. CASING:  Steel  Threaded  Plastic  Welded  
 Other \_\_\_\_\_  
Diameter: \_\_\_\_\_ in. to \_\_\_\_\_ ft. depth  
Weight: **3** lbs./ft.  
BORE HOLE:  Drive Shoe  Shale Packer  
Diameter: **8** in. to **82** ft. depth

2. FORMATION DESCRIPTION	THICKNESS OF STRATUM	DEPTH TO BOTTOM OF STRATUM
BROWN CLAY	18	18
BROWN SAND	3	21
SOFT GRAY CLAY	6	27
BROWN SAND	23	50
SOFT GRAY CLAY	12	62
FINE GRAY SAND	12	74
GRAY SAND AND GRAVEL	8	82

8. SCREEN:  Not Installed  Gravel-Packed  
Type: **STAINLESS** Diameter: **4** in.  
Slot/Gauze: **12 & 15** Length: **8** ft.  
Set Between: **74** ft. and **82** ft.  
FITTINGS:  K-Packer  Bremer Check  
 Blank Above Screen **2** ft. Other: **PLUG**

9. STATIC WATER LEVEL: **40** ft. Below Land Surface  Flowing

10. PUMPING LEVEL: Below Land Surface **40** ft. After **2** hrs. Pumping at **30** G.P.M.  
 Plunger  Bailer  Air  Test Pump

11. WELL HEAD COMPLETION:  Pitless Adapter  12" Above Grade  
 Basement Offset  Well House

12. WELL GROUTED?  No  Yes From **0** to **70** ft.  
 Neat Cement  Bentonite  Other: **POLYMER**  
No. of Bags: **9** Additives

13. NEAREST SOURCE OF POSSIBLE CONTAMINATION:  
Type: **SEPTIC** Distance: **65** ft. Direction: **NO.**

15. ABANDONED WELL PLUGGED?  Yes  No  
Casing Diameter \_\_\_\_\_ in. Depth \_\_\_\_\_ ft.  
PLUGGING MATERIAL:  Neat Cement  Bentonite Slurry  
 Cement/Bentonite Slurry  Concrete Grout  Bentonite Chips  
No. of Bags \_\_\_\_\_ Casing Removed?  Yes  No

14. PUMP:  Not Installed  Pump Installation Only  
Manufacturer's Name: **RED JACKET**  
Model Number: **98C** HP: **1/2** Volts: **230**  
Length of Drop Pipe: **65** ft. Capacity: **10** G.P.M.  
TYPE:  Submersible  Jet  Other \_\_\_\_\_  
PRESSURE TANK:  
Manufacturer's Name: **CLAYTON MARK**  
Model Number: **8003** Capacity: **32** Gallons **10**

16. REMARKS: (Elevation, Source of Data, etc.)

17. DRILLING MACHINE OPERATOR:  
 Employee  Subcontractor  
Name: **BRIAN KELLER**

18. WATER WELL CONTRACTOR'S CERTIFICATION:  
This well was drilled under my jurisdiction and this report is true to the best of my knowledge and belief.  
**Keller Well Drilling Inc.** 1924  
REGISTERED BUSINESS NAME: **3788 Noble Brighton MI 48116** REGISTRATION NO.  
Address: \_\_\_\_\_  
Signed: **Dave Keller** Date: **6-3-97**  
AUTHORIZED REPRESENTATIVE

MICHIGAN DEPARTMENT OF PUBLIC HEALTH  
WATER WELL AND PUMP RECORD

PERMIT NUMBER:

LOCATION OF WELL 47027301001		Tax Parcel No.	
County LIVINGSTON	Township Name TOSCO	Fraction SW 1/4 SW 1/4 NE 1/4	Section No. 01 Town No. 02 N Range No. 03 E
Distance And Direction From Road Intersection 1/8M W ON MASON PAST TRUHN RD S SIDE 6225 MASON RD, HOWELL 48843 Street Address & City of Well Location		3 OWNER OF WELL RUNYAN BROTHERS Address 6009 LATSON CT HOWELL, MI 48843 Address Same As Well Location? <input type="checkbox"/> Yes <input checked="" type="checkbox"/> No	
Locate with 'x' in Section Below  ELEVATION 574.00 msl		4 WELL DEPTH: 120.0 ft. Date Completed 05/19/97 <input checked="" type="checkbox"/> New Well <input type="checkbox"/> Replacement Well	
FORMATION DESCRIPTION THICKNESS OF STRATUM DEPTH TO BOTTOM OF STRATUM		5 <input type="checkbox"/> Cable tool <input checked="" type="checkbox"/> Rotary <input type="checkbox"/> Driven <input type="checkbox"/> Dug <input type="checkbox"/> Hollow rod <input checked="" type="checkbox"/> Auger/Bored <input type="checkbox"/> Jetted	
		6 USE <input checked="" type="checkbox"/> Domestic <input type="checkbox"/> Type I Public <input type="checkbox"/> Type III Public <input type="checkbox"/> Irrigation <input type="checkbox"/> Type II Public <input type="checkbox"/> Heat Pump <input type="checkbox"/> Test Well <input type="checkbox"/> Type IIb Public	
CLAY 7.0 7.0		7 CASING: <input type="checkbox"/> Steel <input type="checkbox"/> Threaded <input checked="" type="checkbox"/> Welded Diameter 5.00 in. to 110.0 ft. depth 0.00 in. to 0.0 ft. depth Grouted Drill Hole Diameter 0.00 in. to 0.0 ft. depth 7.78 in. to 110.0 ft. depth Height: Above Surface 1.0 ft. Weight 3 lbs/ft. Drive Shoe <input type="checkbox"/> Yes <input checked="" type="checkbox"/> No	
SAND 7.0 28.0		8 SCREEN <input checked="" type="checkbox"/> Not Installed Type Rock Well Diameter 0.00 SLOT 0.000 Length 0.0 Set between 0.00 ft. and 0.00 ft. FITTINGS: <input checked="" type="checkbox"/> K-Packer <input type="checkbox"/> Lead Packer <input type="checkbox"/> Bremner Check <input type="checkbox"/> Blank above screen 0.0 ft. <input type="checkbox"/> Other	
CLAY 62.0 90.0		9 STATIC WATER LEVEL: 16.00 ft. below land surface <input type="checkbox"/> Flow	
SAND ROCK & GRAVEL 15.0 105.0		10 PUMPING LEVEL: below land surface 40 ft. after 2.0 hrs. pumping at 20 G.P.M. 0 ft. after 0.0 hrs. pumping at 0 G.P.M.	
SAND ROCK 15.0 120.0		11 WELL HEAD COMPLETION: <input checked="" type="checkbox"/> Pitless adapter <input type="checkbox"/> 12" above grade <input type="checkbox"/> Basement offset <input type="checkbox"/> Approved pit	
		12 WELL GROUTED? <input type="checkbox"/> No <input checked="" type="checkbox"/> Yes From 0.0 to 110.0 ft. <input type="checkbox"/> Neat cement <input checked="" type="checkbox"/> Bentonite <input checked="" type="checkbox"/> Other BENSEAL No. of bags of cement 6 Additives EZMA	
		13 Nearest source of possible contamination Type Septic Distance 75 ft. Direction N Well disinfected upon completion? <input checked="" type="checkbox"/> Yes <input type="checkbox"/> No Was old well plugged? <input checked="" type="checkbox"/> Yes <input type="checkbox"/> No	
		14 PUMP: <input type="checkbox"/> Not Installed <input type="checkbox"/> Pump Installation Only Manufacturer's name MYERS Model number HP 1/2 Volts Length of Drop Pipe 60 ft. Capacity 10 G.P.M. TYPE: <input checked="" type="checkbox"/> Submersible <input type="checkbox"/> Jet PRESSURE TANK: Champion Manufacturers name Model number 42-02 Capacity 5.5 Gallons 20	
15 Remarks, elevation, source of data, etc.  Data Source: MDNR		16 WATER WELL CONTRACTOR'S CERTIFICATION: This well was drilled under my jurisdiction and this report is true to the best of my knowledge and belief.  KLUBSNER, PATRICK WELL DRIG 1854 REGISTERED BUSINESS NAME REGISTRATION NO. Address 4205 MUSSON ROAD HOWELL, MI 48843 Signed  Date 5/24/97 AUTHORIZED REPRESENTATIVE	
17 Rig Operator's Name: PAT KLUBSNER			

MICHIGAN DEPARTMENT OF PUBLIC HEALTH  
WATER WELL AND PUMP RECORD

PERMIT NO: 97-1177NW Page of 1 1

TAX NO:  
1. LOCATION OF WELL  
County: LIVINGSTON Township Name: IOSCO

Fraction: NE 1/4 SE 1/4 NE 1/4  
Section No: 1  
Town No: 2 N  
Range Number: 3 E

Distance And Direction From Road Intersection  
Well Addr: 244 TRUHN MI

3. Owner of Well: ROSS PELLEGRINO  
Address: 11041 WYNNS DRIVE  
PINCKNEY MI 48169  
Address Same as Well Location? YES

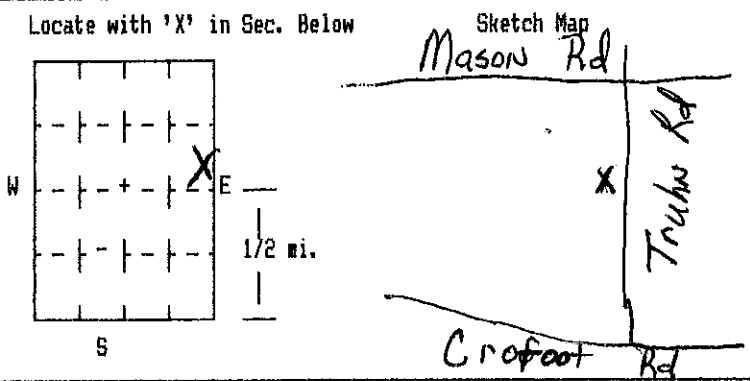

4. WELL DEPTH: 130 ft. Date Compl: 11/12/97 This is a: NEW WELL

5. EQUIPMENT USED: ROTARY  
6. WELL USE: HOUSEHOLD

Formation Description	Thickness	Depth
BROWN SANDY CLAY	12	12
SAND & GRAVEL ( BROWN )	28	40
GRAY SAND & GRAVEL	9	49
SANDY GRAY CLAY	3	52
GRAY CLAY	37	89
GRAVELY GRAY CLAY	23	112
GRAVELY CLAY & SANDSTONE	4	116
SOFT SANDSTONE	2	118
SANDSTONE (WHITE)	12	130
<b>RECEIVED</b>		
NOV 19 1997		
LIV. CTY. HEALTH DEPT.		

7. CASING Type: PLASTIC Connection: THREADED  
Diam. Height ABOVE  
5 in. to 118 ft. Surface 1 ft  
3 in. to 130 ft. Weight 1b./ft.  
Grouted Drill Hole Drive Shoe NO  
8.5 in. to 130 ft. Shale Packer NO  
4.5 in. to 130 ft.

8. Screen Type: SLOTTED Diam: 3 [ ] Not Inst.  
SLOT 3 Length: 12  
Set Between 118 ft. and 130 ft.  
Fittings: K-PACKER [ ] Blank above scrn: ft

9. Static Level: 30 ft. Flow: [N]

10. Pumping Level below land surface:  
130 ft. after 1 hrs. @ 75 GPM  
[ ] Plunger [ ] Bailer [X] Air [ ] Test Pump

11. Well Head Completion: PITLESS ADAPTER

12. Grouted from 0 to 118 ft Material: BENTONITE  
Cement: 7 bags Additives: 350 LBS

13. Nearest source of possible contamination:  
Type: SEPTIC TANK Distance: 100 ft. Dir: SW  
Type: Distance: ft. Dir:

15. Abandoned Well Plugged? NO  
Casing Diameter in. Depth ft.  
Plugging Material:  
No. of Bags: Casing Removed?

14. Pump: [ ] Not Installed [ ] Installation Only  
Manufacturer's Name: RED JACKET  
Model: 75CNSW1-12 HP: 0.75 Voltage: 230  
Drop pipe: 60 ft. Capacity: 10 GPM  
Pump type: SUBMERSIBLE  
Pressure Tank Manufacturer's Name : WELL X-TROL  
Model: 203 Capacity: 32 Gal.

16. Remarks, elevation, source of data, etc.

17. Drilling Machine Operator: [X] Employee [ ] Subcontractor  
Name: JIM ERWIN - KARL BOHN

WATER WELL CONTRACTOR'S CERTIFICATION:  
This well was drilled under my jurisdiction and this report is true to the best of my knowledge and belief.  
Registered Bus. Name: ADAMS WELL DRILLING, INC. 47-1861  
Business Address: 1122 S. Hacker Road Brighton MI 48116

GW-2-228 9/93  
Authority: Act 368 PA 1978  
Completion: Required  
Penalty: Conviction of a violation of any provision is a misdemeanor.

Signed: Mark Adams 11/12/97  
Authorized Representative Date

TAX NO:

MICHIGAN DEPARTMENT OF PUBLIC HEALTH  
WATER WELL AND PUMP RECORD

PERMIT NO:  
97-1189 NW

1. LOCATION OF WELL  
County **Livingston**

Township Name **Loaca** Fraction **SW 1/4** Section No. **1** Town No. **2 N** Range No. **3 E**

Distance and Direction from Road Intersection  
**344 Truhn Rd**  
Street Address & City of Well Location

3. OWNER OF WELL **Mary Blackburn (5 Star**  
Address **4825 Brophy**  
**Howell, MI 48836**  
Address Same as Well Location  Yes  No

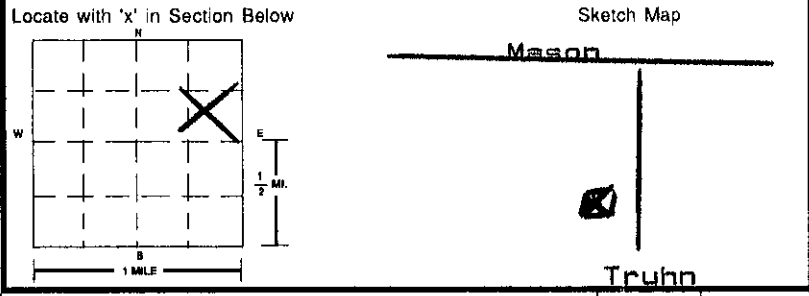

4. WELL DEPTH: **120** ft. Date Completed **10 / 16 97**  
 New Well  
 Replacement Well

2. FORMATION DESCRIPTION	THICKNESS OF STRATUM	DEPTH TO BOTTOM OF STRATUM
<b>Sand &amp; Clay</b>	<b>0</b>	<b>15</b>
<b>Clay</b>	<b>70</b>	<b>85</b>
<b>Sand Rock &amp; Shale</b>	<b>35</b>	<b>120</b>

5.  Cable Tool  Rotary  Driven  Dug  
 Hollow Rod  Auger/Bored  Jetted

8. SCREEN:  Not Installed  Gravel-Packed  
Type **N/A** Diameter \_\_\_\_\_  
Slot/Gauze \_\_\_\_\_ Length: \_\_\_\_\_  
Set Between \_\_\_\_\_ ft. and \_\_\_\_\_ ft.  
FITTINGS:  K-Packer  Bremer Check  
 Blank Above Screen \_\_\_\_\_ ft. Other \_\_\_\_\_

6. USE:  Household  Type I Public  Type III Public  
 Irrigation  Type IIa Public  Heat Pump  
 Test Well  Type IIb Public

7. CASING:  Steel  Threaded  Welded  
 Plastic  Other \_\_\_\_\_  
Height: Above/Below Surface: **1** ft  
Diameter: **4** in. to **90** ft. depth  
Weight: **44** lbs./ft.

BORE HOLE: \_\_\_\_\_ in. to \_\_\_\_\_ ft. depth  
Diameter: \_\_\_\_\_ in. to \_\_\_\_\_ ft. depth  
 Drive Shoe  
 Shale Packer

15. ABANDONED WELL PLUGGED?  Yes  No  
Casing Diameter \_\_\_\_\_ in. Depth \_\_\_\_\_ ft.  
PLUGGING MATERIAL:  Neat Cement  Bentonite Slurry  
 Cement/Bentonite Slurry  Concrete Grout  Bentonite Chips  
No. of Bags \_\_\_\_\_ Casing Removed?  Yes  No

9. STATIC WATER LEVEL: \_\_\_\_\_ ft. Below Land Surface  Flowing  
**45**

10. PUMPING LEVEL: Below Land Surface  
**80** ft. After **4** hrs. Pumping at **10+** G.P.M.  
 Plunger  Bailor  Air  Test Pump

11. WELL HEAD COMPLETION:  
 Pitless Adapter  12" Above Grade  
 Basement Offset  Well House

12. WELL GROUTED?  No  Yes From **top-bottom**  
 Neat Cement  Bentonite  Other \_\_\_\_\_  
No. of Bags **10** Additives \_\_\_\_\_

13. NEAREST SOURCE OF POSSIBLE CONTAMINATION:  
Type **septic** Distance **50+** ft. Direction **W**  
Type \_\_\_\_\_ Distance \_\_\_\_\_ ft. Direction \_\_\_\_\_

14. PUMP:  Not Installed  Pump Installation Only  
Manufacturer's Name **Red Jacket**  
Model Number **Ren** HP **1/2** Volts **220**  
Length of Drop Pipe **80** ft. Capacity **220** G.P.M.  
TYPE:  Submersible  Jet  Other \_\_\_\_\_  
PRESSURE TANK:  
Manufacturer's Name **Well Mate**  
Model Number **WMG** Capacity **42** Gallons

16. REMARKS: (Elevation, Source of Data, etc.)  
**Drillers Log**

17. DRILLING MACHINE OPERATOR:  
 Employee  Subcontractor  
Name **Chris McPeake**

15. WATER WELL CONTRACTOR'S CERTIFICATION:  
This well was drilled under my jurisdiction and this report is true to the best of my knowledge and belief.  
**JOHN H ROBERTS WELL DRILLING CO. INC 0027**  
REGISTERED BUSINESS NAME REGISTRATION NO.  
Address **2838 Pleasant Valley, Brighton 48116**  
Signed \_\_\_\_\_ Date **10-20-97**  
AUTHORIZED REPRESENTATIVE

GW-2-228 9/93

GEOLOGICAL SURVEY COPY

Authority: Act 388 PA 1978  
Completion: Required  
Penalty: Conviction of a violation of any provision is a misdemeanor.

TAX NO:

1. LOCATION OF WELL

County LIVINGSTON	Township Name TOSCO	Fraction SE 1/4 NE 1/4 NE 1/4	Section No 1	Town No 2 N	Range Number 3 E
----------------------	------------------------	----------------------------------	-----------------	----------------	---------------------

Distance And Direction From Road Intersection  
500' SOUTH OF MASON ON THE WEST SIDE OF TRUHN ROAD

Well Addr: 200 TRUHN ROAD

3. Owner of Well DONALD COLEMAN  
Address PO BOX 530215  
HARTLAND MI 48353  
Address Same as Well Location? NO

Locate with 'X' in Sec. Below

Sketch Map

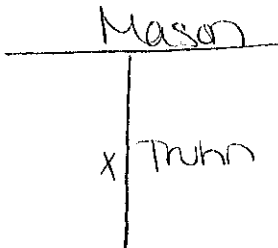
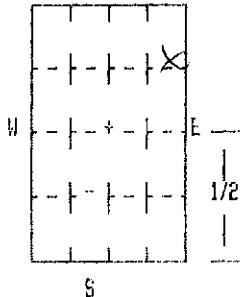

4. WELL DEPTH Date Compl This is a:  
148 ft. 11/13/97 NEW WELL

5. EQUIPMENT USED: ROTARY  
6. WELL USE: HOUSEHOLD

7. CASING Type: PLASTIC Connection: WELDED  
Diam. Height ABOVE  
5 in. to 138 ft. Surface 1 ft  
in. to ft. Weight 1b./ft.  
BORE HOLE: Drive Shoe NO  
8 1/2 in. to 148 ft. Shale Packer NO  
in. to ft.

Formation Description	Thickness	Depth
CLAY	20	20
SAND	25	45
CLAY	82	127
GRAVEL	21	148

8. Screen Type: SLOTTED Dian: 5 [ ] Not Inst.  
SLOT 20 Length: 10  
Set Between 138 ft. and 148 ft.  
Fittings: [ ] Blank above screen ft

9. Static Level: 50 ft. Flow: (N)

10. Pumping Level below land surface:  
140 ft. after 1 hrs. @ 40 GPM  
[ ] Plunger [ ] Bailer [X] Air [ ] Test Pump

11. Well Head Completion: PITLESS ADAPTER

12. Grouted from 130 to 0 ft Material: BENSEAL  
No. of Bags 12 bags Additives: SUPER MUD

13. Nearest source of possible contamination:  
Type: SEPTIC TANK Distance: 75 ft. Dir: WEST  
Type: Distance: ft. Dir:

14. Pump: [ ] Not Installed [ ] Installation Only  
Manufacturer's Name: RLD JISCLE  
Model: 50LNMHSC HP: 0.5 Voltage: 230  
Drop pipe: 80 ft. Capacity: 10 GPM  
Pump type: SUBMERSIBLE  
Pressure Tank Manufacturer's Name : WELL X-TRU  
Model: 203 Capacity: 10 Gal.

15. Abandoned Well Plugged? NO N/A  
Casing Diameter in. Depth  
Plugging Material:  
No. of Bags Casing Removed?

16. Remarks, elevation, source of water, etc.  
PUMP - JEFF BABINGER

17. Drilling Machine Operator: [X] Employee [ ] Subcontractor  
Name SCOTT GRIFFIN

RECEIVED

JAN 17 1998

LIV. CITY HEALTH DEPT.

MICH DEPT OF ENVIRONMENTAL QUALITY

FEB 04 1998

Drinking Water & Sanitization Protection Branch  
Ground Water Safety Section  
WELL CONSTRUCTION UNIT

WATER WELL CONTRACTOR'S CERTIFICATION:  
This well was drilled under my jurisdiction and this report is true to the best of my knowledge and belief.  
Registered Bus. Name ED BIRKMEIER WELL DRILLING LTD 1607  
Business Address 10555 Easton Road New Lothrop MI 48060

Signed: *Edward Birkenmeier* 11/25/97  
Authorized Representative Date

GW-2-228 9/93

Authority: Act 368 PA 1978  
Completion: Required  
Penalty: Conviction of a violation of any provision is a misdemeanor.

TAXNO:

MICHIGAN DEPARTMENT OF PUBLIC HEALTH  
WATER WELL AND PUMP RECORD

PERMIT NO:  
~~17259~~

1. LOCATION OF WELL  
County LIVINGSTON

Township Name IOSCO

Fraction SW 1/4 SW 1/4 NE 1/4

Section No. 1

Town No. T2N

Range No. R3E

Distance and Direction from Road Intersection 1/8 mile WEST ON MASON RD PAST TRUHN. SOUTH SIDE 2000' OFF ROAD.

Street Address & City of Well Location 6291 MASON RD

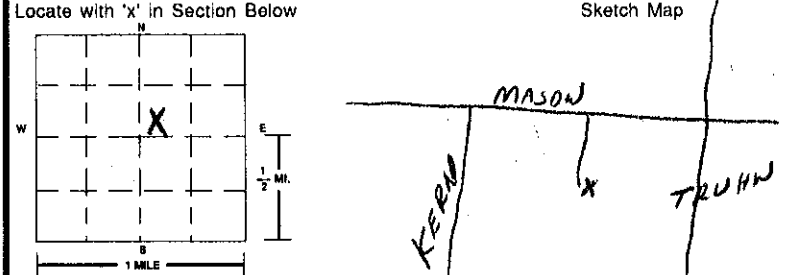

3. OWNER OF WELL TIM RUNYAN  
Address 6291 MASON RD  
Fowlerville, MI, 48836  
Address Same as Well Location  Yes  No

4. WELL DEPTH: 100 ft. Date Completed 8/18/95  
 New Well  
 Replacement Well

5.  Cable Tool  Rotary  Driven  Dug  
 Hollow Rod  Auger/Bored  Jetted

6. USE:  Household  Type I Public  Type III Public  
 Irrigation  Type IIa Public  Heat Pump  
 Test Well  Type IIb Public

7. CASING:  Steel  Threaded  Plastic  Welded  Other  
Height: Above/Below Surface: 1 ft.  
Diameter: 4 in. to 90 ft. depth Weight: 11 lbs./ft.  
BORE HOLE:  Drive Shoe  Shale Packer  
Diameter: \_\_\_\_\_ in. to \_\_\_\_\_ ft. depth

8. SCREEN:  Not Installed  Gravel-Packed  
Type ROCK HOLE Diameter \_\_\_\_\_  
Slot/Gauze \_\_\_\_\_ Length: \_\_\_\_\_  
Set Between \_\_\_\_\_ ft. and \_\_\_\_\_ ft.  
FITTINGS:  K-Packer  Bremer Check  
 Blank Above Screen \_\_\_\_\_ ft. Other \_\_\_\_\_

9. STATIC WATER LEVEL: 8 ft. Below Land Surface  Flowing

10. PUMPING LEVEL: Below Land Surface  
20 ft. After 2 hrs. Pumping at 20 G.P.M.  
 Plunger  Bailer  Air  Test Pump

11. WELL HEAD COMPLETION:  Flangeless Adapter  12" Above Grade  
 Basement Offset  Well House

12. WELL GROUTED?  No  Yes From \_\_\_\_\_ to \_\_\_\_\_ ft.  
 Neat Cement  Bentonite  Other \_\_\_\_\_  
No. of Bags 4 Additives BENDEAL

13. NEAREST SOURCE OF POSSIBLE CONTAMINATION:  
Type SEPTIC Distance 75 ft. Direction NW  
Type \_\_\_\_\_ Distance \_\_\_\_\_ ft. Direction \_\_\_\_\_

14. PUMP:  Not Installed  Pump Installation Only  
Manufacturer's Name MVECS  
Model Number 52EM HP 1/2 Volts 220  
Length of Drop Pipe 40 ft. Capacity 12 G.P.M.  
TYPE:  Submersible  Jet  Other \_\_\_\_\_  
PRESSURE TANK:  
Manufacturer's Name CHAMPION  
Model Number 42-02 Capacity 5.5 Gallons 20

2. FORMATION DESCRIPTION	THICKNESS OF STRATUM	DEPTH TO BOTTOM OF STRATUM
<u>YELLOW CLAY + SAND</u>	<u>10</u>	<u>10</u>
<u>GREY CLAY</u>	<u>43</u>	<u>53</u>
<u>GREY SAND (LITTLE WATER)</u>	<u>10</u>	<u>63</u>
<u>CLAY + GRAVEL</u>	<u>12</u>	<u>75</u>
<u>SANDSTONE (FRACTURED ROCK)</u>	<u>5</u>	<u>80</u>
<u>WHITE SANDSTONE</u>	<u>10</u>	<u>90</u>
<u>SANDSTONE (OPEN HOLE)</u>	<u>10</u>	<u>100</u>

RECEIVED  
Mich. Dept. of Public Health  
OCT 03 1995  
BUREAU OF ENVIRONMENTAL AND  
OCCUPATIONAL HEALTH-GWQS

15. ABANDONED WELL PLUGGED?  Yes  No  
Casing Diameter \_\_\_\_\_ in. Depth \_\_\_\_\_ ft.  
PLUGGING MATERIAL:  Neat Cement  Bentonite Slurry  
 Cement/Bentonite Slurry  Concrete Grout  Bentonite Chips  
No. of Bags \_\_\_\_\_ Casing Removed?  Yes  No

16. REMARKS: (Elevation; Source of Data, etc.)

17. DRILLING MACHINE OPERATOR:  
 Employee  Subcontractor  
Name ML

15. WATER WELL CONTRACTOR'S CERTIFICATION:  
This well was drilled under my jurisdiction and this report is true to the best of my knowledge and belief.  
PATRICK KLUESNER Well Drilling Inc 47-1354  
REGISTERED BUSINESS NAME REGISTRATION NO.  
Address 4205 MASON RD Howell 48843  
Signed \_\_\_\_\_ Date 8-22-95  
AUTHORIZED REPRESENTATIVE

TAX NO:

MICHIGAN DEPARTMENT OF PUBLIC HEALTH  
WATER WELL AND PUMP RECORD

PERMIT NO:

1. LOCATION OF WELL  
County Livingston

Township Name 10560 Fraction SE 1/4 SE 1/4 NW 1/4 Section No. 1 Town No. T24N Range No. R3E

Distance and Direction from Road Intersection  
1/2 mile West of Tawhn rd

3. OWNER OF WELL Don Kopp  
Address 354 S. Tawhn  
Address Same as Well Location  Yes  No

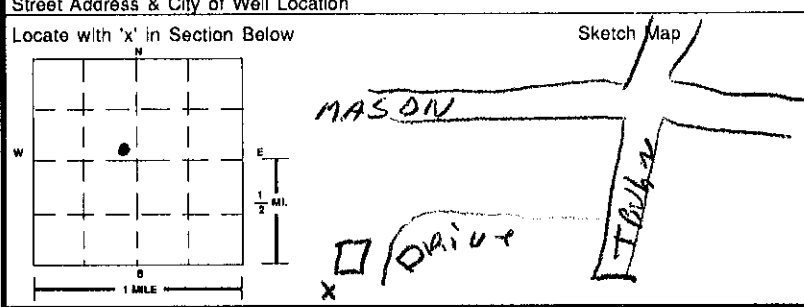

4. WELL DEPTH: 118 ft. Date Completed 2/4/94  
 New Well  Replacement Well  
5.  Cable Tool  Rotary  Driven  Dug  
 Hollow Rod  Auger/Bored  Jetted

2. FORMATION DESCRIPTION	THICKNESS OF STRATUM	DEPTH TO BOTTOM OF STRATUM
<u>SAND</u>	<u>11</u>	<u>11</u>
<u>CLAY</u>	<u>75</u>	<u>86</u>
<u>SANDSTONE</u>	<u>32</u>	<u>118</u>

6. USE:  Household  Type I Public  Type III Public  
 Irrigation  Type IIa Public  Heat Pump  
 Test Well  Type IIb Public   
7. CASING:  Steel  Threaded  Plastic  Welded  Other  
Height: Above/Below Surface: 1 ft.  
Diameter: 5 in. to 99 ft. depth Weight: 2 lbs./ft.  
BORE HOLE: Diameter: 8 3/4 in. to 99 ft. depth  
 Drive Shoe  Shale Packer

8. SCREEN:  Not Installed  Gravel-Packed  
Type \_\_\_\_\_ Diameter \_\_\_\_\_  
Slot/Gauze \_\_\_\_\_ Length: \_\_\_\_\_  
Set Between \_\_\_\_\_ ft. and \_\_\_\_\_ ft.  
FITTINGS:  K-Packer  Bremer Check  
 Blank Above Screen \_\_\_\_\_ ft. Other \_\_\_\_\_

9. STATIC WATER LEVEL: 31 ft. Below Land Surface  Flowing

10. PUMPING LEVEL: Below Land Surface  
40 ft. After 2 hrs. Pumping at 35 G.P.M.  
 Plunger  Bailor  Air  Test Pump

11. WELL HEAD COMPLETION:  
 Pitless Adapter  2" Above Grade  
 Basement Offset  Well House

12. WELL GROUTED?  No  Yes From 0 to 99 ft.  
 Neat Cement  Bentonite  Other \_\_\_\_\_  
No. of Bags \_\_\_\_\_ Additives QUIK LON T

13. NEAREST SOURCE OF POSSIBLE CONTAMINATION:  
Type Spring Distance 86 ft. Direction NE  
Type \_\_\_\_\_ Distance \_\_\_\_\_ ft. Direction \_\_\_\_\_

15. ABANDONED WELL PLUGGED?  Yes  No  
Casing Diameter \_\_\_\_\_ in. Depth \_\_\_\_\_ ft.  
PLUGGING MATERIAL:  Neat Cement  Bentonite Slurry  
 Cement/Bentonite Slurry  Concrete Grout  Bentonite Chips  
No. of Bags \_\_\_\_\_ Casing Removed?  Yes  No

14. PUMP:  Not Installed  Pump Installation Only  
Manufacturer's Name APPROMOTOR  
Model Number T12 HP 1/2 Volts 230  
Length of Drop Pipe 40 ft. Capacity 12 G.P.M.  
TYPE:  Submersible  Jet  Other \_\_\_\_\_  
PRESSURE TANK:  
Manufacturer's Name Well x Tank  
Model Number 203 Capacity 10 Gallons 10

16. REMARKS: (Elevation, Source of Data, etc.)

17. DRILLING MACHINE OPERATOR:  
 Employee  Subcontractor  
Name [Signature]

15. WATER WELL CONTRACTOR'S CERTIFICATION:  
This well was drilled under my jurisdiction and this report is true to the best of my knowledge and belief.  
Klauschmidt Drilling 47-1233  
REGISTERED BUSINESS NAME REGISTRATION NO.  
Address 7631 Dayton  
Signed [Signature] AUTHORIZED REPRESENTATIVE Date 2/3/94

MICHIGAN DEPARTMENT OF PUBLIC HEALTH  
WATER WELL AND PUMP RECORD

PERMIT NUMBER

1 LOCATION OF WELL

County **Livingston** Township Name **Iosco** Fraction **NW 1/4 NW 1/4 SW 1/4** Section Number **1** Town Number **2N N/S** Range Number **3E E/W**

Distance And Direction From Road Intersection  
**Approximately 1/4 mile east of Kern Road on the north side of Crofoot Road.**

Street Address & City of Well Location **Larry Jenks-owner 6720 Crofoot Road**

Locate with "X" in Section Below Sketch Map:

2 FORMATION DESCRIPTION

FORMATION DESCRIPTION	THICKNESS OF STRATUM	DEPTH TO BOTTOM OF STRATUM
Brown sand	30	30
Gray clay and gravel	75	105
Green and white sandstone	60	165

3 OWNER OF WELL:  
**Don DePriest**  
Address **5600 Otto Charlotte 48813**  
Address Same As Well Location?  Yes  No

4 WELL DEPTH: **165** FT. Date Completed **11 17 93** MO. DAY YEAR  New Well  Replacement Well

5  Cable tool  Rotary  Driven  Dug  
 Hollow rod  Auger  Jetted

6 USE:  Domestic  Type I Public  Type III Public  
 Irrigation  Type IIa Public  Heat pump  
 Test Well  Type IIb Public

7 CASING: Diameter  Steel  Threaded  Plastic  Welded  
**5** in. to **119** ft. depth Height: Above/Below Surface **1** ft.  
**8** in. to **119** ft. depth Weight **SDR21** lbs./ft.  
Grouted Drill Hole Diameter  8 in. to **119** ft. depth Drive Shoe  Yes  No

8 SCREEN:  Not Installed  
Type \_\_\_\_\_ Diameter \_\_\_\_\_  
Slot/Gauze \_\_\_\_\_ Length \_\_\_\_\_  
Set between \_\_\_\_\_ ft. and \_\_\_\_\_ ft.  
FITTINGS:  K-Packer  Lead Packer  Bremer Check  
 Blank above screen \_\_\_\_\_ ft. Other \_\_\_\_\_

9 STATIC WATER LEVEL: **33** ft. below land surface  Flow

10 PUMPING LEVEL: below land surface  
\_\_\_\_\_ ft. after **AIR** hrs. pumping at **100** G.P.M.  
\_\_\_\_\_ ft. after \_\_\_\_\_ hrs. pumping at \_\_\_\_\_ G.P.M.

11 WELL HEAD COMPLETION:  Pitless adapter  12" above grade  
 Basement offset  Approved pit

12 WELL GROUTED?  No  Yes From **0** to **119** ft.  
 Neat cement  Bentonite  Other \_\_\_\_\_  
No. of bags of cement \_\_\_\_\_ Additives \_\_\_\_\_

13 Nearest source of possible contamination  
Type **Septic tank** Distance **50+** ft. Direction **N**  
Well disinfected upon completion?  Yes  No  
Was old well plugged?  Yes  No

14 PUMP:  Not Installed  Pump Installation Only  
Manufacturer's name **Aermotor**  
Model number **T12502302** HP **1/2** Volts **230**  
Length of Drop Pipe **60** ft. capacity **12** G.P.M.  
TYPE:  Submersible  Jet  
PRESSURE TANK: Manufacturer's name **Well Xtrol**  
Model number **202** Capacity **6** Gallons

RECEIVED  
MICH. DEPT. OF PUBLIC HEALTH  
APR - 7 94  
BUREAU OF ENVIRONMENTAL  
AND OCCUPATIONAL HEALTH

RECEIVED  
MAY 28 1994  
LIVINGSTON COUNTY  
PUBLIC HEALTH DEPARTMENT

USE A 2ND SHEET IF NEEDED

15. Remarks, elevation, source of data, etc.

17. Rig Operator's Name:  
**Greg Mead, Ray**

16. WATER WELL CONTRACTOR'S CERTIFICATION:  
This well was drilled under my jurisdiction and this report is true to the best of my knowledge and belief.

**Dyer Well Drilling & Service, Inc. 0418**  
REGISTERED BUSINESS NAME REGISTRATION NO.  
Address **Laingsburg 48848-0370**  
Signed **Michael Dyer** Date **11-17-93**  
AUTHORIZED REPRESENTATIVE

TAX NO:

# MICHIGAN DEPARTMENT OF PUBLIC HEALTH WATER WELL AND PUMP RECORD

PERMIT NO:

1. LOCATION OF WELL

County

LIVINGSTON

Township Name

IOSCO

Fraction

SW 1/4 NW 1/4

Section No.

1

Town No.

2N

Range No.

2E

Distance and Direction from Road Intersection

Between MASON & Crofoot rd

Street Address & City of Well Location

Locate with 'x' in Section Below

Sketch Map

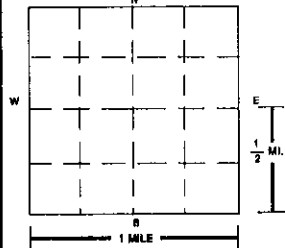

2. FORMATION DESCRIPTION

THICKNESS OF STRATUM

DEPTH TO BOTTOM OF STRATUM

<u>CLAY</u>	<u>7</u>	<u>7</u>
<u>SAND</u>	<u>8</u>	<u>15</u>
<u>CLAY &amp; GRAVEL</u>	<u>82</u>	<u>97</u>
<u>GRAVEL</u>	<u>22</u>	<u>119</u>
<u>Limestone &amp; Sandrock</u>	<u>18</u>	<u>137</u>

USE A 2ND SHEET IF NEEDED

15. ABANDONED WELL PLUGGED?

Yes  No

Casing Diameter \_\_\_\_\_ in. Depth \_\_\_\_\_ ft.

PLUGGING MATERIAL:

Neat Cement  Bentonite Slurry  
 Cement/Bentonite Slurry  Concrete Grout  Bentonite Chips  
 No. of Bags \_\_\_\_\_ Casing Removed?  Yes  No

16. REMARKS: (Elevation, Source of Data, etc.)

17. DRILLING MACHINE OPERATOR:

Employee  Subcontractor

Name Jim Fulmer

15. WATER WELL CONTRACTOR'S CERTIFICATION:

This well was drilled under my jurisdiction and this report is true to the best of my knowledge and belief.

Jim Fulmer W.D.  
REGISTERED BUSINESS NAME

0994  
REGISTRATION NO.

Address Fowlerville

Signed Jim Fulmer  
AUTHORIZED REPRESENTATIVE

Date 2-20-95

3. OWNER OF WELL

Address

DAVE WEBER  
283 KERN RD  
Fowlerville mi 48836  
Address Same as Well Location  Yes  No

4. WELL DEPTH:

Date Completed

New Well

137 ft. 2/20/95  Replacement Well

5.  Cable Tool

Rotary

Driven

Dug

Hollow Rod

Auger/Bored

Jetted

6. USE:

Household

Type I Public

Type III Public

Irrigation

Type IIa Public

Heat Pump

Test Well

Type IIb Public

7. CASING:

Steel

Threaded

Height: Above/Below

Plastic

Welded

Surface: 1 ft

Other

Diameter: 5 in. to 123 ft. depth

Weight: \_\_\_\_\_ lbs./ft.

BORE HOLE:

Diameter: 7 1/2 in. to 123 ft. depth

Drive Shoe

Shale Packer

8. SCREEN:

Not Installed

Gravel-Packed

Type \_\_\_\_\_ Diameter \_\_\_\_\_

Slot/Gauze \_\_\_\_\_ Length: \_\_\_\_\_

Set Between \_\_\_\_\_ ft. and \_\_\_\_\_ ft.

FITTINGS:  K-Packer

Bremer Check

Blank Above Screen \_\_\_\_\_ ft. Other \_\_\_\_\_

9. STATIC WATER LEVEL:

17 ft. Below Land Surface

Flowing

10. PUMPING LEVEL: Below Land Surface

50 ft. After 2 hrs. Pumping at 20 G.P.M.

Plunger

Bailer

Air

Test Pump

11. WELL HEAD COMPLETION:

Pitless Adapter

12" Above Grade

Basement Offset

Well House

12. WELL GROUTED?

No

Yes

From 0 to 123 ft.

Neat Cement

Bentonite

Other \_\_\_\_\_

No. of Bags 5 Additives \_\_\_\_\_

13. NEAREST SOURCE OF POSSIBLE CONTAMINATION:

Type SEPTIC Distance 100 ft. Direction E

Type \_\_\_\_\_ Distance \_\_\_\_\_ ft. Direction \_\_\_\_\_

14. PUMP:  Not Installed

Pump Installation Only

Manufacturer's Name Red JACKET

Model Number \_\_\_\_\_ HP 1/2 Volts 230

Length of Drop Pipe 60 ft. Capacity 12 G.P.M.

TYPE:  Submersible  Jet  Other \_\_\_\_\_

PRESSURE TANK:

Manufacturer's Name well-RITE

Model Number \_\_\_\_\_ Capacity \_\_\_\_\_ Gallons 30

MICHIGAN DEPARTMENT OF PUBLIC HEALTH  
**WATER WELL AND PUMP RECORD**

**PERMIT NUMBER**

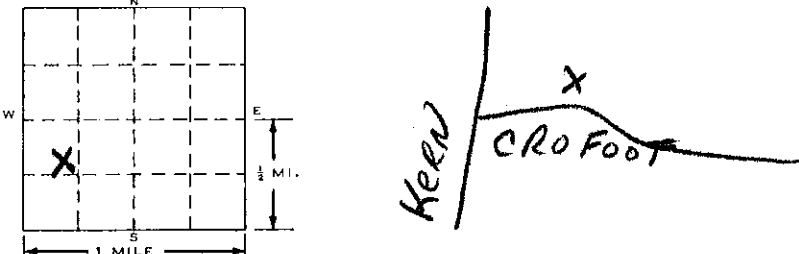
<b>1 LOCATION OF WELL</b>		County <b>LIVINGSTON</b>		Township Name <b>IOSCO</b>		Fraction <b>SE 1/4 NW 1/4 SW 1/4</b>		Section Number <b>1</b>		Town Number <b>200 NIS</b>		Range Number <b>3 E</b>	
Distance And Direction From Road Intersection <b>6996 CROFOOT</b>						3 OWNER OF WELL: <b>SEE BROWN CONST</b> Address _____ Address Same As Well Location? <input checked="" type="checkbox"/> Yes <input type="checkbox"/> No							
Street Address & City of Well Location Locate with "X" in Section Below						4 WELL DEPTH: <b>135</b> FT. Date Completed <b>11 14 93</b> <input checked="" type="checkbox"/> New Well <input type="checkbox"/> Replacement Well							
Sketch Map: 						5 <input type="checkbox"/> Cable tool <input checked="" type="checkbox"/> Rotary <input type="checkbox"/> Driven <input type="checkbox"/> Dug <input type="checkbox"/> Hollow rod <input type="checkbox"/> Auger <input type="checkbox"/> Jetted <input type="checkbox"/>							
2 FORMATION DESCRIPTION						6 USE: <input checked="" type="checkbox"/> Domestic <input type="checkbox"/> Type I Public <input type="checkbox"/> Type III Public <input type="checkbox"/> Irrigation <input type="checkbox"/> Type IIa Public <input type="checkbox"/> Heat pump <input type="checkbox"/> Test Well <input type="checkbox"/> Type IIb Public <input type="checkbox"/>							
						7 CASING: <input checked="" type="checkbox"/> Steel <input checked="" type="checkbox"/> Threaded <input type="checkbox"/> Plastic <input type="checkbox"/> Welded <b>4</b> in. to <b>116</b> ft. depth Height: Above/Below Surface <b>11</b> ft. <b>8</b> in. to <b>116</b> ft. depth Weight <b>1</b> lbs./ft. Graded Drill Hole Diameter _____ Drive Shoe <input checked="" type="checkbox"/> Yes <input type="checkbox"/> No							
						8 SCREEN: <input type="checkbox"/> Not Installed Type <b>NONE</b> Diameter _____ Slot/Gauze _____ Length _____ Set between _____ ft. and _____ ft. FITTINGS: <input type="checkbox"/> K-Packer <input type="checkbox"/> Lead Packer <input type="checkbox"/> Bremor Check <input type="checkbox"/> Blank above screen _____ ft. Other _____							
9 STATIC WATER LEVEL: <b>20</b> ft. below land surface <input type="checkbox"/> Flow						10 PUMPING LEVEL: below land surface <b>60</b> ft. after <b>3</b> hrs. pumping at <b>25</b> G.P.M. _____ ft. after _____ hrs. pumping at _____ G.P.M.							
11 WELL HEAD COMPLETION: <input checked="" type="checkbox"/> Pitless adapter <input type="checkbox"/> 12" above grade <input type="checkbox"/> Basement offset <input type="checkbox"/> Approved pit						12 WELL GROUTED? <input type="checkbox"/> No <input checked="" type="checkbox"/> Yes From <b>top</b> to <b>116'</b> <input type="checkbox"/> Neat cement <input type="checkbox"/> Bentonite <input type="checkbox"/> Other <b>BEUSEAL</b> No. of bags of cement _____ Additives <b>4 BAGS</b>							
13 Nearest source of possible contamination Type <b>septic</b> Distance <b>75</b> ft. Direction <b>SE</b> Well disinfected upon completion? <input checked="" type="checkbox"/> Yes <input type="checkbox"/> No Was old well plugged? <input type="checkbox"/> Yes <input type="checkbox"/> No						14 PUMP: <input type="checkbox"/> Not Installed <input type="checkbox"/> Pump Installation Only Manufacturer's name <b>MYERS</b> Model number _____ HP <b>1/2</b> Volts <b>230</b> Length of Drop Pipe <b>65</b> ft. capacity _____ G.P.M. TYPE: <input checked="" type="checkbox"/> Submersible <input type="checkbox"/> Jet PRESSURE TANK: <b>#02 well Rite</b> Manufacturer's name _____ Model number _____ Capacity _____ Gallons							
15. Remarks, elevation, source of data, etc.						16. WATER WELL CONTRACTOR'S CERTIFICATION: This well was drilled under my jurisdiction and this report is true to the best of my knowledge and belief. <b>BRIGHTON DRILLING #687</b> REGISTERED BUSINESS NAME REGISTRATION NO. _____ Address <b>2800 PLEASANT VALLEY</b> Signed <b>C. J. [Signature]</b> Date <b>11-23-93</b> AUTHORIZED REPRESENTATIVE							
17. Rig Operator's Name: _____													

RECEIVED  
 MICH. DEPT. OF PUB. HEALTH  
 OCT - 7 - 94  
 DIVISION OF ENVIRONMENTAL  
 AND OCCUPATIONAL HEALTH

USE A 2ND SHEET IF NEEDED

Authority: Act 368 PA 1978  
 Completion: Required  
 Penalty: Conviction of a violation of any provision is a misdemeanor.

WATER WELL AND PUMP RECORD

91204 PERMIT NUMBER

# 1 LOCATION OF WELL

County <u>LIV</u>	Township Name <u>TOSCO</u>	Fraction <u>N 1/4 SE 1/4 SW 1/4</u>	Section Number <u>1</u>	Town Number <u>T2N N1S</u>	Range Number <u>R3E E/W</u>
----------------------	-------------------------------	--	----------------------------	-------------------------------	--------------------------------

Distance And Direction From Road Intersection  
1/8 mile EAST OF CROFOOT SOUTH SIDE

Street Address & City of Well Location

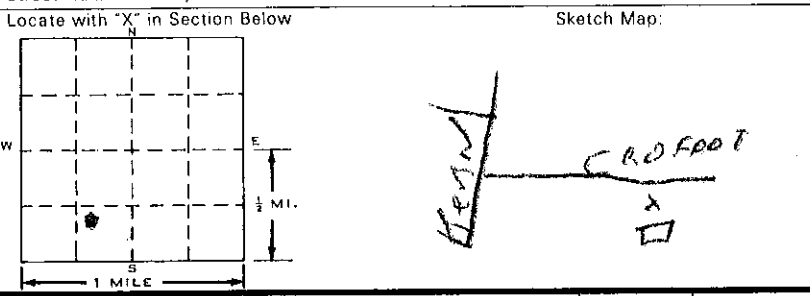

3 OWNER OF WELL: Tim Parks

Address 6711 CROFOOT

Address Same As Well Location?  Yes  No

4 WELL DEPTH: 100 FT. Date Completed JUL 10 1991

New Well  Replacement Well

5  Cable tool  Rotary  Driven  Dug

Hollow rod  Auger  Jetted

6 USE:  Domestic  Type I Public  Type III Public

Irrigation  Type IIa Public  Heat pump

Test Well  Type IIb Public

7 CASING: Diameter  Steel  Threaded  Plastic  Welded

Height: Above/Below

Surface 1 ft. Weight 2 lbs./ft.

Drive Shoe  Yes  No

8 SCREEN:  Not Installed

Type \_\_\_\_\_ Diameter \_\_\_\_\_

Slot/Gauze \_\_\_\_\_ Length \_\_\_\_\_

Set between \_\_\_\_\_ ft. and \_\_\_\_\_ ft.

FITTINGS:  K-Packer  Lead Packer  Bremer Check

Blank above screen \_\_\_\_\_ ft. Other \_\_\_\_\_

9 STATIC WATER LEVEL: 32 ft. below land surface  Flow

10 PUMPING LEVEL: below land surface

49 ft. after 2 hrs. pumping at 20 G.P.M.

\_\_\_\_\_ ft. after \_\_\_\_\_ hrs. pumping at \_\_\_\_\_ G.P.M.

11 WELL HEAD COMPLETION:  Pitless adapter  12" above grade

Basement offset  Approved pit

12 WELL GROUTED?  No  Yes From \_\_\_\_\_ to \_\_\_\_\_ ft.

Neat cement  Bentonite  Other \_\_\_\_\_

No. of bags of cement \_\_\_\_\_ Additives \_\_\_\_\_

13 Nearest source of possible contamination

Type SEWER Distance 70 ft. Direction S

Well disinfected upon completion?  Yes  No

Was old well plugged?  Yes  No

14 PUMP:  Not Installed  Pump Installation Only

Manufacturer's name Aeromotion

Model number A12-500 HP 1/2 Volts 220

Length of Drop Pipe 70 ft. capacity 12 G.P.M.

TYPE:  Submersible  Jet

PRESSURE TANK: Manufacturer's name Wellcraft

Model number 203 Capacity 11 Gallons

2 FORMATION DESCRIPTION	THICKNESS OF STRATUM	DEPTH TO BOTTOM OF STRATUM
<u>Brown clay</u>	<u>21</u>	<u>21</u>
<u>Grey clay</u>	<u>48</u>	<u>69</u>
<u>CRACKS</u>	<u>8</u>	<u>77</u>
<u>Grey clay</u>	<u>31</u>	<u>108</u>
<u>hard stone</u>	<u>52</u>	<u>160</u>

15. Remarks, elevation, source of data, etc.

**RECEIVED**  
Mich. Dept. of Public Health  
JUL 2 1991

17. Rig Operator's Name: [Signature]

16. WATER WELL CONTRACTOR'S CERTIFICATION:

This well was drilled under my jurisdiction and this report is true to the best of my knowledge and belief.

[Signature] REGISTERED BUSINESS NAME 47-1833 REGISTRATION NO.

Address 7631 [unclear]

Signed [Signature] Date June 1991

AUTHORIZED REPRESENTATIVE

**WATER WELL AND PUMP RECORD**

90-1552(N)  
PERMIT NUMBER

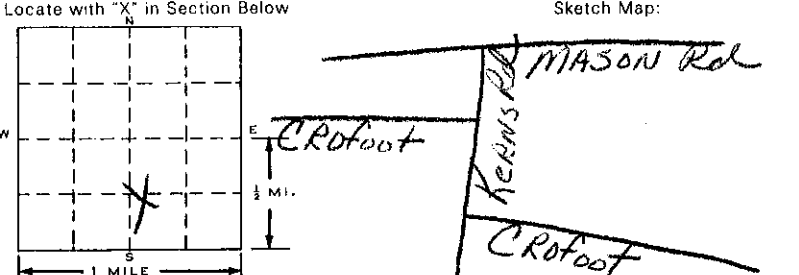
<b>1 LOCATION OF WELL</b>		<b>3 OWNER OF WELL:</b>	
County <u>Livingston</u>	Township Name <u>Tosco</u>	Section Number <u>1</u>	Range Number <u>2 N 3 E 10</u>
Distance And Direction From Road Intersection  <u>Parcel J Crofoot Rd</u>		Address <u>7600 E. GRAND RIVER BRIGHTON, MI. 48114</u>	
Street Address & City of Well Location <u><del>Crofoot Rd</del></u>		Address Same As Well Location? <input type="checkbox"/> Yes <input checked="" type="checkbox"/> No	
Locate with "X" in Section Below  		4 WELL DEPTH: Date Completed <u>90 FT.</u> <u>11 28 90</u> <input checked="" type="checkbox"/> New Well <input type="checkbox"/> Replacement Well	
		5 <input type="checkbox"/> Cable tool <input checked="" type="checkbox"/> Rotary <input type="checkbox"/> Driven <input type="checkbox"/> Dug <input type="checkbox"/> Hollow rod <input type="checkbox"/> Auger <input type="checkbox"/> Jetted	
		6 USE: <input checked="" type="checkbox"/> Domestic <input type="checkbox"/> Type I Public <input type="checkbox"/> Type III Public <input type="checkbox"/> Irrigation <input type="checkbox"/> Type IIa Public <input type="checkbox"/> Heat pump <input type="checkbox"/> Test Well <input type="checkbox"/> Type IIb Public	
		7 CASING: Diameter <input type="checkbox"/> Steel <input type="checkbox"/> Threaded <input checked="" type="checkbox"/> Plastic <input type="checkbox"/> Welded Height: Above/Below <u>5</u> in. to <u>86</u> ft. depth Surface <u>1</u> ft. <u>8 1/2</u> in. to <u>90</u> ft. depth Weight: _____ lbs./ft. Grouted Drill Hole Diameter <u>8 1/2</u> in. to <u>90</u> ft. depth Drive Shoe <input type="checkbox"/> Yes <input checked="" type="checkbox"/> No	
<b>2 FORMATION DESCRIPTION</b>		8 SCREEN: <input type="checkbox"/> Not Installed Type <u>JOHNSON</u> Diameter <u>3"</u> Slot/Gauge <u>12</u> Length <u>4'</u> Set between <u>86</u> ft. and <u>90</u> ft.	
		FITTINGS: <input checked="" type="checkbox"/> K-Packer <input type="checkbox"/> Lead Packer <input type="checkbox"/> Bremer Check <input checked="" type="checkbox"/> Blank above screen <u>2</u> ft. Other _____	
		9 STATIC WATER LEVEL: <u>52</u> ft. below land surface <input type="checkbox"/> Flow	
		10 PUMPING LEVEL: below land surface _____ ft. after _____ hrs. pumping at <u>35 AIR</u> G.P.M. _____ ft. after _____ hrs. pumping at _____ G.P.M.	
		11 WELL HEAD COMPLETION: <input checked="" type="checkbox"/> Pitless adapter <input checked="" type="checkbox"/> 12" above grade <input type="checkbox"/> Basement offset <input type="checkbox"/> Approved pit	
		12 WELL GROUTED? <input type="checkbox"/> No <input checked="" type="checkbox"/> Yes From <u>0</u> to <u>70</u> ft. <input type="checkbox"/> Neat cement <input type="checkbox"/> Bentonite <input type="checkbox"/> Other No. of bags of cement <u>200</u> Additives <u>QUICK SET + SAND</u>	
		13 Nearest source of possible contamination Type <u>SEPTIC</u> Distance <u>75</u> ft. Direction <u>S.</u> Well disinfected upon completion? <input checked="" type="checkbox"/> Yes <input type="checkbox"/> No Was old well plugged? <input type="checkbox"/> Yes <input type="checkbox"/> No	
		14 PUMP: <input type="checkbox"/> Not Installed <input type="checkbox"/> Pump Installation Only Manufacturer's name <u>MYERS</u> Model number <u>525503511P 72</u> Volts <u>230</u> Length of Drop Pipe <u>70</u> ft. capacity <u>11</u> G.P.M. TYPE: <input checked="" type="checkbox"/> Submersible <input type="checkbox"/> Jet PRESSURE TANK: Manufacturer's name <u>WELL X TROL</u> Model number <u>202</u> Capacity <u>4 1/2</u> Gallons	
15. Remarks, elevation, source of data, etc.		16. WATER WELL CONTRACTOR'S CERTIFICATION: This well was drilled under my jurisdiction and this report is true to the best of my knowledge and belief. <u>Adams Well Drilling, Inc. 47-1580</u> REGISTERED BUSINESS NAME Address <u>1122 S. HACKER BRIGHTON</u> SIGNED <u>Daniel Adams</u> Date <u>12-4-90</u> AUTHORIZED REPRESENTATIVE	
17. Rig Operator's Name: <u>DAN ADAMS</u>			

**RECEIVED**  
Mich. Dept. of Public Health

JAN 8 1991

BUREAU OF ENVIRONMENTAL AND OCCUPATIONAL HEALTH GWOS

# MICHIGAN DEPARTMENT OF PUBLIC HEALTH WATER WELL AND PUMP RECORD

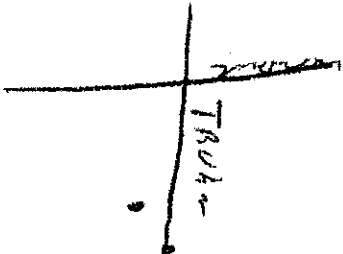
<b>1 LOCATION OF WELL</b>			County <u>Liv</u>			Township Name <u>Iosco</u>			Fraction <u>NE 1/4 Sec 14 N 1/4</u>			Section Number <u>1</u>			Town Number <u>T2N N/S</u>			Range Number <u>R36 E/W</u>		
Distance And Direction From Road Intersection <u>3/4 mile south to road and well in 70' x 15' db road</u>						3 OWNER OF WELL: <u>Jim Eagle</u> Address <u>320 Truitt</u> Address Same As Well Location? <input checked="" type="checkbox"/> Yes <input type="checkbox"/> No						4 WELL DEPTH: <u>63</u> FT. Date Completed <u>Nov 1 88</u> <input checked="" type="checkbox"/> New Well <input type="checkbox"/> Replacement Well								
Street Address & City of Well Location Locate with "X" in Section Below						Sketch Map: 						5 <input checked="" type="checkbox"/> Cable tool <input type="checkbox"/> Rotary <input type="checkbox"/> Driven <input type="checkbox"/> Dug <input type="checkbox"/> Hollow rod <input type="checkbox"/> Auger <input type="checkbox"/> Jetted								
2 FORMATION DESCRIPTION						6 USE: <input checked="" type="checkbox"/> Domestic <input type="checkbox"/> Type I Public <input type="checkbox"/> Type III Public <input type="checkbox"/> Irrigation <input type="checkbox"/> Type IIa Public <input type="checkbox"/> Heat pump <input type="checkbox"/> Test Well <input type="checkbox"/> Type IIb Public						7 CASING: Diameter <u>4</u> in. to <u>59</u> ft. depth <input checked="" type="checkbox"/> Steel <input type="checkbox"/> Plastic <input checked="" type="checkbox"/> Threaded <input type="checkbox"/> Welded Height: <u>Above</u> Below Surface <u>1</u> ft. Weight <u>1050</u> lbs./ft. Grouted Drill Hole Diameter _____ in. to _____ ft. depth Drive Shoe <input checked="" type="checkbox"/> Yes <input type="checkbox"/> No								
						THICKNESS OF STRATUM						8 SCREEN: <input type="checkbox"/> Not Installed Type <u>STAINLESS</u> Diameter <u>4"</u> Slot/Gauze <u>15</u> Length <u>4"</u> Set between <u>59</u> ft. and <u>63</u> ft. FITTINGS: <input checked="" type="checkbox"/> K-Packer <input type="checkbox"/> Lead Packer <input type="checkbox"/> Bremer Check <input checked="" type="checkbox"/> Blank above screen <u>1</u> ft. Other _____								
						DEPTH TO BOTTOM OF STRATUM						9 STATIC WATER LEVEL: <u>45</u> ft. below land surface <input type="checkbox"/> Flow								
						Brown clay						10 PUMPING LEVEL: below land surface <u>49</u> ft. after <u>2</u> hrs. pumping at <u>15</u> G.P.M. _____ ft. after _____ hrs. pumping at _____ G.P.M.								
						clay & gravel						11 WELL HEAD COMPLETION: <input checked="" type="checkbox"/> Pitless adapter <input checked="" type="checkbox"/> 12" above grade <input type="checkbox"/> Basement offset <input type="checkbox"/> Approved pit								
Crown						12 WELL GROUTED? <input type="checkbox"/> No <input type="checkbox"/> Yes From _____ to _____ ft. <input type="checkbox"/> Neat cement <input type="checkbox"/> Bentonite <input type="checkbox"/> Other _____ No. of bags of cement _____ Additives _____														
Sand & Crown						13 Nearest source of possible contamination Type <u>Septic</u> Distance <u>84</u> ft. Direction <u>South</u> Well disinfected upon completion? <input checked="" type="checkbox"/> Yes <input type="checkbox"/> No Was old well plugged? <input type="checkbox"/> Yes <input type="checkbox"/> No														
15. Remarks, elevation, source of data, etc.						14 PUMP: <input type="checkbox"/> Not installed <input type="checkbox"/> Pump Installation Only Manufacturer's name <u>McDonald</u> Model number <u>21050-112</u> HP <u>1/2</u> Volts <u>230</u> Length of Drop Pipe <u>50</u> ft. capacity <u>10</u> G.P.M. TYPE: <input checked="" type="checkbox"/> Submersible <input type="checkbox"/> Jet PRESSURE TANK: Manufacturer's name <u>Well &amp; Tool</u> Model number <u>203</u> Capacity <u>11</u> Gallons														
						16. WATER WELL CONTRACTOR'S CERTIFICATION: This well was drilled under my jurisdiction and this report is true to the best of my knowledge and belief. <u>Richard G. Dale</u> <u>417-1833</u> REGISTERED BUSINESS NAME REGISTRATION NO.														
						17. Rig Operator's Name: <u>Jim</u> Address <u>7631 Sargent</u> Signed <u>J. Fox</u> Date <u>Nov 22/88</u> AUTHORIZED REPRESENTATIVE														

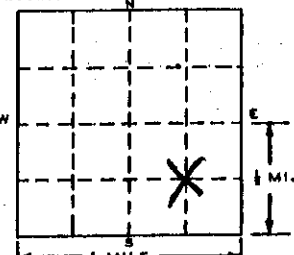

<b>1 LOCATION OF WELL</b>		County: <u>Livingston</u>		Township Name: <u>Iosco</u>		Fraction: <u>1/4</u> <u>1/4</u> <u>1/4</u>		Section Number: <u>1</u>		Town Number: <u>2</u> <u>N</u>		Range Number: <u>3</u> <u>E</u>	
Distance And Direction From Road Intersection <u>3/4 mile East of Kern rd. + 60' North of Crofoot rd.</u>						3 OWNER OF WELL: Denise Keller Address <u>6400 Crowfoot rd Howell mi.</u> Address Same As Well Location? <input checked="" type="checkbox"/> Yes <input type="checkbox"/> No							
Street Address & City of Well Location						4 WELL DEPTH: <u>112</u> FT. Date Completed MO. <u>5</u> DAY <u>6</u> YEAR <u>88</u> <input type="checkbox"/> New Well <input checked="" type="checkbox"/> Replacement Well							
Locate with "X" in Section Below						5 <input type="checkbox"/> Cable tool <input checked="" type="checkbox"/> Rotary <input type="checkbox"/> Driven <input type="checkbox"/> Dug <input type="checkbox"/> Hollow rod <input type="checkbox"/> Auger <input type="checkbox"/> Jetted							
Sketch Map: 						6 USE: <input checked="" type="checkbox"/> Domestic <input type="checkbox"/> Type I Public <input type="checkbox"/> Type III Public <input type="checkbox"/> Irrigation <input type="checkbox"/> Type IIa Public <input type="checkbox"/> Heat pump <input type="checkbox"/> Test Well <input type="checkbox"/> Type IIb Public							
2 FORMATION DESCRIPTION						THICKNESS OF STRATUM		DEPTH TO BOTTOM OF STRATUM		7 CASING: Diameter <input type="checkbox"/> Steel <input type="checkbox"/> Threaded <input checked="" type="checkbox"/> Plastic <input type="checkbox"/> Welded <u>5</u> in. to <u>68</u> ft. depth Height: Above/Below Surface <u>18"</u> ft. <u>8</u> in. to <u>68</u> ft. depth Weight <u>SOR</u> lbs./ft. Grouted Drill Hole Diameter <u>2</u> in. to <u>68</u> ft. depth Drive Shoe <input type="checkbox"/> Yes <input type="checkbox"/> No <u>8</u> in. to <u>68</u> ft. depth			
						<u>21</u>		<u>21</u>		8 SCREEN: <input type="checkbox"/> Not Installed Type _____ Diameter _____ Slot/Gauze _____ Length _____ Set between _____ ft. and _____ ft. FITTINGS: <input type="checkbox"/> K-Packer <input type="checkbox"/> Lead Packer <input type="checkbox"/> Bremer Check <input type="checkbox"/> Blank above screen _____ ft. Other _____			
						<u>7</u>		<u>28</u>		9 STATIC WATER LEVEL: <u>21'</u> ft. below land surface <input type="checkbox"/> Flow			
						<u>37</u>		<u>65</u>		10 PUMPING LEVEL: below land surface <u>Air 50</u> _____ ft. after _____ hrs. pumping at _____ G.P.M. _____ ft. after _____ hrs. pumping at _____ G.P.M.			
<u>Sand</u>						<u>47</u>		<u>112</u>		11 WELL HEAD COMPLETION: <input checked="" type="checkbox"/> Pitless adapter <input checked="" type="checkbox"/> 12" above grade <input type="checkbox"/> Basement offset <input type="checkbox"/> Approved pit			
<u>Gravel</u>										12 WELL GROUTED? <input type="checkbox"/> No <input checked="" type="checkbox"/> Yes From <u>0</u> to <u>68</u> ft. <input type="checkbox"/> Neat cement <input checked="" type="checkbox"/> Bentonite <input type="checkbox"/> Other _____ No. of bags of cement _____ Additives _____			
<u>Clay</u>										13 Nearest source of possible contamination Type <u>Septic</u> Distance <u>75'</u> ft. Direction <u>West</u> Well disinfected upon completion? <input checked="" type="checkbox"/> Yes <input type="checkbox"/> No Was old well plugged? <input type="checkbox"/> Yes <input checked="" type="checkbox"/> No <u>Irrigation</u>			
<u>Sandrock</u>										14 PUMP: <input type="checkbox"/> Not installed <input type="checkbox"/> Pump Installation Only Manufacturer's name <u>Myers</u> Model number <u>S2N52</u> HP <u>1/2</u> Volts <u>220</u> Length of Drop Pipe <u>40</u> ft. capacity <u>15</u> G.P.M. TYPE: <input checked="" type="checkbox"/> Submersible <input type="checkbox"/> Jet PRESSURE TANK: Manufacturer's name <u>Perma Air</u> Model number <u>PAD 36</u> Capacity <u>36</u> Gallons			
RECEIVED Michigan Dept. of Public Health JUN 06 1988 Bureau of Environmental and Occupational Health - GWOS										15. Remarks, elevation, source of data, etc.			
USE A 2ND SHEET IF NEEDED										16. WATER WELL CONTRACTOR'S CERTIFICATION: This well was drilled under my jurisdiction and this report is true to the best of my knowledge and belief. <u>F+W Well Drilling Inc. 1868</u> REGISTERED BUSINESS NAME REGISTRATION NO. Address <u>625 Wieland rd Lans. mi.</u> Signed <u>Joseph X</u> Date <u>5-6-88</u> AUTHORIZED REPRESENTATIVE			
17. Rig Operator's Name:										18. Authority: Completion: Penalty: Act 368 PA 1978 Required Conviction of a violation of any provision is a misdemeanor.			

D87d 12/86

**IMPORTANT: File with deed.**

WELL OWNER COPY

3 JUN 01 1979

WATER WELL RECORD  
ACT 294 PA 1965

MICHIGAN DEPARTMENT  
OF  
PUBLIC HEALTH

1 LOCATION OF WELL		Fraction	Section Number	Town Number	Range Number
County <b>LIVINGSTON</b>	Township Name <b>IOSCO</b>	<b>NE 1/4 SW 1/4 SW 1/4</b>	<b>01</b>	<b>2N</b> N/S.	<b>3E</b> E/W.

Distance And Direction from Road Intersections  
**Crofoot Rd.  
Between Kern and Pengree**

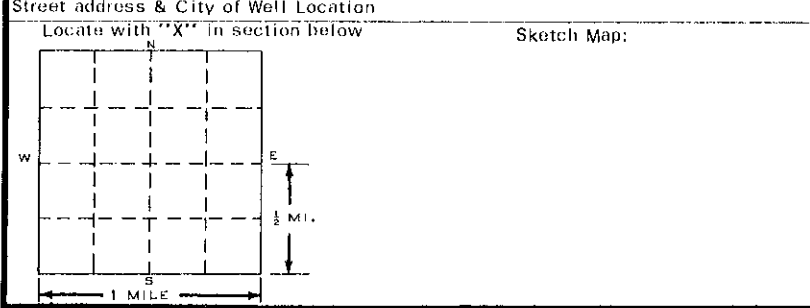

3 OWNER OF WELL:  
Address **Callaghan Homes  
6089 S. Linden Rd.  
Fenton, Mi.**

4 WELL DEPTH: (completed) Date of Completion  
**120'** ft. **11-16-78**

5  Cable tool  Rotary  Driven  Dug  
 Hollow rod  Jetted  Bored  \_\_\_\_\_

6 USE:  Domestic  Public Supply  Industry  
 Irrigation  Air Conditioning  Commercial  
 Test Well  \_\_\_\_\_

7 CASING: Threaded  Welded   
Diam. \_\_\_\_\_ Height: Above/Below Surface **1** ft.  
**4** in. to **86** ft. Depth Weight **11** lbs./ft.  
\_\_\_\_\_ in. to \_\_\_\_\_ ft. Depth Drive Shoe? Yes  No

2 FORMATION	THICKNESS OF STRATUM	DEPTH TO BOTTOM OF STRATUM
<b>Yellow Sand</b>	<b>25'</b>	<b>25'</b>
<b>Sand and Gravel</b>	<b>5'</b>	<b>30'</b>
<b>Clay</b>	<b>40'</b>	<b>70'</b>
<b>Blue Shale</b>	<b>5'</b>	<b>75'</b>
<b>Sand Rock</b>	<b>15'</b>	<b>90'</b>
<b>Limestone</b>	<b>5'</b>	<b>95'</b>
<b>Sand Stone and Limestone</b>	<b>25'</b>	<b>120'</b>

8 SCREEN:  
Type: \_\_\_\_\_ Dia.: \_\_\_\_\_  
Slot/Gauze **ROCKWELL**  
Set between \_\_\_\_\_ ft. and \_\_\_\_\_ ft.  
Fittings: \_\_\_\_\_

9 STATIC WATER LEVEL  
**25** ft. below land surface

10 PUMPING LEVEL below land surface  
**75** ft. after **2** hrs. pumping **25** g.p.m.  
\_\_\_\_\_ ft. after \_\_\_\_\_ hrs. pumping \_\_\_\_\_ g.p.m.

11 WATER QUALITY in Parts Per Million:  
Iron (Fe) \_\_\_\_\_ Chlorides (Cl) \_\_\_\_\_  
Hardness \_\_\_\_\_ Other \_\_\_\_\_

12 WELL HEAD COMPLETION:  In Approved Pit  
 Pitless Adapter  12" Above Grade

13 Well Grouted?  Yes  No  
 Neat Cement  Bentonite  \_\_\_\_\_  
Depth: From \_\_\_\_\_ ft. to \_\_\_\_\_ ft.

14 Nearest Source of possible contamination  
**80** feet **North** Direction **Septic** Type  
Well disinfected upon completion  Yes  No

15 PUMP:  Not installed  
Manufacturer's Name **Red Jacket**  
Model Number \_\_\_\_\_ HP **1/2** Volts **230**  
Length of Drop Pipe **50** ft. capacity **12** G.P.M.  
Type:  Submersible  Jet  Reciprocating

16 Remarks, elevation, source of data, etc.

ADDED INFO BY DRILLER, ITEM NO.  
CORRECTED BY **dle**  
ADDITION BY  
ELEVATION  
DEPTH TO ROCK

17 WATER WELL CONTRACTOR'S CERTIFICATION:  
This well was drilled under my jurisdiction and this report is true to the best of my knowledge and belief.  
**JIM FULMER, WELL DRILLING 0904**  
REGISTERED BUSINESS NAME REGISTRATION NO.  
Address **4700 NICHOLSON RD. FOWLerville, MI.**  
Signed **Jim Fulmer** Date **11-16-78**  
AUTHORIZED REPRESENTATIVE

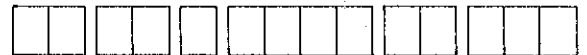

**FEB 26 1980**

**WATER WELL RECORD**  
ACT 294 PA 1965

MICHIGAN DEPARTMENT OF PUBLIC HEALTH

**1 LOCATION OF WELL**

County <b>Livingston</b>	Township Name <b>Iosco</b>	Fraction <i>SW 1/4 SW 1/4 SE 1/4</i>	Section Number <b>1</b>	Town Number <b>T2N</b>	Range Number <b>R3E</b>	E/W. <b>E/W.</b>
-----------------------------	-------------------------------	---	----------------------------	---------------------------	----------------------------	---------------------

Distance And Direction from Road Intersections  
**425' South of Crofoot Rd.**  
**8/10 mile East of Kern Rd.**

Street address & City of Well Location  
 Locate with "X" in section below

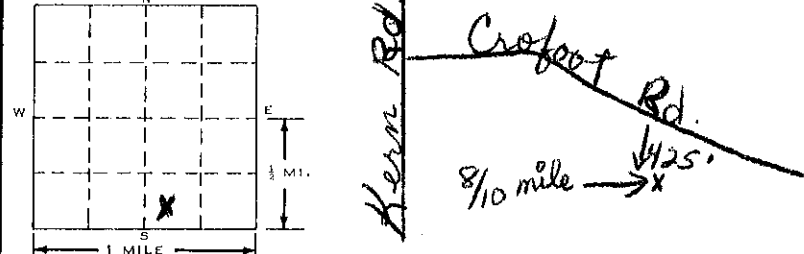

**3 OWNER OF WELL:**  
**Barry Horney**  
 Address **8672 Dale Street**  
**Dearborn Hgts, Michigan 48127**

**4 WELL DEPTH:** (completed) **117** ft. Date of Completion **8-13-79**

**5**  Cable tool  Rotary  Driven  Dug  
 Hollow rod  Jetted  Bored

**6 USE:**  Domestic  Public Supply  Industry  
 Irrigation  Air Conditioning  Commercial  
 Test Well

**7 CASING:** Threaded  Welded   
 Diam. \_\_\_\_\_ Height: Above/Below Surface **10"** ~~ft.~~  
**4** in. to **74'3"** ft. Depth Weight **11** lbs./ft.  
 \_\_\_\_\_ in. to \_\_\_\_\_ ft. Depth Drive Shoe? Yes  No

**8 SCREEN:**  
 Type: \_\_\_\_\_ Dia.: \_\_\_\_\_  
 Slot/Gauze \_\_\_\_\_ Length \_\_\_\_\_  
 Set between \_\_\_\_\_ ft. and \_\_\_\_\_ ft.  
 Fittings: \_\_\_\_\_

**9 STATIC WATER LEVEL**  
**28** ft. below land surface

**10 PUMPING LEVEL** below land surface  
**60** ft. after \_\_\_\_\_ hrs. pumping **18** g.p.m.  
 \_\_\_\_\_ ft. after \_\_\_\_\_ hrs. pumping \_\_\_\_\_ g.p.m.

**11 WATER QUALITY** in Parts Per Million:  
 Iron (Fe) \_\_\_\_\_ Chlorides (Cl) \_\_\_\_\_  
 Hardness \_\_\_\_\_ Other \_\_\_\_\_

**12 WELL HEAD COMPLETION:**  In Approved Pit  
 Pitless Adapter  12" Above Grade

**13 Well Grouted?**  Yes  No  
 Neat Cement  Bentonite   
 Depth: From \_\_\_\_\_ ft. to \_\_\_\_\_ ft.

**14 Nearest Source** of possible contamination  
 \_\_\_\_\_ feet \_\_\_\_\_ Direction \_\_\_\_\_ Type \_\_\_\_\_  
 Well disinfected upon completion  Yes  No

**15 PUMP:**  Not installed  
 Manufacturer's Name **Goulds**  
 Model Number **10EJ07422** HP **3/4** Volts **230**  
 Length of Drop Pipe **63** ft. capacity **10** G.P.M.  
 Type:  Submersible  Jet  Reciprocating

2 FORMATION	THICKNESS OF STRATUM	DEPTH TO BOTTOM OF STRATUM
Sandy clay and gravel	21	21
SAND	40	61
Gravel with gray clay strips	8	69
Gray clay and stones	3	71
Sandstone and lime	4	75
Sandstone	19	94
Sandstone and lime	16	110
Sandstone	7	117

**16 Remarks, elevation, source of data, etc.**  
**ADDED INFO BY DRILLER ITFM #**  
 \*CORRECTED BY  
 \*\*ADDITION BY *dlc*  
 ELEVATION  
 DEPTH TO ROCK

**17 WATER WELL CONTRACTOR'S CERTIFICATION:**  
 This well was drilled under my jurisdiction and this report is true to the best of my knowledge and belief.  
**Hart Well Drilling Company** **522**  
REGISTERED BUSINESS NAME REGISTRATION NO.  
 Address **1154 S. Jefferson, Mason, Michigan 48854**  
 Signed *S. W. Hart* Date **9-20-79**  
AUTHORIZED REPRESENTATIVE

JUL 20 1973

**WATER WELL RECORD**  
ACT 294 PA 1965

MICHIGAN DEPARTMENT  
OF  
PUBLIC HEALTH

1 LOCATION OF WELL

County <b>Livingston</b>	Township Name <b>10500</b>	Fraction <b>NW 1/4 NW 1/4</b>	Section Number <b>1</b>	Town Number <b>2 N/S</b>	Range Number <b>3 E/W</b>
-----------------------------	-------------------------------	----------------------------------	----------------------------	-----------------------------	------------------------------

Distance And Direction from Road Intersections

**555 Kern Rd**

**Fowlerville**

Street address & City of Well Location  
Locate with "X" in section below

Sketch Map:

3 OWNER OF WELL:

Address **ROBERT SLANKEE**  
**10840 CONVERSE Rd**  
**Fowlerville Mi**

4 WELL DEPTH: (completed) Date of Completion  
**145** ft. **11/29/72**

5  Cable tool  Rotary  Driven  Dug  
 Hollow rod  Jetted  Bored

6 USE:  Domestic  Public Supply  Industry  
 Irrigation  Air Conditioning  Commercial  
 Test Well

7 CASING: Threaded  Welded   
Diam. **4"** **4 1/2"** Height: Above/Below Surface **1** ft.  
**4"** in. to **130** ft. Depth Weight **11** lbs./ft.  
in. to \_\_\_\_\_ ft. Depth Drive Shoe? Yes  No

2 FORMATION	THICKNESS OF STRATUM	DEPTH TO BOTTOM OF STRATUM
<b>BROWN SAND</b>	<b>28'</b>	<b>28'</b>
<b>GRAY SANDY CLAY</b>	<b>10'</b>	<b>38'</b>
<b>GRAY SAND</b>	<b>02'</b>	<b>40'</b>
<b>Lime White</b>	<b>01'</b>	<b>41'</b>
<b>GRAY CLAY - GRAVEL</b>	<b>04'</b>	<b>45'</b>
<b>HARDPAN</b>	<b>07'</b>	<b>52'</b>
<b>BROWN SAND</b>	<b>16'</b>	<b>68'</b>
<b>PUTTY SAND</b>	<b>02'</b>	<b>70'</b>
<b>HARDPAN</b>	<b>05'</b>	<b>75'</b>
<b>BROWN SAND</b>	<b>16'</b>	<b>91'</b>
<b>HARDPAN</b>	<b>21'</b>	<b>112'</b>
<b>SANDROCK</b>	<b>01'</b>	<b>113'</b>
<b>HARDPAN</b>	<b>06'</b>	<b>119'</b>
<b>SANDROCK</b>	<b>26'</b>	<b>145'</b>

8 SCREEN:

Type: \_\_\_\_\_ Dia.: \_\_\_\_\_  
Slot/Gauze **ROCK Well** Length \_\_\_\_\_  
Set between \_\_\_\_\_ and \_\_\_\_\_  
Fittings: \_\_\_\_\_

9 STATIC WATER LEVEL  
**33'** ft. below land surface

10 PUMPING LEVEL below land surface  
**63'** ft. after **2** hrs. pumping **15** g.p.m.  
\_\_\_\_\_ ft. after \_\_\_\_\_ hrs. pumping \_\_\_\_\_ g.p.m.

11 WATER QUALITY in Parts Per Million:  
Iron (Fe) \_\_\_\_\_ Chlorides (Cl) \_\_\_\_\_  
Hardness \_\_\_\_\_ Other \_\_\_\_\_

12 WELL HEAD COMPLETION:  In Approved Pit  
 Pressure Adapter  12" Above Grade

13 Well Grouted?  Yes  No  
 Neat Cement  Bentonite  \_\_\_\_\_  
Depth: From \_\_\_\_\_ ft. to \_\_\_\_\_ ft.

14 Nearest Source of possible contamination  
**75'** feet \_\_\_\_\_ Direction **ST** Type  
Well disinfected upon completion  Yes  No

15 PUMP:  Not installed  
Manufacturer's Name **Red Jacket**  
Model Number \_\_\_\_\_ HP **1/2** Volts **230**  
Length of Drop Pipe **84** ft. capacity **15** G.P.M.  
Type:  Submersible  Jet  Reciprocating

16 Remarks, elevation, source of data, etc.

USE A 2ND SHEET IF NEEDED

*[Handwritten signature]*

17 WATER WELL CONTRACTOR'S CERTIFICATION:  
This well was drilled under my jurisdiction and this report is true to the best of my knowledge and belief.

**JIM FULLMER**  
REGISTERED BUSINESS NAME  
**4700 Nicholson Road**  
**Fowlerville, Mich. 48836**

REGISTRATION NO. **0994**

Signed \_\_\_\_\_ Date **12/4/72**  
AUTHORIZED REPRESENTATIVE

**WATER WELL RECORD**

ACT 294 PA 1965

MICHIGAN DEPARTMENT  
OF  
PUBLIC HEALTH

**1 LOCATION OF WELL**

County LIVINGSTON Twp. 10500 Fraction NE 1/4 NE 1/4 NE 1/4 Section No. 1 Town J N S. Range 3 W.

Distance And Direction from Road Intersections  
65' S. OF MASON RD  
450' W. OF TRUHN RD

Street address & City of Well Location  
OWNER No. \_\_\_\_\_  
3 OWNER OF WELL: JOHN ALSTOTT  
Address R1 FOWLerville  
MICH

2 FORMATION	THICKNESS OF STRATUM	DEPTH TO BOTTOM OF STRATUM
RED CLAY	12	12
CLAY & GRAVEL	12	24
GRAY CLAY & GRAVEL	8	32
GRAVEL	7	39
GRAY CLAY & GRAVEL	56	95
SHALE & SAND STONE	25	120
SAND STONE	10	130
LIMESTONE	18	148
SAND STONE	6	154
SANDSTONE & LIMESTONE STRIA	26	180
LIMESTONE, SANDSTONE & SHALE	10	190

4 WELL DEPTH: (completed) 190 ft. Date of Completion 8-30-68

5  Cable tool  Rotary  Driven  Dug  
 Hollow rod  Jetted  Bored  \_\_\_\_\_

6 USE:  Domestic  Public Supply  Industry  
 Irrigation  Air Conditioning  Commercial  
 Test Well  \_\_\_\_\_

7 CASING: Threaded  Welded   
Diam. 4 in. to 110 ft. Depth  
Height: Above/Below surface \_\_\_\_\_ ft.  
Weight 11 lbs./ft.  
Drive Shoe? Yes  No

8 SCREEN:  
Type: \_\_\_\_\_ Dia.: \_\_\_\_\_  
Slot/Gauze \_\_\_\_\_ Length \_\_\_\_\_  
Set between \_\_\_\_\_ ft. and \_\_\_\_\_ ft.  
Fittings: \_\_\_\_\_

9 STATIC WATER LEVEL 18 ft. below land surface

10 PUMPING LEVEL below land surface  
38 ft. after 2 hrs. pumping 30 g.p.m.  
\_\_\_\_\_ ft. after \_\_\_\_\_ hrs. pumping \_\_\_\_\_ g.p.m.

11 WATER QUALITY in Parts Per Million:  
Iron (Fe) \_\_\_\_\_ Chlorides (Cl) \_\_\_\_\_  
Hardness \_\_\_\_\_

12 WELL HEAD COMPLETION:  In Approved Pit  
 Pitless Adapter  12" Above Grade

13 GROUTING:  
Well Grouted?  Yes  No  
Material:  Neat Cement  BENTONITE  
Depth: From \_\_\_\_\_ ft. to \_\_\_\_\_ ft.

14 SANITARY:  
Nearest Source of possible contamination  
75 feet SE Direction SEPTIC type  
Well disinfected upon completion  Yes  No

15 PUMP:  
Manufacturer's Name RED JACKET  
Model Number R100 N1708 HP 1  
Length of Drop Pipe 42 ft. capacity 18 G.P.M.  
Type:  Submersible  \_\_\_\_\_  
 Jet  Reciprocating

16 Remarks, elevation, source of data, etc.

ADDED INFO. BY DRILLER, ITEM NO. \_\_\_\_\_

CORRECTED BY: \_\_\_\_\_

ADDITION BY: \_\_\_\_\_

17 WATER WELL CONTRACTOR'S CERTIFICATION:  
This well was drilled under my jurisdiction and this report is true to the best of my knowledge and belief.

Hart Well Drilling 522  
REGISTERED BUSINESS NAME REGISTRATION NO.

Address Mason Mich

Signed J. W. Hart Date 8-30-68  
AUTHORIZED REPRESENTATIVE

1 LOCATION OF WELL

County Livingston Township Name TOSCO Fraction SW 1/4 NE 1/4 SW 1/4 Section Number 1 Town Number 2 N/8 Range Number 3 E/4

Distance And Direction From Road Intersection

Street Address & City of Well Location 6988 Crowfoot

3 OWNER OF WELL: Bryan Underwood  
Address 43 Court St. Brighton, MI 48116  
Address Same As Well Location?  Yes  No

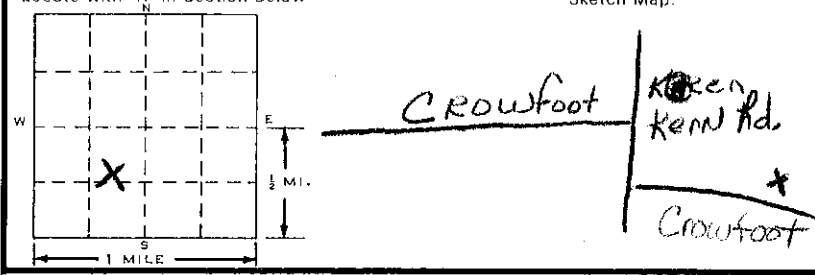

4 WELL DEPTH: 138 FT. Date Completed 9/3/92  New Well  Replacement Well

5  Cable tool  Rotary  Driven  Dug  
 Hollow rod  Auger  Jetted

6 USE:  Domestic  Type I Public  Type III Public  
 Irrigation  Type IIa Public  Heat pump  
 Test Well  Type IIb Public

7 CASING: Diameter 5 in. to 113 ft. depth  Steel  Plastic  Threaded  Welded  
Height: Above/Below Surface 1 ft. Weight \_\_\_\_\_ lbs./ft.  
Grouted Drill Hole Diameter \_\_\_\_\_ in. to \_\_\_\_\_ ft. depth Drive Shoe  Yes  No  
7 7/8 in. to 138 ft. depth

2 FORMATION DESCRIPTION THICKNESS OF STRATUM DEPTH TO BOTTOM OF STRATUM

Sand & Gravel	15	15
Gray Clay	3	18
Yellow Clay	2	20
Yellow Clay Gravelly	5	25
Yellow Clay	5	30
Gray Clay Sandy	10	40
Sand	8	48
Soft Sandy Gray Clay	10	58
Gravelly Clay	2	60
Gray Clay	50	110
Sandstone	26	136
Brown Limestone	2	138

8 SCREEN:  Not Installed  
Type Rock Diameter \_\_\_\_\_ Slot/Gauze \_\_\_\_\_ Length \_\_\_\_\_  
Set between \_\_\_\_\_ ft. and \_\_\_\_\_ ft.  
FITTINGS:  K-Packer  Lead Packer  Bremer Check  
 Blank above screen \_\_\_\_\_ ft. Other 1.5 Shale Boot

9 STATIC WATER LEVEL: 42 ft. below land surface  Flow

10 PUMPING LEVEL: below land surface  
\_\_\_\_\_ ft. after \_\_\_\_\_ hrs. pumping at 60 AIR G.P.M.  
\_\_\_\_\_ ft. after \_\_\_\_\_ hrs. pumping at \_\_\_\_\_ G.P.M.

11 WELL HEAD COMPLETION:  Pitless adapter  12" above grade  
 Basement offset  Approved pit

12 WELL GROUTED?  No  Yes From 0 to 112 ft.  
 Neat cement  Bentonite  Other Benserd  
No. of bags of cement \_\_\_\_\_ Additives 200 lbs Super Mud

13 Nearest source of possible contamination Type Septic Distance 100 ft. Direction S  
Well disinfected upon completion?  Yes  No  
Was old well plugged?  Yes  No

14 PUMP:  Not Installed  Pump Installation Only  
Manufacturer's name Myers Model number 6252-5517B 1/2 Volts 230  
Length of Drop Pipe 60 ft. capacity 12 G.P.M.  
TYPE:  Submersible  Jet  
PRESSURE TANK: Manufacturer's name Well X TROL  
Model number 202 Capacity 4 1/2 Gallons

RECEIVED  
Mich. Dept. of Public Health  
OCT 5 1992

USE A 2ND SHEET IF NEEDED BUREAU OF ENVIRONMENTAL AND OCCUPATIONAL HEALTH

15. Remarks, elevation, source of data, etc.

17. Rig Operator's Name: Tom Browne + Jim Erwin

16. WELL CONTRACTOR'S CERTIFICATION:  
This well was drilled under my jurisdiction and this report is true to the best of my knowledge and belief.  
Adams Well Drilling, Inc. 47-1580  
REGISTERED BUSINESS NAME REGISTRATION NO.  
Address 1122 S. Hacker Brighton  
Signed Daniel Adams Date 9-9-92  
AUTHORIZED REPRESENTATIVE

Authority: Act 368 PA 1978  
Completion: Required  
Penalty: Conviction of a violation of any provision is a misdemeanor.

**WATER WELL AND PUMP RECORD**

--	--	--	--	--	--	--	--

PERMIT NUMBER

<b>1 LOCATION OF WELL</b>				
County <b>Livingston</b>	Township Name <b>Iosco Twp.</b>	Fraction <b>SE 1/4 SW 1/4 NE 1/4</b>	Section Number <b>1</b>	Town Number <b>2 N/S</b>
Range Number <b>3 E/W</b>				

Distance And Direction From Road Intersection  
**Mason Road/Parcel B**

Street Address & City of Well Location  
Locate with "X" in Section Below

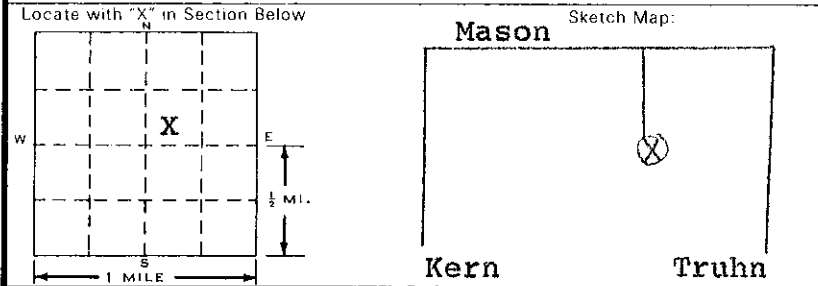

**3 OWNER OF WELL:**  
**Hennig**  
Address **311 Kensington**  
**New Hudson, MI 48165**  
Address Same As Well Location?  Yes  No

**4 WELL DEPTH:** Date Completed MO. DAY YEAR  New Well  Replacement Well  
**130 FT.** **5 13 92**

**5**  Cable tool  Rotary  Driven  Dug  
 Hollow rod  Auger  Jetted

**6 USE:**  Domestic  Type I Public  Type III Public  
 Irrigation  Type IIa Public  Heat pump  
 Test Well  Type IIb Public

**7 CASING:** Diameter  Steel  Threaded  Plastic  Welded  
**4** in. to **12** ft. depth  
Height: Above/Below Surface **1** ft.  
Weight **11** lbs./ft.  
Grouted Drill Hole Diameter \_\_\_\_\_ in. to \_\_\_\_\_ ft. depth  
Drive Shoe  Yes  No

2 FORMATION DESCRIPTION	THICKNESS OF STRATUM	DEPTH TO BOTTOM OF STRATUM
<b>sand &amp; clay</b>	<b>58</b>	<b>58</b>
<b>coal</b>	<b>3</b>	<b>61</b>
<b>sand-clay streaks</b>	<b>36</b>	<b>97</b>
<b>rock</b>	<b>33</b>	<b>130</b>

**8 SCREEN:**  Not Installed  
Type **N/A** Diameter \_\_\_\_\_  
Slot/Gauze \_\_\_\_\_ Length \_\_\_\_\_  
Set between \_\_\_\_\_ ft. and \_\_\_\_\_ ft.  
**FITTINGS:**  K-Packer  Lead Packer  Bromer Check  
 Blank above screen \_\_\_\_\_ ft. Other \_\_\_\_\_

**9 STATIC WATER LEVEL:**  
**40** ft. below land surface  Flow

**10 PUMPING LEVEL:** below land surface  
**80** ft. after **4** hrs. pumping at **20** G.P.M.  
\_\_\_\_\_ ft. after \_\_\_\_\_ hrs. pumping at \_\_\_\_\_ G.P.M.

**11 WELL HEAD COMPLETION:**  Pitless adapter  12" above grade  
 Basement offset  Approved pit

**12 WELL GROUTED?**  No  Yes From **bottom top**  
 Neat cement  Bentonite  Other \_\_\_\_\_  
No. of bags of cement **2** Additives \_\_\_\_\_

**13 Nearest source of possible contamination**  
Type **septic** Distance **75** ft. Direction **N**  
Well disinfected upon completion?  Yes  No  
Was old well plugged?  Yes  No

**14 PUMP:**  Not Installed  Pump Installation Only  
Manufacturer's name **Red Jacket**  
Model number **Ren** HP **1/2** Volts **220**  
Length of Drop Pipe **80** ft. capacity **20** G.P.M.  
TYPE:  Submersible  Jet  
PRESSURE TANK:  
Manufacturer's name **Well Rite**  
Model number **02** Capacity **42** Gallons

15. Remarks, elevation, source of data, etc.  
**Driller's log**

17. Rig Operator's Name:  
**Jon Roberts**

**16. WATER WELL CONTRACTOR'S CERTIFICATION:**  
This well was drilled under my jurisdiction and this report is true to the best of my knowledge and belief.  
**John H. Roberts Well Drilling Co. 0027**  
REGISTERED BUSINESS NAME REGISTRATION NO.  
Address **2838 Pleasant Valley Brighton 48116**  
Signed \_\_\_\_\_ Date **5-13-92**

**RECEIVED**  
Mich. Dept. of Public Health  
**JUN 16 1992**

**BUREAU OF ENVIRONMENTAL AND OCCUPATIONAL HEALTH-GWQS**

**Authority:** Act 368 PA 1978  
**Completion:** Required  
**Penalty:** Conviction of a violation of any provision is a misdemeanor.

DEC 17 1991

WATER WELL AND PUMP RECORD

PERMIT NUMBER

1 LOCATION OF WELL
County: Livingston
Township: Iosco
Fraction: SW 1/4 NE 1/4 SW 1/4
Section Number: 1
Town Number: 2 N 1/2
Range Number: 3 E 1/2 W

Distance And Direction From Road Intersection
East of Kern Road on the north side of Crofoot Road

Street Address & City of Well Location
6891 Crofoot

Locate with "X" in Section Below

Sketch Map:

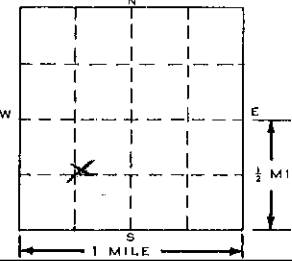

3 OWNER OF WELL:
G. W. Carpentry
Address:
Address Same As Well Location? [ ] Yes [ ] No

4 WELL DEPTH:
Date Completed: 11 12 91
90 FT.
[ ] New Well
[ ] Replacement Well

5 [ ] Cable tool [ ] Driven [ ] Dug
[ ] Hollow rod [ ] Auger [ ] Jetted

6 USE: [ ] Domestic [ ] Type I Public [ ] Type III Public
[ ] Irrigation [ ] Type IIa Public [ ] Heat pump
[ ] Test Well [ ] Type IIb Public

7 CASING:
Diameter: [ ] Steel [ ] Threaded [ ] Welded
[ ] Plastic
5 in. to 90 ft. depth
8 1/2 in. to 90 ft. depth
Height: Above/Below
Surface 1 ft.
Weight: \_\_\_ lbs./ft.
Drive Shoe [ ] Yes [ ] No

Table with 3 columns: Formation Description, Thickness of Stratum, Depth to Bottom of Stratum. Rows: Brown Clay (60, 60), Gray Sand (10, 70), Gravel (20, 90)

8 SCREEN: [ ] Not Installed
Type: Wrapped Diameter: 5"
Slot/Gauze: 20 Length: 7'
Set between: 83 ft. and 90 ft.
FITTINGS: [ ] K-Packer [ ] Lead Packer [ ] Bremer Check
[ ] Blank above screen \_\_\_ ft. Other: \_\_\_

9 STATIC WATER LEVEL:
40-50 ft. below land surface [ ] Flow

10 PUMPING LEVEL: below land surface
Air 80 ft. after 1 hrs. pumping at 25 G.P.M.

11 WELL HEAD COMPLETION: [ ] Pitless adapter [ ] 12" above grade
[ ] Basement offset [ ] Approved pit

12 WELL GROUTED? [ ] No [ ] Yes From 0 to 90 ft.
[ ] Neat cement [ ] Bentonite [ ] Other

13 Nearest source of possible contamination
Type: Sewage Distance: 75 ft. Direction: West
Well-disinfected upon completion? [ ] Yes [ ] No
Was old well plugged? [ ] Yes [ ] No

14 PUMP: [ ] Not Installed [ ] Pump Installation Only
Manufacturer's name: Red Jacket
Model number: 50CNICN9BC HP 1/2 Volts 230
Length of Drop Pipe: 60 ft. capacity 10 G.P.M.
TYPE: [ ] Submersible [ ] Jet
PRESSURE TANK:
Manufacturer's name: Amtrol
Model number: 203 Capacity: 10 Gallons

15. Remarks, elevation, source of data, etc.
USE A 2ND SHEET IF NEEDED

WATER WELL CONTRACTOR'S CERTIFICATION:
This well was drilled under my jurisdiction and this report is true to the best of my knowledge and belief.
Birkmeier Well Drilling Ltd. 1607
10655 Easton Rd New Lothrop MI 48460
Date: 11-12-91

17. Rig Operator's Name: Barry Brown

RECEIVED Mich. Dept. of Public Health

JAN 10 1992

BUREAU OF ENVIRONMENTAL AND OCCUPATIONAL HEALTH-SWGD

Address: 10655 Easton Rd New Lothrop MI 48460
Signed: [Signature] Date: 11-12-91

**WATER WELL AND PUMP RECORD**

92-231-N

**PERMIT NUMBER**

1 LOCATION OF WELL			3 OWNER OF WELL:																							
County <i>Livingston</i>	Township Name <i>10500</i>	Fraction <i>SE 1/4 SE 1/4 NE 1/4</i>	Section Number <i>1</i>	Town Number <i>2 N</i>	Range Number <i>3 E</i>																					
Distance And Direction From Road Intersection <i>South of Mason rd 1/2 mile West of Graham Rd 700 ft</i>			Address <i>Maureen Cudell 6375 Stephen Brighton</i>																							
Street Address & City of Well Location <i>Permit No. 92231-2 Graham Rd</i>			Address Same As Well Location? <input type="checkbox"/> Yes <input checked="" type="checkbox"/> No																							
Locate with "X" in Section Below Sketch Map: <i>Hobart</i>			4 WELL DEPTH: Date Completed MO. DAY YEAR <input checked="" type="checkbox"/> New Well <input type="checkbox"/> Replacement Well <i>86 FT. 5 6 92</i>																							
			5 <input type="checkbox"/> Cable tool <input checked="" type="checkbox"/> Rotary <input type="checkbox"/> Driven <input type="checkbox"/> Dug <input type="checkbox"/> Hollow rod <input type="checkbox"/> Auger <input type="checkbox"/> Jetted <input type="checkbox"/> _____																							
			6 USE: <input checked="" type="checkbox"/> Domestic <input type="checkbox"/> Type I Public <input type="checkbox"/> Type III Public <input type="checkbox"/> Irrigation <input type="checkbox"/> Type IIa Public <input type="checkbox"/> Heat pump <input type="checkbox"/> Test Well <input type="checkbox"/> Type IIb Public <input type="checkbox"/> _____																							
<table border="1" style="width: 100%; border-collapse: collapse;"> <thead> <tr> <th style="width: 70%;">2 FORMATION DESCRIPTION</th> <th style="width: 15%;">THICKNESS OF STRATUM</th> <th style="width: 15%;">DEPTH TO BOTTOM OF STRATUM</th> </tr> </thead> <tbody> <tr><td><i>Sand &amp; Clay</i></td><td><i>5</i></td><td><i>5</i></td></tr> <tr><td><i>Sand</i></td><td><i>10</i></td><td><i>15</i></td></tr> <tr><td><i>SAND &amp; CLAY</i></td><td><i>15</i></td><td><i>30</i></td></tr> <tr><td><i>CLAY</i></td><td><i>25</i></td><td><i>55</i></td></tr> <tr><td><i>CLAY &amp; Gravel</i></td><td><i>23</i></td><td><i>78</i></td></tr> <tr><td><i>SAND Stone</i></td><td><i>8</i></td><td><i>86</i></td></tr> </tbody> </table>			2 FORMATION DESCRIPTION	THICKNESS OF STRATUM	DEPTH TO BOTTOM OF STRATUM	<i>Sand &amp; Clay</i>	<i>5</i>	<i>5</i>	<i>Sand</i>	<i>10</i>	<i>15</i>	<i>SAND &amp; CLAY</i>	<i>15</i>	<i>30</i>	<i>CLAY</i>	<i>25</i>	<i>55</i>	<i>CLAY &amp; Gravel</i>	<i>23</i>	<i>78</i>	<i>SAND Stone</i>	<i>8</i>	<i>86</i>	7 CASING: Diameter <input type="checkbox"/> Steel <input type="checkbox"/> Threaded <input type="checkbox"/> Height: Above/Below <input checked="" type="checkbox"/> Plastic <input type="checkbox"/> Welded <i>5</i> in. to <i>20</i> ft. depth Surface <i>1</i> ft. Weight <i>1.5</i> lbs./ft. GROUTED DRILL HOLE DIAMETER <i>7 1/4</i> in. to <i>24</i> ft. depth Drive Shoe <input type="checkbox"/> Yes <input type="checkbox"/> No		
			2 FORMATION DESCRIPTION	THICKNESS OF STRATUM	DEPTH TO BOTTOM OF STRATUM																					
			<i>Sand &amp; Clay</i>	<i>5</i>	<i>5</i>																					
			<i>Sand</i>	<i>10</i>	<i>15</i>																					
			<i>SAND &amp; CLAY</i>	<i>15</i>	<i>30</i>																					
			<i>CLAY</i>	<i>25</i>	<i>55</i>																					
<i>CLAY &amp; Gravel</i>	<i>23</i>	<i>78</i>																								
<i>SAND Stone</i>	<i>8</i>	<i>86</i>																								
8 SCREEN: <input checked="" type="checkbox"/> Not Installed Type _____ Diameter _____ Slot/Gauze _____ Length _____ Set between _____ ft. and _____ ft. FITTINGS: <input type="checkbox"/> K-Packer <input type="checkbox"/> Lead Packer <input type="checkbox"/> Bremer Check <input type="checkbox"/> Blank above screen _____ ft. Other _____																										
9 STATIC WATER LEVEL: <i>20</i> ft. below land surface <input type="checkbox"/> Flow																										
10 PUMPING LEVEL: below land surface <i>30</i> ft. after <i>1</i> hrs. pumping at <i>50</i> G.P.M. _____ ft. after _____ hrs. pumping at _____ G.P.M.																										
11 WELL HEAD COMPLETION: <input checked="" type="checkbox"/> Pileless adapter <input type="checkbox"/> 12" above grade <input type="checkbox"/> Basement offset <input type="checkbox"/> Approved pit																										
12 WELL GROUTED? <input type="checkbox"/> No <input type="checkbox"/> Yes From _____ to _____ ft. <input type="checkbox"/> Neat cement <input type="checkbox"/> Bentonite <input type="checkbox"/> Other _____ No. of bags of cement _____ Additives _____																										
13 Nearest source of possible contamination Type _____ Distance _____ ft. Direction _____ Well disinfected upon completion? <input type="checkbox"/> Yes <input type="checkbox"/> No Was old well plugged? <input type="checkbox"/> Yes <input type="checkbox"/> No																										
14 PUMP: <input checked="" type="checkbox"/> Not Installed <input type="checkbox"/> Pump Installation Only Manufacturer's name _____ Model number _____ HP _____ Volts _____ Length of Drop Pipe _____ ft. capacity _____ G.P.M. TYPE: <input type="checkbox"/> Submersible <input type="checkbox"/> Jet _____ PRESSURE TANK: Manufacturer's name _____ Model number _____ Capacity _____ Gallons																										
<div style="border: 1px solid black; padding: 5px; display: inline-block;"> <b>RECEIVED</b>                      Mich. Dept. of Public Health                      JUN 16 1992                 </div>																										
15. Remarks, elevation, source of data, etc.																										
16. WATER WELL CONTRACTOR'S CERTIFICATION: This well was drilled under my jurisdiction and this report is true to the best of my knowledge and belief. <i>Roberts Co</i> REGISTERED BUSINESS NAME REGISTRATION NO. <i>47-1789</i> Address <i>3303 M 36 Brighton</i> Signed <i>RTA MLD</i> AUTHORIZED REPRESENTATIVE Date <i>5-2-92</i>																										
17. Rig Operator's Name:																										

**WATER WELL AND PUMP RECORD**

90-951(N)  
PERMIT NUMBER

**1 LOCATION OF WELL**

County <b>Livingston</b>	Township Name <b>LOSCO</b>	Fraction <b>5E 1/4 NE 1/4</b>	Section Number <b>1</b>	Town Number <b>2 N</b>	Range Number <b>3 E</b>
-----------------------------	-------------------------------	----------------------------------	----------------------------	---------------------------	----------------------------

Distance And Direction From Road Intersection  
**6976 CROFOOT**

Street Address & City of Well Location  
**6976 CROFOOT MASON**

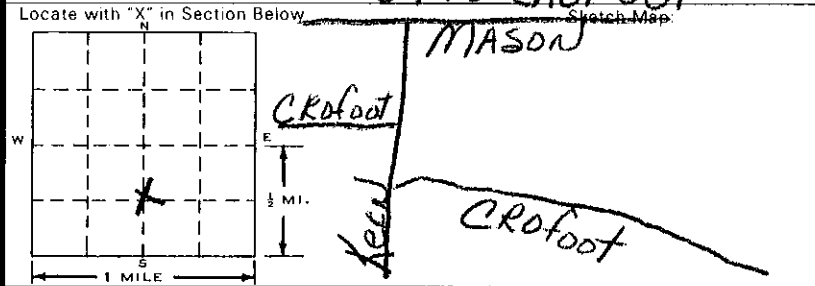

2 FORMATION DESCRIPTION	THICKNESS OF STRATUM	DEPTH TO BOTTOM OF STRATUM
GRAVEL	32	32
YELLOW CLAY	4	36
SAND & GRAVEL	2	38
YELLOW CLAY	4	42
SAND & GRAVEL	12	54
BLUE CLAY GRAVELY	26	80
(12 G.P.M.) FINE SAND	5	85
BLUE CLAY GRAVELY	12	97
SOFT WHITE SANDSTONE	13	110
LIGHT GREEN SANDSTONE	7	117
BROWN SANDSTONE	2	119
GREEN SANDSTONE	2	121
WHITE SANDSTONE	26	147

15. Remarks, elevation, source of data, etc.

17. Rig Operator's Name:  
**TOM BROWNE**

**3 OWNER OF WELL:** **CRAFTech**  
Address: **606 W. GRAND RIVER HOWELL, MI. 48843**

Address Same As Well Location?  Yes  No

**4 WELL DEPTH:** **147 FT.** Date Completed **8 16 90**  New Well  Replacement Well

**5**  Cable tool  Rotary  Driven  Dug  
 Hollow rod  Auger  Jetted

**6 USE:**  Domestic  Type I Public  Type III Public  
 Irrigation  Type IIa Public  Heat pump  
 Test Well  Type IIb Public

**7 CASING:** Diameter  Steel  Threaded  Plastic  Welded  
Height: Above/Below  
Surface \_\_\_\_\_ ft.  
Weight \_\_\_\_\_ lbs./ft.  
Drive Shoe  Yes  No

**8 SCREEN:**  Not Installed  
Type **Rock** Diameter \_\_\_\_\_  
Slot/Gauze \_\_\_\_\_ Length \_\_\_\_\_  
Set between ~~113~~ **117** ft.  
FITTINGS:  K-Packer  Lead Packer  Bremer Check  
 Blank above screen \_\_\_\_\_ ft. Other \_\_\_\_\_

**9 STATIC WATER LEVEL:** **45** ft. below land surface  Flow

**10 PUMPING LEVEL:** below land surface  
\_\_\_\_\_ ft. after \_\_\_\_\_ hrs. pumping at **30** G.P.M.  
\_\_\_\_\_ ft. after \_\_\_\_\_ hrs. pumping at \_\_\_\_\_ G.P.M.

**11 WELL HEAD COMPLETION:**  Pitless adapter  12" above grade  
 Basement offset  Approved pit

**12 WELL GROUTED?**  No  Yes From **0** to **100** ft.  
 Neat cement  Bentonite  Other \_\_\_\_\_  
No. of bags of cement **250** Additives \_\_\_\_\_

**13 Nearest source of possible contamination**  
Type **SEPTIC** Distance **75** ft. Direction **W**  
Well disinfected upon completion?  Yes  No  
Was old well plugged?  Yes  No

**14 PUMP:**  Not Installed  Pump Installation Only  
Manufacturer's name **MYERS**  
Model number **S252-JS11AP** **1/2** Volts **230**  
Length of Drop Pipe **84** ft. capacity **11** G.P.M.  
TYPE:  Submersible  Jet  
PRESSURE TANK:  
Manufacturer's name **WELL X TROL**  
Model number **202** Capacity **4 1/2** Gallons

**16. WATER WELL CONTRACTOR'S CERTIFICATION:**  
This well was drilled under my jurisdiction and this report is true to the best of my knowledge and belief.

**ADAMS WELL DRILLING, INC. 47-1580**  
REGISTERED BUSINESS NAME REGISTRATION NO. \_\_\_\_\_  
Address **122 S. HACKER BRIGHTON**  
Signed **Daniel Adams** Date **9-4-90**  
AUTHORIZED REPRESENTATIVE

**WATER WELL AND PUMP RECORD**

--	--	--	--	--	--

PERMIT NUMBER

<b>1 LOCATION OF WELL</b>		
County <i>Livingston</i>	Township Name <i>Tosco</i>	Fraction <i>NW 1/4 NW 1/4 SW 1/4</i>
Distance And Direction From Road Intersection <i>Well 1/2 MI E of Keen Rd</i>		Section Number <i>1</i>
Street Address & City of Well Location		Town Number <i>2 N/S</i>
Locate with "X" in Section Below		Range Number <i>3 E/W</i>
	Sketch Map: <i>Keen</i> <i>CROFOOT</i>	
<b>2 FORMATION DESCRIPTION</b>		
FORMATION DESCRIPTION	THICKNESS OF STRATUM	DEPTH TO BOTTOM OF STRATUM
<i>CLAY</i>	<i>30</i>	<i>30</i>
<i>SAND &amp; GRAVEL</i>	<i>50</i>	<i>80</i>
<i>SANDSTONE</i>	<i>40</i>	<i>120</i>
<b>3 OWNER OF WELL:</b> <i>JIM CHAPMAN</i>		
Address <i>CROFOOT RD</i> <i>Howell MI</i>		
Address Same As Well Location? <input checked="" type="checkbox"/> Yes <input type="checkbox"/> No		
<b>4 WELL DEPTH:</b> <i>120 FT.</i> Date Completed <i>11 8 92</i>		
<input checked="" type="checkbox"/> New Well <input type="checkbox"/> Replacement Well		
<b>5</b> <input type="checkbox"/> Cable tool <input checked="" type="checkbox"/> Rotary <input type="checkbox"/> Driven <input type="checkbox"/> Dug		
<input type="checkbox"/> Hollow rod <input type="checkbox"/> Auger <input type="checkbox"/> Jetted <input type="checkbox"/>		
<b>6 USE:</b> <input checked="" type="checkbox"/> Domestic <input type="checkbox"/> Type I Public <input type="checkbox"/> Type III Public		
<input type="checkbox"/> Irrigation <input type="checkbox"/> Type IIa Public <input type="checkbox"/> Heat pump		
<input type="checkbox"/> Test Well <input type="checkbox"/> Type IIb Public <input type="checkbox"/>		
<b>7 CASING:</b> Diameter <input type="checkbox"/> Steel <input type="checkbox"/> Threaded <input checked="" type="checkbox"/> Plastic <input type="checkbox"/> Welded		
Height: Above/Below Surface <i>1</i> ft.		Weight _____ lbs./ft.
<i>5</i> in. to <i>8.5</i> ft. depth		Drive Shoe <input type="checkbox"/> Yes <input type="checkbox"/> No
_____ in. to _____ ft. depth		
_____ in. to _____ ft. depth		
_____ in. to _____ ft. depth		
<b>8 SCREEN:</b> <input checked="" type="checkbox"/> Not Installed		
Type _____ Diameter _____		
Slot/Gauze _____ Length _____		
Set between _____ ft. and _____ ft.		
FITTINGS: <input type="checkbox"/> K-Packer <input type="checkbox"/> Lead Packer <input type="checkbox"/> Bremer Check		
<input type="checkbox"/> Blank above screen _____ ft. Other _____		
<b>9 STATIC WATER LEVEL:</b> <i>20</i> ft. below land surface <input type="checkbox"/> Flow		
<b>10 PUMPING LEVEL:</b> below land surface		
<i>40</i> ft. after <i>2</i> hrs. pumping at <i>20</i> G.P.M.		
_____ ft. after _____ hrs. pumping at _____ G.P.M.		
<b>11 WELL HEAD COMPLETION:</b> <input checked="" type="checkbox"/> Pitless adapter <input type="checkbox"/> 12" above grade		
<input type="checkbox"/> Basement offset <input type="checkbox"/> Approved pit		
<b>12 WELL GROUTED?</b> <input type="checkbox"/> No <input checked="" type="checkbox"/> Yes From <i>0</i> to <i>80</i> ft.		
<input type="checkbox"/> Neat cement <input checked="" type="checkbox"/> Bentonite <input type="checkbox"/> Other _____		
No. of bags of cement _____ Additives _____		
<b>13 Nearest source of possible contamination</b>		
Type <i>SEPTIC</i> Distance <i>100</i> ft. Direction <i>S</i>		
Well disinfected upon completion? <input type="checkbox"/> Yes <input type="checkbox"/> No		
Was old well plugged? <input type="checkbox"/> Yes <input type="checkbox"/> No		
<b>14 PUMP:</b> <input type="checkbox"/> Not Installed <input type="checkbox"/> Pump Installation Only		
Manufacturer's name <i>MYERS</i>		
Model number _____ HP <i>1 1/2</i> Volts <i>230</i>		
Length of Drop Pipe <i>40</i> ft. capacity <i>10</i> G.P.M.		
TYPE: <input checked="" type="checkbox"/> Submersible <input type="checkbox"/> Jet		
PRESSURE TANK: Manufacturer's name <i>EXTRON</i>		
Model number <i>202</i> Capacity <i>42</i> Gallons		
<b>RECEIVED</b>		
FEB 8 1993		
<b>15. Remarks, elevation, source of data, etc. of Public Health</b>		<b>16. WATER WELL CONTRACTOR'S CERTIFICATION:</b>
		This well was drilled under my jurisdiction and this report is true to the best of my knowledge and belief.
		<i>JIM FULMER W.D. 0994</i>
		REGISTERED BUSINESS NAME REGISTRATION NO.
<b>17. Rig Operator's Name:</b> <i>BUREAU OF ENVIRONMENTAL AND OCCUPATIONAL HEALTH/SGS</i>		Address <i>FOULCRVILLE MI</i>
		Signed <i>Jim Fulmer</i> Date <i>11-12-12</i>
		AUTHORIZED REPRESENTATIVE

**WATER WELL RECORD**  
ACT 294 PA 1965

MICHIGAN DEPARTMENT  
OF  
PUBLIC HEALTH

**1 LOCATION OF WELL**

County <b>Livingston</b>	Township Name <b>10500</b>	Fraction <b>SE 1/4 SE 1/4 NE 1/4</b>	Section Number <b>1</b>	Town Number <b>2 N/E</b>	Range Number <b>3 E/W</b>
-----------------------------	-------------------------------	---	----------------------------	-----------------------------	------------------------------

Distance And Direction from Road Intersections  
**South of Mason Rd. on west side 400 Truhn Rd.**

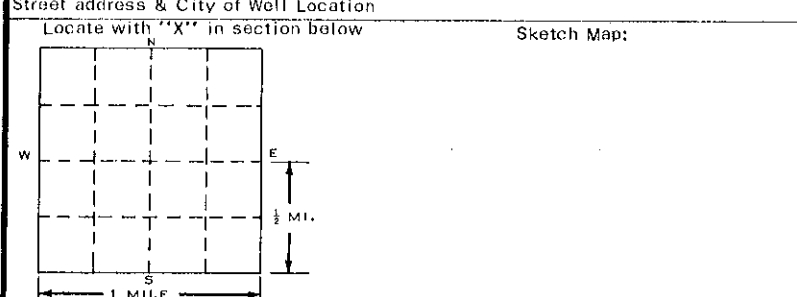

**3 OWNER OF WELL:**  
Address  
**R. Ashby  
400 Truhn Rd.  
Fowlerville, Mich.**

**4 WELL DEPTH:** (completed) **135 ft.** Date of Completion **8-26-69**

**5**  Cable tool  Rotary  Driven  Dug  
 Hollow rod  Jetted  Bored

**6 USE:**  Domestic  Public Supply  Industry  
 Irrigation  Air Conditioning  Commercial  
 Test Well

**7 CASING:** Threaded  Welded   
Diam. **4"** Height: Above/Below Surface \_\_\_\_\_ ft.  
**4" in. to 95' ft. Depth** Weight **11** lbs./ft.  
\_\_\_\_\_ in. to \_\_\_\_\_ ft. Depth Drive Shoe? Yes  No

**2 FORMATION**

FORMATION	THICKNESS OF STRATUM	DEPTH TO BOTTOM OF STRATUM
<b>CLAY</b>	<b>6</b>	<b>6</b>
<b>Brown Clay</b>		
<b>AND GRAVEL</b>	<b>14</b>	<b>20</b>
<b>GRAY CLAY &amp; GRAVEL</b>	<b>22</b>	<b>42</b>
<b>GRAY CLAY</b>	<b>34</b>	<b>76</b>
<b>GRAVEL</b>	<b>3</b>	<b>79</b>
<b>CLAY &amp; STREAKS OF ROCK</b>	<b>6</b>	<b>85</b>
<b>Rock</b>	<b>8</b>	<b>93</b>
<b>open hole SANDROCK</b>	<b>42</b>	<b>135</b>

**8 SCREEN:** **Rockwell**  
Type: \_\_\_\_\_ Dia.: \_\_\_\_\_  
Slot/Gauze \_\_\_\_\_ Length \_\_\_\_\_  
Set between \_\_\_\_\_ ft. and \_\_\_\_\_ ft.  
Fittings: \_\_\_\_\_

**9 STATIC WATER LEVEL**  
**20'** ft. below land surface

**10 PUMPING LEVEL** below land surface  
\_\_\_\_\_ ft. after \_\_\_\_\_ hrs. pumping \_\_\_\_\_ g.p.m.  
\_\_\_\_\_ ft. after \_\_\_\_\_ hrs. pumping \_\_\_\_\_ g.p.m.

**11 WATER QUALITY** in Parts Per Million:  
Iron (Fe) \_\_\_\_\_ Chlorides (Cl) \_\_\_\_\_  
Hardness \_\_\_\_\_ Other \_\_\_\_\_

**12 WELL HEAD COMPLETION:**  In Approved Pit  
 Pitless Adapter  12" Above Grade

**13 Well Grouted?**  Yes  No  
 Neat Cement  Bentonite   
Depth: From \_\_\_\_\_ ft. to \_\_\_\_\_ ft.

**14 Nearest Source** of possible contamination  
**75 feet NW** Direction **Septic** Type  
Well disinfected upon completion  Yes  No

**15 PUMP:**  Not installed  
Manufacturer's Name **Red Jacket**  
Model Number **78B** HP **1/2** Volts **230**  
Length of Drop Pipe **63** ft. capacity \_\_\_\_\_ G.P.M.  
Type:  Submersible  Jet  Reciprocating

**16 Remarks, elevation, source of data, etc.**  
  
ADDED INFO. BY \_\_\_\_\_ KAR. ILM. NO. \_\_\_\_\_  
CORRECTED BY: *J*  
OCASION BY \_\_\_\_\_

**17 WATER WELL CONTRACTOR'S CERTIFICATION:**  
This well was drilled under my jurisdiction and this report is true to the best of my knowledge and belief.  
**Brown Drilling Co. Inc.** **0026**  
REGISTERED BUSINESS NAME REGISTERATION NO.  
Address **7215 M-59 Howell, Mich.**  
Signed **Harry R Brown** Date **Dec 5 69**  
AUTHORIZED REPRESENTATIVE

**JUN 11 1975**

**WATER WELL RECORD**  
ACT 294 PA 1965

MICHIGAN DEPARTMENT  
OF  
PUBLIC HEALTH

--	--	--	--	--	--	--	--	--	--	--

3

<b>1 LOCATION OF WELL</b>		
County <b>LIVINGSTON</b>	Township Name <b>LASCOC</b>	Fraction $\frac{1}{4}$ $\frac{1}{4}$ $\frac{1}{4}$
Distance And Direction from Road Intersections <b>well 1 <math>\frac{3}{10}</math> mile w of pingree s of crofoot 100'</b>		Section Number <b>1 &amp; 12</b>
Street address & City of Well Location Locate with "X" in section below		Town Number <b>2 N/9</b>
Sketch Map: 		Range Number <b>3 E/4</b>
<b>2 FORMATION</b>		
FORMATION	THICKNESS OF STRATUM	DEPTH TO BOTTOM OF STRATUM
Clay	7	7
Clay & sand	9	16
Yellow sand	37	53
Fine grey sand	11	64
Fine water sand	8	72
USE A 2ND SHEET IF NEEDED		

<b>3 OWNER OF WELL:</b> Mr. Jakezillich Address <b>R#1 ROSCOMMON BOX 558 MLLC 48653</b>		
<b>4 WELL DEPTH:</b> (completed) <b>72</b> ft. Date of Completion <b>11-27-74</b>		
<b>5</b> <input checked="" type="checkbox"/> Cable tool <input type="checkbox"/> Rotary <input type="checkbox"/> Driven <input type="checkbox"/> Dug <input type="checkbox"/> Hollow rod <input type="checkbox"/> Jetted <input type="checkbox"/> Bored <input type="checkbox"/> _____		
<b>6 USE:</b> <input checked="" type="checkbox"/> Domestic <input type="checkbox"/> Public Supply <input type="checkbox"/> Industry <input type="checkbox"/> Irrigation <input type="checkbox"/> Air Conditioning <input type="checkbox"/> Commercial <input type="checkbox"/> Test Well <input type="checkbox"/> _____		
<b>7 CASING:</b> Threaded <input checked="" type="checkbox"/> Welded <input type="checkbox"/> Diam. _____ Height <input checked="" type="checkbox"/> Above <input type="checkbox"/> Below Surface <b>3</b> ft. <b>4</b> in. to <b>72</b> ft. Depth Weight <b>11</b> lbs./ft. _____ in. to _____ ft. Depth Drive Shoe? Yes <input checked="" type="checkbox"/> No <input type="checkbox"/>		
<b>8 SCREEN:</b> Type: <b>Stainless steel</b> <b>4"</b> <input checked="" type="checkbox"/> Slot/Gauze <b>12</b> Length <b>4'</b> Set between <b>68</b> ft. and <b>72</b> ft. Fittings: <b>12" nipple w/k packer</b>		
<b>9 STATIC WATER LEVEL</b> <b>28</b> ft. below land surface		
<b>10 PUMPING LEVEL</b> below land surface <b>40</b> ft. after <b>2</b> hrs. pumping <b>20</b> g.p.m. _____ ft. after _____ hrs. pumping _____ g.p.m.		
<b>11 WATER QUALITY</b> in Parts Per Million: Iron (Fe) _____ Chlorides (Cl) _____ Hardness _____ Other _____		
<b>12 WELL HEAD COMPLETION:</b> <input type="checkbox"/> In Approved Pit <input type="checkbox"/> Pitless Adapter <input type="checkbox"/> 12" Above Grade		
<b>13 Well Grouted?</b> <input type="checkbox"/> Yes <input checked="" type="checkbox"/> No <input type="checkbox"/> Neat Cement <input type="checkbox"/> Bentonite <input type="checkbox"/> _____ Depth: From _____ ft. to _____ ft.		
<b>14 Nearest Source</b> of possible contamination _____ feet _____ Direction _____ Type _____ Well disinfected upon completion <input type="checkbox"/> Yes <input type="checkbox"/> No		
<b>15 PUMP:</b> <input checked="" type="checkbox"/> Not installed Manufacturer's Name _____ Model Number _____ HP _____ Volts _____ Length of Drop Pipe _____ ft. capacity _____ G.P.M. Type: <input type="checkbox"/> Submersible <input type="checkbox"/> Jet <input type="checkbox"/> Reciprocating		

**16 Remarks, elevation, source of data, etc.**

ADDED INFO BY DRILLER, ITEM NO.  
\*CORRECTED BY *[Signature]*  
\*\*ADDITION BY  
ELEVATION  
DEPTH TO ROCK

**17 WATER WELL CONTRACTOR'S CERTIFICATION:**  
This well was drilled under my jurisdiction and this report is true to the best of my knowledge and belief.

**John Cameron & Son** **0414**  
REGISTERED BUSINESS NAME REGISTRATION NO.

Address **1800 Butterfield Rd., Troy, Mich.**

Signed *[Signature]* Date **12-9-74**  
AUTHORIZED REPRESENTATIVE

APR - 6 1976

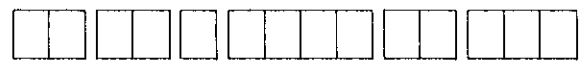

**WATER WELL RECORD**  
ACT 294 PA 1965

MICHIGAN DEPARTMENT  
OF  
PUBLIC HEALTH

<b>1 LOCATION OF WELL</b>																							
County <b>LEVINGSTON</b>	Township Name <b>IOSCO</b>	Fraction <b>Nw<sup>1</sup>/<sub>4</sub> SW<sup>1</sup>/<sub>4</sub> SE<sup>1</sup>/<sub>4</sub></b>																					
Distance And Direction from Road Intersections		Section Number <b>01</b>																					
Street address & City of Well Location <b>6544 Crofoot Rd Fowlerville, Mi</b>		Town Number <b>2N N/S.</b>																					
Locate with "X" in section below		Range Number <b>3E E/W.</b>																					
		<b>3 OWNER OF WELL:</b> Address <b>Charles Bachmair 31508 Avondale Westland, Mi 48185</b>																					
<table border="1" style="width: 100%; border-collapse: collapse;"> <tr> <th style="width: 30%;">FORMATION</th> <th style="width: 15%;">THICKNESS OF STRATUM</th> <th style="width: 15%;">DEPTH TO BOTTOM OF STRATUM</th> </tr> <tr> <td><b>Yellow Clay</b></td> <td><b>15'</b></td> <td><b>15'</b></td> </tr> <tr> <td><b>Yellow Sandy Clay</b></td> <td><b>57'</b></td> <td><b>72'</b></td> </tr> <tr> <td><b>Limestone and boulders</b></td> <td><b>11'</b></td> <td><b>83'</b></td> </tr> <tr> <td><b>Shale and Sandstone</b></td> <td><b>07'</b></td> <td><b>90'</b></td> </tr> <tr> <td><b>Sandstone</b></td> <td><b>15'</b></td> <td><b>105'</b></td> </tr> <tr> <td><b>Limestone</b></td> <td><b>05'</b></td> <td><b>115'</b></td> </tr> </table>		FORMATION	THICKNESS OF STRATUM	DEPTH TO BOTTOM OF STRATUM	<b>Yellow Clay</b>	<b>15'</b>	<b>15'</b>	<b>Yellow Sandy Clay</b>	<b>57'</b>	<b>72'</b>	<b>Limestone and boulders</b>	<b>11'</b>	<b>83'</b>	<b>Shale and Sandstone</b>	<b>07'</b>	<b>90'</b>	<b>Sandstone</b>	<b>15'</b>	<b>105'</b>	<b>Limestone</b>	<b>05'</b>	<b>115'</b>	<b>4 WELL DEPTH:</b> (completed) Date of Completion <b>110</b> ft. <b>10/18/75</b>
		FORMATION	THICKNESS OF STRATUM	DEPTH TO BOTTOM OF STRATUM																			
<b>Yellow Clay</b>	<b>15'</b>	<b>15'</b>																					
<b>Yellow Sandy Clay</b>	<b>57'</b>	<b>72'</b>																					
<b>Limestone and boulders</b>	<b>11'</b>	<b>83'</b>																					
<b>Shale and Sandstone</b>	<b>07'</b>	<b>90'</b>																					
<b>Sandstone</b>	<b>15'</b>	<b>105'</b>																					
<b>Limestone</b>	<b>05'</b>	<b>115'</b>																					
		<b>5</b> <input checked="" type="checkbox"/> Cable tool <input type="checkbox"/> Rotary <input type="checkbox"/> Driven <input type="checkbox"/> Dug <input type="checkbox"/> Hollow rod <input type="checkbox"/> Jetted <input type="checkbox"/> Bored <input type="checkbox"/>																					
		<b>6 USE:</b> <input checked="" type="checkbox"/> Domestic <input type="checkbox"/> Public Supply <input type="checkbox"/> Industry <input type="checkbox"/> Irrigation <input type="checkbox"/> Air Conditioning <input type="checkbox"/> Commercial <input type="checkbox"/> Test Well <input type="checkbox"/>																					
		<b>7 CASING:</b> Threaded <input checked="" type="checkbox"/> Welded <input type="checkbox"/> Diam. <b>4"</b> Height: Above Surface <del>XXXX</del> <b>1</b> ft. <b>4</b> in. to <b>91</b> ft. Depth Weight <b>11</b> lbs./ft. _____ in. to _____ ft. Depth Drive Shoe? Yes <input checked="" type="checkbox"/> No <input type="checkbox"/>																					
		<b>8 SCREEN:</b> <b>ROCK WELL</b> Type: _____ Dia.: _____ Slot/Gauze _____ Length _____ Set between _____ ft. and _____ ft. Fittings: _____																					
		<b>9 STATIC WATER LEVEL</b> <b>35</b> ft. below land surface																					
		<b>10 PUMPING LEVEL</b> below land surface <b>60</b> ft. after <b>2</b> hrs. pumping <b>15</b> g.p.m. _____ ft. after _____ hrs. pumping _____ g.p.m.																					
		<b>11 WATER QUALITY</b> in Parts Per Million: Iron (Fe) _____ Chlorides (Cl) _____ Hardness _____ Other _____																					
		<b>12 WELL HEAD COMPLETION:</b> <input type="checkbox"/> In Approved Pit <input checked="" type="checkbox"/> Pitless Adapter <input type="checkbox"/> 12" Above Grade																					
		<b>13 Well Grouted?</b> <input type="checkbox"/> Yes <input type="checkbox"/> No <input checked="" type="checkbox"/> Neat Cement <input type="checkbox"/> Bentonite <input type="checkbox"/> Depth: From _____ ft. to _____ ft.																					
		<b>14 Nearest Source</b> of possible contamination <b>75</b> feet _____ Direction _____ Type _____ Well disinfected upon completion <input checked="" type="checkbox"/> Yes <input type="checkbox"/> No																					
		<b>15 PUMP:</b> <input type="checkbox"/> Not installed Manufacturer's Name <b>Myers</b> Model Number <b>468300EA</b> HP <b>1/2</b> Volts <b>230</b> Length of Drop Pipe <b>60</b> ft. capacity <b>12</b> g.p.m. Type: <input checked="" type="checkbox"/> Submersible <input type="checkbox"/> Jet <input type="checkbox"/> Reciprocating																					
<b>16 Remarks, elevation, source of data, etc.</b>		<b>17 WATER WELL CONTRACTOR'S CERTIFICATION:</b> This well was drilled under my jurisdiction and this report is true to the best of my knowledge and belief. <b>JIM FULMER</b> <b>0994</b> REGISTERED BUSINESS NAME REGISTRATION NO. <b>4700 Nicholson Road</b> Address <b>Fowlerville, Mich. 48836</b> Signed <i>Jim Fulmer</i> Date <b>11/19/20</b> AUTHORIZED REPRESENTATIVE (P.C.)																					

USE A 2ND SHEET IF NEEDED

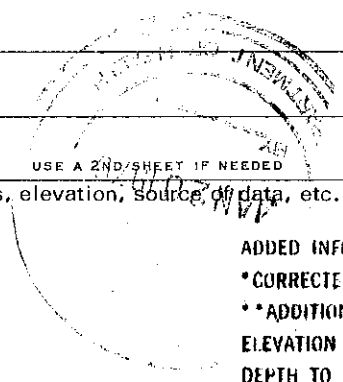

ADDED INFO BY DRILLER, ITEM NO.  
\*CORRECTED BY  
\*\*ADDITION BY  
ELEVATION  
DEPTH TO ROCK

**WATER WELL RECORD**  
ACT 294 PA 1965

MICHIGAN DEPARTMENT  
OF  
PUBLIC HEALTH

1 LOCATION OF WELL  
 County: **Livingston** Township Name: **Iosco** Fraction: **NW ¼ SE ¼ SW ¼** Section Number: **1** Town Number: **2N N/S.** Range Number: **3E E/W.**

Distance And Direction from Road Intersections  
 \_\_\_\_\_ **Crofoot Rd.**

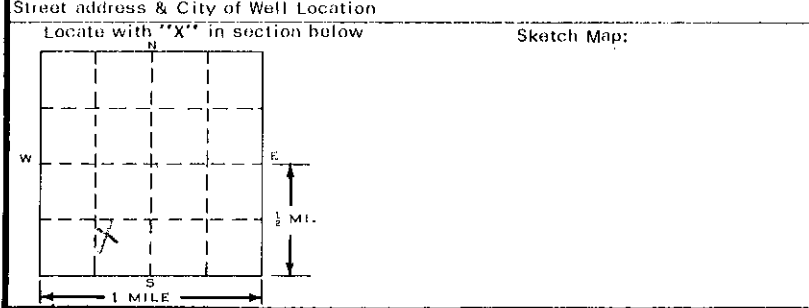

3 OWNER OF WELL:  
**Harold Ward**  
 Address: **3334 W. Coon Lake Rd. Howell, Michigan**

4 WELL DEPTH: (completed) **134'** ft. Date of Completion **4/20/76**

5  Cable tool  Rotary  Driven  Dug  
 Hollow rod  Jetted  Bored  \_\_\_\_\_

6 USE:  Domestic  Public Supply  Industry  
 Irrigation  Air Conditioning  Commercial  
 Test Well  \_\_\_\_\_

7 CASING: Threaded  Welded   
 Diam. **4"** Height: Above/~~8 MAX~~ Surface **1** ft.  
**4** in. to **110** Depth Weight **11** lbs./ft.  
 \_\_\_\_\_ in. to \_\_\_\_\_ ft. Depth Drive Shoe? Yes  No

2 FORMATION	THICKNESS OF STRATUM	DEPTH TO BOTTOM OF STRATUM
<b>Sandy Yellow Clay</b>	<b>25'</b>	<b>25'</b>
<b>Yellow Sand</b>	<b>45'</b>	<b>70'</b>
<b>Hardpan and stones</b>	<b>34'</b>	<b>104'</b>
<b>Sandstone and Lime</b>	<b>30'</b>	<b>134'</b>

8 SCREEN: **ROCK WELL**  
 Type: \_\_\_\_\_ Dia.: \_\_\_\_\_  
 Slot/Gauze \_\_\_\_\_ Length \_\_\_\_\_  
 Set between \_\_\_\_\_ ft. and \_\_\_\_\_ ft.  
 Fittings: \_\_\_\_\_

9 STATIC WATER LEVEL  
**58** ft. below land surface

10 PUMPING LEVEL below land surface  
**75** ft. after **2** hrs. pumping **20** g.p.m.  
 \_\_\_\_\_ ft. after \_\_\_\_\_ hrs. pumping \_\_\_\_\_ g.p.m.

11 WATER QUALITY in Parts Per Million:  
 Iron (Fe) \_\_\_\_\_ Chlorides (Cl) \_\_\_\_\_  
 Hardness \_\_\_\_\_ Other \_\_\_\_\_

12 WELL HEAD COMPLETION:  In Approved Pit  
 Pitless Adapter  12" Above Grade

13 Well Grouted?  Yes  No  
 Neat Cement  Bentonite  \_\_\_\_\_  
 Depth: From \_\_\_\_\_ ft. to \_\_\_\_\_ ft.

14 Nearest Source of possible contamination  
**75** feet **S** Direction **septic** Type  
 Well disinfected upon completion  Yes  No

15 PUMP:  Not installed  
 Manufacturer's Name **Myers**  
 Model Number **471654-GA** HP **1/2** Volts **230**  
 Length of Drop Pipe **70** ft. capacity **12** P.M.  
 Type:  Submersible  
 Jet  Reciprocating

16 Remarks, elevation, source of data, etc.  
 ADDED INFO BY DRILLER, ITEM NO.  
 \*CORRECTED BY  
 \*\*ADDITION BY  
 ELEVATION  
 DEPTH TO ROCK  
*[Handwritten signature]*

17 WATER WELL CONTRACTOR'S CERTIFICATION:  
 This well was drilled under my jurisdiction and this report is true to the best of my knowledge and belief.  
 REGISTERED MINER **WILLIAMS** REGISTRATION NO. **0994**  
 Address **4700 Nicholson Road Fowlerville, Mich. 48836**  
 Signed *[Signature]* AUTHORIZED REPRESENTATIVE Date **4/20/76**