

WATER WELL AND PUMP RECORD

TAX NO:
 40-003-034-010-20

Completion is required under authority of Part 127 Act 368 PA 1978
 Failure to comply is a misdemeanor

PERMIT NO:
 30475

1. LOCATION OF WELL
 County Kalamazoo

Township Name Boardman Fraction SW 1/4 Section No. 34 Town No. 26 Range No. 8

Distance and Direction from Road Intersection
Butler Rd.
Approx. 1/2 mi. S. of Butler Rd. +
Lucre Rd. Well is E. of Butler
Rd. 300'

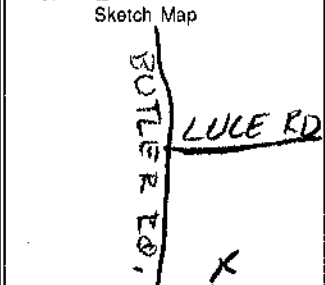
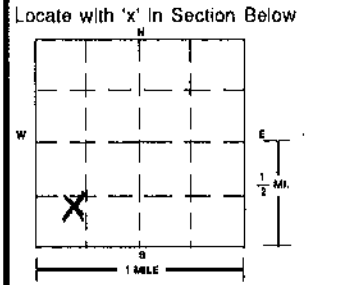

3. OWNER OF WELL
Pat Hurlman
 Address 1-10701 Loomer Lane
Delta, Oh 43515
 Address Same as Well Location Yes No

4. WELL DEPTH: 83 ft. Date Completed 10-20-99
 New Well
 Replacement Well

5. Cable Tool Rotary Driven Dug
 Hollow Rod Auger/Bored Jetted

6. USE: Household Type I Public Type III Public
 Irrigation Type IIa Public Heat Pump
 Test Well Type IIb Public

7. CASING: Steel Threaded
 Plastic Welded
 Other Galv.
 Height: Above/Below Surface: _____ ft.

Diameter: 4 in. to 79 ft. depth Weight: 11 lbs./ft.
 BORE HOLE: Drive Shoe
 Diameter: _____ in. to _____ ft. depth Shale Packer

8. SCREEN: Not Installed Gravel-Packed
 Type Stainless Diameter 3"
 Slot/Gauze 10 Length: 21"
 Set Between 79 ft. and 83 ft.
 FITTINGS: K-Packer Bremer Check
 Blank Above Screen 1 ft. Other _____

9. STATIC WATER LEVEL:
50 ft. Below Land Surface Flowing

10. PUMPING LEVEL: Below Land Surface
55 ft. After 5 hrs. Pumping at 10 G.P.M.
 Plunger Bailor Air Test Pump

11. WELL HEAD COMPLETION:
 Pitless Adapter 12" Above Grade
 Basement Offset Well House

12. WELL GROUTED? No Yes From 0 to 79 ft.
 Neat Cement Bentonite Other _____
 No. of Bags 1.5 Additives _____

13. NEAREST SOURCE OF POSSIBLE CONTAMINATION:
 Type Septic Distance 35 ft. Direction W
 Type Outflow Distance 35 ft. Direction N

2. FORMATION DESCRIPTION	THICKNESS OF STRATUM	DEPTH TO BOTTOM OF STRATUM
<u>Med. tan sand</u>	<u>37</u>	<u>37</u>
<u>w/B med. sand</u>	<u>4</u>	<u>41</u>
<u>Soft Brn. Clay</u>	<u>2</u>	<u>43</u>
<u>fine muddy sand</u>	<u>12</u>	<u>55</u>
<u>w/B sand & large gravel</u>	<u>28</u>	<u>83</u>

RECEIVED

OCT 25 1999

D.H.D. #10

RECEIVED
 MICH DEPT OF ENVIRONMENTAL PROTECTION

NOV 04 1999

Drinking Water & Radiological Protection
 Ground Water Supply Section
 WELL CONSTRUCTION DIVISION

USE A 2ND SHEET IF NEEDED

15. ABANDONED WELL PLUGGED? Yes No
 Casing Diameter _____ in. Depth: _____ ft.
 PLUGGING MATERIAL: Neat Cement Bentonite Slurry
 Cement/Bentonite Slurry Concrete Grout Bentonite Chips
 No. of Bags _____ Casing Removed? Yes No

16. REMARKS: (Elevation, Source of Data, etc.)

14. PUMP: Not Installed Pump Installation Only
 Manufacturer's Name Star-Rite
 Model Number _____ HP 1/2 Volts 230
 Length of Drop Pipe 65 ft. Capacity 10 G.P.M.
 TYPE: Submersible Jet Other _____
 PRESSURE TANK:
 Manufacturer's Name Well Mate
 Model Number 6 Capacity 20 Gallons 6.0

17. DRILLING MACHINE OPERATOR:
 Employee Subcontractor
 Name Withey

18. WATER WELL CONTRACTOR'S CERTIFICATION:
 This well was drilled under my jurisdiction and this report is true to the best of my knowledge and belief.
High Tide Well Drilling 16-1610
 REGISTERED BUSINESS NAME REGISTRATION NO. _____
 Address 11065 Creighton Rd. Tippecanoe, Ind.
 Signed Sherald Withey Date 10-20-99
 AUTHORIZED REPRESENTATIVE

MICHIGAN DEPARTMENT OF ENVIRONMENTAL PROTECTION
 DRINKING WATER & RADIOLOGICAL PROTECTION DIVISION
WATER WELL AND PUMP RECORD

TAX NO:
40-003-034-013-20

PERMIT NO:
29214

Completion is required under authority of Part 127 Act 368 PA 1978
 Failure to comply is a misdemeanor

1. LOCATION OF WELL
 County: Kalamazoo Township Name: Boardman Fraction: NW 1/4 SW 1/4 Section No.: 3 Town No.: 20 Range No.: 8

Distance and Direction from Road Intersection
Butler Rd Approx 14 mi S. of Woodman Rd.
So Boardman, MI 49680

Street Address & City of Well Location
7627 Butler Rd.

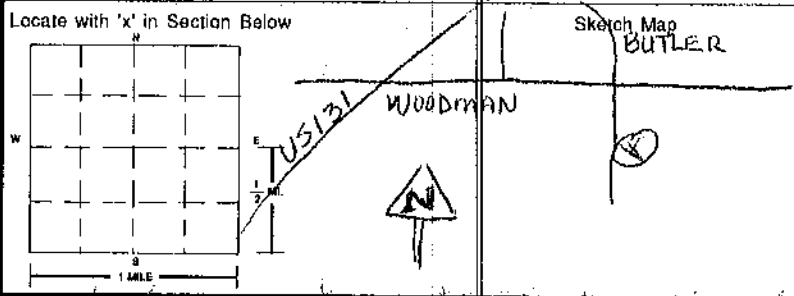

2. FORMATION DESCRIPTION	THICKNESS OF STRATUM	DEPTH TO BOTTOM OF STRATUM
<u>Sand</u>		<u>26</u>
<u>Sand, gravel</u>		<u>60</u>
<u>clay</u>		<u>73</u>
<u>sand, rocks</u>		<u>81</u>
<u>sand, clay</u>		<u>87</u>
<u>Sand</u>		<u>108</u>

15. ABANDONED WELL PLUGGED? Yes No
 Casing Diameter _____ in. Depth _____ ft.
 PLUGGING MATERIAL: Neat Cement Bentonite Slurry
 Cement/Bentonite Slurry Concrete Grout Bentonite Chips
 No. of Bags _____ Casing Removed? Yes No

16. REMARKS: (Elevation, Source of Data, etc.)

17. DRILLING MACHINE OPERATOR:
 Employee Subcontractor
 Name: Doug Schottel

3. OWNER OF WELL
 Name: Pete Schneider
 Address: 6228 Lincoln Rd. E. Cedar, MI 49621
 Address Same as Well Location Yes No

4. WELL DEPTH: 108 ft. Date Completed: 5-20-99
 New Well Replacement Well

5. Cable Tool Rotary Driven Dug
 Hollow Rod Auger/Bored Jetted

6. USE: Household Type I Public Type III Public
 Irrigation Type IIa Public Heat Pump
 Test Well Type IIb Public

7. CASING: Steel Threaded Plastic Welded Other _____
 Height: Above/Below Surface: 1 ft.
 Diameter: 5 in. to _____ ft. depth Weight: SDR21 lbs./ft.
8 1/2 in. to 100 ft. depth
8 1/2 in. to 108 ft. depth
 BORE HOLE: Drive Shoe Shale Packer

8. SCREEN: Not Installed Gravel-Packed
 Type: PVC Diameter: 4"
 Slot/Gravel: 10 Length: 8'
 Set Between: 100 ft. and 108 ft.
 FITTINGS: K-Packer Bremer Check
 Blank Above Screen 2 ft. Other _____

9. STATIC WATER LEVEL:
60 ft. Below Land Surface Flowing

10. PUMPING LEVEL: Below Land Surface
65 ft. After 1/2 hrs. Pumping at _____ G.P.M.
 Plunger Bailor Air Test Pump

11. WELL HEAD COMPLETION:
 Pitless Adapter 12" Above Grade
 Basement Offset Well House

WELL GROUTED? No Yes From 0 to 90 ft.
 Neat Cement Bentonite Other: poly clay
 No. of Bags: 8 Additives: _____

13. NEAREST SOURCE OF POSSIBLE CONTAMINATION:
 Type: Septic Distance: 50 ft. Direction: _____
 Type: _____ Distance: _____ ft. Direction: _____

14. PUMP: Not Installed Pump Installation Only
 Manufacturer's Name: Red Jacket
 Model Number: 2W HP: 1/2 Volts: 230
 Length of Drop Pipe: 95' ft. Capacity: 10 G.P.M.
 TYPE: Submersible Jet Other _____
 PRESSURE TANK:
 Manufacturer's Name: Well Extrol (BURIED)
 Model Number: WR202UG Capacity: 20 Gallons 6.2

18. WATER WELL CONTRACTOR'S CERTIFICATION:
 This well was drilled under my jurisdiction and this report is true to the best of my knowledge and belief.
Phil's Well Drilling, Inc. 0481
 REGISTERED BUSINESS NAME REGISTRATION NO.
 Address: Rennic School Rd. Traverse City, MI 49684
 Signed: Chris Shumway Date: 5-27-99
 AUTHORIZED REPRESENTATIVE

RECEIVED

JUL 02 1999

D.H.D. #10

RECEIVED

JUL 28 1999

MICH DEPT OF ENVIRONMENTAL PROTECTION
 Drinking Water & Radiological Protection Division
 Ground Water Supply Section
 WELL CONSTRUCTION UNIT

USE A 2ND SHEET IF NEEDED

WATER WELL AND PUMP RECORD

Completion is required under authority of Part 127 Act 368 PA 1978
Failure to comply is a misdemeanor

TAX NO: 10-003-034-013-00

PERMIT NO: 27735

1. LOCATION OF WELL
County: **Kalkaska**

Township Name: **Boardman**

Fraction: 1/4 1/4 1/4

Section No: **34**

Town No: **26**

Range No: **8**

Distance and Direction from Road Intersection
7523 Butler Rd. S.W.

Street Address & City of Well Location

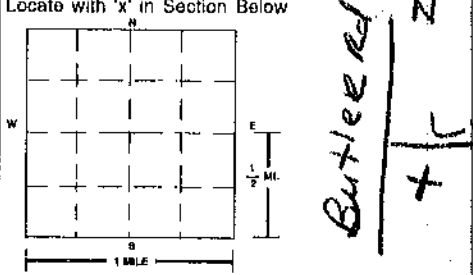

Sketch Map

3. OWNER OF WELL
Address: **William G. Irvine**
536 West 11th Street
South Boardman, MI 49680
Address Same as Well Location Yes No

4. WELL DEPTH: **7/90'** ft. Date Completed: **7/10/98**
 New Well Replacement Well

5. Cable Tool Rotary Driven Dug
 Hollow Rod Auger/Bored Jetted

6. USE: Household Type I Public Type III Public
 Irrigation Type IIa Public Heat Pump
 Test Well Type IIb Public

7. CASING: Steel Threaded Plastic Welded
 Other _____
Height: Above/Below Surface: **1** ft.

Diameter: **5** in. to **8.5** ft. depth
Weight: _____ lbs./ft.
BORE HOLE: Drive Shoe Shale Packer
Diameter: **7 7/8** to **90** ft. depth
in. to _____ ft. depth

8. SCREEN: Not Installed Gravel-Packed
Type: **W.O.P.** Diameter: **4"**
Slot/Gauge: **xxx 8** Length: **5'**
Set Between: **85** ft. and **90** ft.
FITTINGS: K-Packer Bremer Check
 Blank Above Screen _____ ft. Other: **K-Packer**

9. STATIC WATER LEVEL:
71 ft. Below Land Surface Flowing

10. PUMPING LEVEL: **UNKNOWN**
ft. After _____ hrs. Pumping at _____ G.P.M.
 Plunger Bailer Air Test Pump

11. WELL HEAD COMPLETION:
 Pitless Adapter 12" Above Grade
 Basement Offset Well House

12. WELL GROUTED? No Yes From **75** to **0** ft.
 Neat Cement Bentonite Other _____
No. of Bags **7** Additives _____

13. NEAREST SOURCE OF POSSIBLE CONTAMINATION:
Type: **Septic** Distance: **+50** ft. Direction: **S**
Type _____ Distance _____ ft. Direction _____

14. PUMP: Not Installed Pump Installation Only
Manufacturer's Name: **Red Jacket**
Model Number: **50SESWO** HP: **1/2** Volts: **115**
Length of Drop Pipe: **85** ft. Capacity: **10** G.P.M.
TYPE: Submersible Jet Other _____
PRESSURE TANK:
Manufacturer's Name: **PMD 52**
Model Number _____ Capacity _____ Gallons: **52**

2. FORMATION DESCRIPTION	THICKNESS OF STRATUM	DEPTH TO BOTTOM OF STRATUM
Sand	50	50
Clay & Sand Stringers	10	60
Sand	11	71
Tan Clay	04	75
Water Bearing Sand	17	90

RECEIVED

AUG 5 1998

D.H.D. #10

USE A 2ND SHEET IF NEEDED

15. ABANDONED WELL PLUGGED? Yes No
Casing Diameter: **2** in. Depth: **25** ft.
PLUGGING MATERIAL: Neat Cement Bentonite Slurry
 Cement/Bentonite Slurry Concrete Grout Bentonite Chips
No. of Bags _____ Casing Removed? Yes No

16. REMARKS: (Elevation, Source of Data, etc.)

17. DRILLING MACHINE OPERATOR:
 Employee Subcontractor
Name: **Orin Stambaugh**

18. WATER WELL CONTRACTOR'S CERTIFICATION:
This well was drilled under my jurisdiction and this report is true to the best of my knowledge and belief.
PILTZ WATER WELL DRILLING INC 1839
REGISTERED BUSINESS NAME REGISTRATION NO.
Address: **P.O. Box 1408 Kalkaska, MI 49646**
Signed: **Wayne Piltz** Date: **7/10/98**
AUTHORIZED REPRESENTATIVE



2 JUN 16 1980

WATER WELL RECORD
ACT 294 PA 1986

MICHIGAN DEPARTMENT
OF
PUBLIC HEALTH

34

1 LOCATION OF WELL

County: KALKASKA Township Name: BOARDMAN Fraction: SE 1/4 SE 1/4 SE 1/4 Section Number: 33 Town Number: 26 No. Range Number: 8 N.W.

Distance And Direction from Road Intersections: N.E. CORNER OF LUCE AND BUTLER

3 OWNER OF WELL: HENRY ADAMSKI
Address: BOX 53
SOUTH BOARDMAN

Street address & City of Well Location

Locate with "X" in section below

Sketch Map:

4 WELL DEPTH: (completed) 97 ft. Date of Completion 6-11-80

5 Cable tool Rotary Driven Dug
 Hollow rod Jetted Borod

6 USE: Domestic Public Supply Industry
 Irrigation Air Conditioning Commercial
 Test Well

7 CASING: Threaded Welded Height Above/Below Surface 1 ft. Weight 11 lbs./ft. Drive Shoe? Yes No

2 FORMATION

FORMATION	THICKNESS OF STRATUM	DEPTH TO BOTTOM OF STRATUM
Top Soil	1	1
Lg Gravel and fine sand	2	3
Brown sand	8	11
light Brown sand	10	51
Light Brown sand with shells	19	70
Brown CLAY	4	74
Lg coarse sand light brown	23	97

8 SCREEN:

Type: JOHNSON Dia.: 4"
Slot/Gauze 10 Length 11"
Set between 94 ft. and 97 ft.
Fittings:

9 STATIC WATER LEVEL: 73 ft. below land surface

10 PUMPING LEVEL below land surface
73 ft. after 2 hrs. pumping 30 g.p.m.
ft. after ___ hrs. pumping ___ g.p.m.

11 WATER QUALITY in Parts Per Million:
Iron (Fe) ___ Chlorides (Cl) ___
Hardness ___ Other ___

12 WELL HEAD COMPLETION: In Approved Pit
 Pitless Adapter 12" Above Grade

13 Well Grouted? Yes No
 Neat Cement Bentonite
Depth: From ___ ft. to ___ ft.

14 Nearest Source of possible contamination
50 feet NW Direction Septic Type
Well disinfected upon completion Yes No

15 PUMP: Not installed
Manufacturer's Name Goetze
Model Number 102308412 HP 1/2 Volts 120
Length of Drop Pipe 84 ft. capacity 15 G.P.M.
Type: Submersible
 Jet Reciprocating

16 Remarks, elevation, source of data, etc.

ADDED NAME OF DRILLER, ITEM NO.
CORRECTED BY
**ADDITION BY
ELEVATION
DEPTH TO ROCK

17 WATER WELL CONTRACTOR'S CERTIFICATION:
This well was drilled under my jurisdiction and this report is true to the best of my knowledge and belief.

LTD Well Drilling 05-10767
REGISTERED BUSINESS NAME REGISTRATION NO.

Address: RR 353 Hayes tower Rd
GAYLORD, MICH. 49735

Signed: Phillip E. Coan Date 6-12-80
AUTHORIZED REPRESENTATIVE

DEC 30 1980



DEC 30 1980

WATER WELL RECORD
ACT 294 PA 1965

MICHIGAN DEPARTMENT OF PUBLIC HEALTH

1 LOCATION OF WELL

County Kalkaska	Township Name Boardman	Fraction SW 1/4 SW 1/4 NW 1/4	Section Number 34	Town Number 26 N.W.	Range Number 8 E/W.
---------------------------	----------------------------------	---	-----------------------------	-------------------------------	-------------------------------

Distance And Direction from Road Intersections
**N.E. Corner of Butler & Luce Rd.
Green & white mobile**

Street address & City of Well Location

Locate with "X" in section below

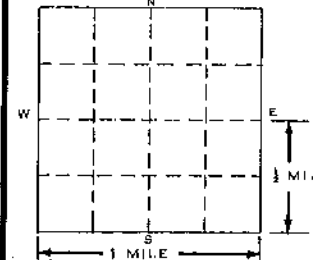

Sketch Map:

3 OWNER OF WELL:

La Vlen Schoenemann
Address **Box 84 Butler Rd.
So. Boardman, Mich. 49680**

4 WELL DEPTH: (completed) Date of Completion
110 ft. 9/16/80

5 Cable tool Rotary Driven Dug
 Hollow rod Jetted Bored _____

6 USE: Domestic Public Supply Industry
 Irrigation Air Conditioning Commercial
 Test Well _____

7 CASING: Threaded Welded Height: Above ~~95~~ ¹⁰⁰ Surface **1** ft.
Diam. **4** in. to **105** ft. Depth Weight **11** lbs./ft.

_____ in. to _____ ft. Depth Drive Shoe? Yes No

2 FORMATION

THICKNESS OF STRATUM DEPTH TO BOTTOM OF STRATUM

sand	80'	80'
clay	5'	85'
waterbearing sand	25'	110'

8 SCREEN: **stainless steel**
Type: **Drop** Dia.: **3"**
Slot/Gauge: **7** Length **5'**
Set between **105** ft. and **110** ft.
Fittings: **check valve**

9 STATIC WATER LEVEL
75 ft. below land surface

10 PUMPING LEVEL below land surface
_____ ft. after _____ hrs. pumping _____ g.p.m.
_____ ft. after _____ hrs. pumping _____ g.p.m.

11 WATER QUALITY in Parts Per Million:
Iron (Fe) _____ Chlorides (Cl) _____
Hardness _____ Other _____

12 WELL HEAD COMPLETION: In Approved Pit
202 x-trol bury tank Pitless Adapter 12" Above Grade

13 Well Grouted? Yes No
 Neat Cement Bentonite _____
Depth: From _____ ft. to _____ ft.

14 Nearest Source of possible contamination
50 feet **ne** Direction **septic tank** Type
Well disinfected upon completion Yes No

15 PUMP: Not installed
Manufacturer's Name **Goulds**
Model Number **100J** HP **1/2** Volts **220**
Length of Drop Pipe **75** ft. capacity **10** G.P.M.
Type: Submersible
 Jet Reciprocating

USE A 2ND SHEET IF NEEDED

16 Remarks, elevation, source of data, etc.

FOUNDED BY BUTLER, LUCE RD.
CONSTRUCTED BY **S.P.A.**
ELEVATION
DEPTH TO ROCK

17 WATER WELL CONTRACTOR'S CERTIFICATION:

This well was drilled under my jurisdiction and this report is true to the best of my knowledge and belief.
Kibby's Water Well Drilling, Inc. 1219
REGISTERED BUSINESS NAME REGISTRATION NO.
Address **Box 122 So. Boardman, Mich. 49680**
Signed **Harold Schoenemann** Date **9/16/80**
AUTHORIZED REPRESENTATIVE

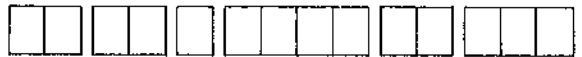

WATER WELL RECORD

ACT 294 PA 1965

MICHIGAN DEPARTMENT
OF
PUBLIC HEALTH

1 LOCATION OF WELL MAY 07 1981

County Kalkaska	Township Name Boardman	Fraction SW 1/4 SW 1/4 NW 1/4	Section Number 34	Town Number 26 N/S.	Range Number 8 N/W.
---------------------------	----------------------------------	---	-----------------------------	-------------------------------	-------------------------------

Distance And Direction from Road Intersections
Corner of Butler and Luce
Northeast corner

Street address & City of Well Location
Locate with "X" in section below

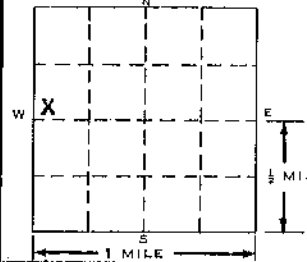

Sketch Map:

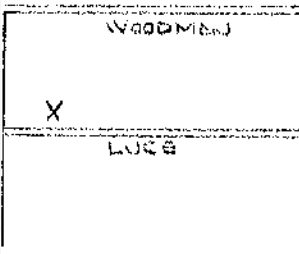

3 OWNER OF WELL:

Mary Hall
Address **Route #1, Box 25**
South Boardman, MI

4 WELL DEPTH: (completed) **87** ft. Date of Completion **5-1-81**

5 Cable tool Rotary Driven Dug
 Hollow rod Jetted Bored

6 USE: Domestic Public Supply Industry
 Irrigation Air Conditioning Commercial
 Test Well

7 CASING: Threaded Welded
Diam. _____ Height: Above/Below Surface **5** ft.

2 in. to **83** ft. Depth Weight _____ lbs./ft.
_____ in. to _____ ft. Depth Drive Shoe? Yes No

8 SCREEN:

Type: **Stainless steel** Dia.: **1 1/4"**
Slot/Gauze _____ Length **48"**
Set between **83** ft. and **87** ft.
Fittings: **1 1/4" coupling & Bremer check**

9 STATIC WATER LEVEL

72 ft. below land surface
10 PUMPING LEVEL below land surface
_____ ft. after _____ hrs. pumping _____ a.p.m.
_____ ft. after _____ hrs. pumping _____ a.p.m.

11 WATER QUALITY (in Parts Per Million):

Iron (Fe) _____ Chlorides (Cl) _____
Hardness _____ Other _____

12 WELL HEAD COMPLETION: In Approved Pit
 Pitless Adapter 12" Above Grade

13 Well Grouted? Yes No
 Neat Cement Bentonite _____
Depth: From _____ ft. to _____ ft.

14 Nearest Source of possible contamination
_____ feet _____ Direction _____ Type
Well disinfected upon completion Yes No

15 PUMP: Not installed
Manufacturer's Name **Fairbank Moore**
Model Number _____ HP **1** Volts **230**
Length of Drop Pipe **72** ft. capacity **5** G.P.M.
Type: Submersible Jet Reciprocating

2 FORMATION

THICKNESS OF STRATUM DEPTH TO BOTTOM OF STRATUM

Dry coarse sand	68	68
Brown damp clay	2	70
fine sand	6	76
Coarse water sand	11+	87+

USE A 2ND SHEET IF NEEDED

16 Remarks, elevation, source of data, etc.
ADDED INFO BY DRILLER, ITEM NO.
*CORRECTED BY _____
**ADDITION BY _____
ELEVATION _____
DEPTH TO ROCK _____

17 WATER WELL CONTRACTOR'S CERTIFICATION:

This well was drilled under my jurisdiction and this report is true to the best of my knowledge and belief.
Wilcox Well Drilling **1788**
REGISTERED BUSINESS NAME REGISTRATION NO.
Address **7230 N. U.S.-131, Manton, Michigan 49663**
Signed *Wayne Pitts* Date **5-5-81**
AUTHORIZED REPRESENTATIVE

DEC 26 1979

WATER WELL RECORD
ACT 294 PA 1966

MICHIGAN DEPARTMENT
OF
PUBLIC HEALTH

1 LOCATION OF WELL

County Kalkaska	Township Name Boardman	Fraction ne ¼ ne ¼ se ¼	Section Number 34	Town Number 26 N.W.	Range Number 8 X/W.
---------------------------	----------------------------------	-----------------------------------	-----------------------------	-------------------------------	-------------------------------

Distance And Direction from Road Intersections
S W Corner of Creighton Rd. & Luce Rd.

Street address & City of Well Location
Locate with "X" in section below

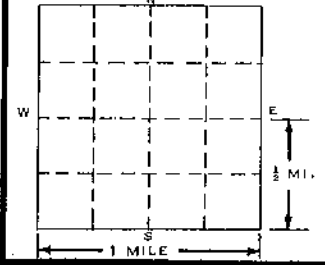

Sketch Map:

3 OWNER OF WELL:
Kenneth Calrk
Address **So. Boardman, Mich. 49680**

4 WELL DEPTH: (completed) **68** ft. Date of Completion **9/26/79**

5 Cable tool Rotary Driven Dug
 Hollow rod Jetted Bored

6 USE: Domestic Public Supply Industry
 Irrigation Air Conditioning Commercial
 Test Well

7 CASING: Threaded Welded Height: Above ~~200~~ Surface **1** ft.
Diam. **4** in. to **63** ft. Depth Weight **11** lbs./ft.
4 in. to _____ ft. Depth Drive Shoe? Yes No

2 FORMATION

FORMATION	THICKNESS OF STRATUM	DEPTH TO BOTTOM OF STRATUM
Sand	50'	50'
Waterbearing sand	18'	68'

8 SCREEN: **stainless steel drive** Dia.: **3"**
Type: _____ Slot/Groove ~~XXXX~~ **7** Length **5'**
Set between **63** ft. and **68** ft.
Fittings: **check valve**

9 STATIC WATER LEVEL
50 ft. below land surface

10 PUMPING LEVEL below land surface
_____ ft. after _____ hrs. pumping _____ g.p.m.
_____ ft. after _____ hrs. pumping _____ g.p.m.

11 WATER QUALITY in Parts Per Million:
Iron (Fe) _____ Chlorides (Cl) _____
Hardness _____ Other _____

12 WELL HEAD COMPLETION: ~~202x-601~~ **bury tank** Approved Pit
 Pitless Adapter 12" Above Grade

13 Well Grouted? Yes No
 Neat Cement Bentonite
Depth: From _____ ft. to _____ ft.

14 Nearest Source of possible contamination
50 feet **N** Direction **Septic tank** Type
Well disinfected upon completion Yes No

15 PUMP: Not Installed
Manufacturer's Name **Goulds**
Model Number **10EJ** HP **½** Volts **220**
Length of Drop Pipe **56** ft. capacity _____ G.P.M.
Type: Submersible Jet Reciprocating

16 Remarks, elevation, source of data, etc.

ADDED INFO BY DRILLER, ITEM NO.
*CORRECTED BY *[Signature]*
**ADDITION BY
ELEVATION
DEPTH TO ROCK

17 WATER WELL CONTRACTOR'S CERTIFICATION:
This well was drilled under my jurisdiction and this report is true to the best of my knowledge and belief.
Kibby's Water Well Drilling, Inc. 1219
REGISTERED BUSINESS NAME REGISTRATION NO.
Address **Box 122 So. Boardman, Michigan 49680**
Signed *Hilda Schaefer* date **9/26/79**
AUTHORIZED REPRESENTATIVE

MAR 14 1974

WATER WELL RECORD
ACT 294 PA 1965

MICHIGAN DEPARTMENT
OF
PUBLIC HEALTH

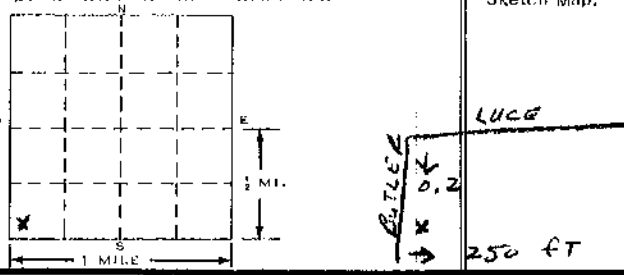
1 LOCATION OF WELL											
County KALKASKA		Township Name BOARDMAN		Fraction NW SW 1/4 SW 1/4		Section Number 34		Town Number 26 N.E.		Range Number 8 E.W.	
Distance And Direction from Road 250 FT WEST OF BUTLER ROAD AND 0.2 MILE SOUTH OF LUCE ROAD		Sketch Map: 		3 OWNER OF WELL: ROD WILSON Address BUTLER ROAD So. BOARDMAN, MICH 49680		4 WELL DEPTH: (completed) Date of Completion 114 ft. 2-25-74		5 <input type="checkbox"/> Cable tool <input type="checkbox"/> Rotary <input type="checkbox"/> Driven <input type="checkbox"/> Aug <input type="checkbox"/> Hollow rod <input type="checkbox"/> Jetted <input checked="" type="checkbox"/> Bored <input type="checkbox"/>		6 USE: <input checked="" type="checkbox"/> Domestic <input type="checkbox"/> Public Supply <input type="checkbox"/> Industry <input type="checkbox"/> Irrigation <input type="checkbox"/> Air Conditioning <input type="checkbox"/> Commercial <input type="checkbox"/> Test Well	
Street address & City of Well Location Locate with "X" in section below		THICKNESS OF STRATUM		DEPTH TO BOTTOM OF STRATUM		7 CASING: Threaded <input checked="" type="checkbox"/> Welded <input type="checkbox"/> Diam. _____ Height: _____/Below Surface _____ ft. Weight 3.75 lbs./ft. Drive Shoe? Yes <input type="checkbox"/> No <input checked="" type="checkbox"/>		8 SCREEN: Type: STAINLESS STEEL Dia.: 1 1/4" Slot/Gauze 60 Length 5 feet Set between 109 ft. and 114 ft. Fittings: CHECK VALVE		9 STATIC WATER LEVEL 74 ft. below land surface	
2 FORMATION		YELLOW SAND		95		95"		10 PUMPING LEVEL below land surface _____ ft. after _____ hrs. pumping _____ g.p.m. _____ ft. after _____ hrs. pumping _____ g.p.m.		11 WATER QUALITY in Parts Per Million: Iron (Fe) _____ Chlorides (Cl) _____ Hardness _____ Other _____	
WATER BEARING COARSE SAND		19		114				12 WELL HEAD COMPLETION: <input checked="" type="checkbox"/> In Approved Pit <input type="checkbox"/> Pitless Adapter <input type="checkbox"/> 12" Above Grado		13 Well Grouted? <input type="checkbox"/> Yes <input checked="" type="checkbox"/> No <input type="checkbox"/> Neat Cement <input type="checkbox"/> Bentonite <input type="checkbox"/> Depth: From _____ ft. to _____ ft.	
								14 Nearest Source of possible contamination 50 foot NW Direction SEWER Type Well disinfected upon completion <input checked="" type="checkbox"/> Yes <input type="checkbox"/> No		15 PUMP: <input type="checkbox"/> Not installed Manufacturer's Name RAPIDYTON Model Number 10E3 HP 1 Volts 220 Length of Drop Pipe 106 ft. capacity 12 G.P.M. Type: <input type="checkbox"/> Submersible <input checked="" type="checkbox"/> Jet <input type="checkbox"/> Reciprocating	
16 Remarks, elevation, source of data, etc. ADDED INFO BY DRILLER, ITEM NO. *CORRECTED BY **ADDITION BY ELEVATION DEPTH TO ROCK		17 WATER WELL CONTRACTOR'S CERTIFICATION: This well was drilled under my jurisdiction and this report is true to the best of my knowledge and belief. KIBBY'S WATER WELL DRILLING 1219 REGISTERED BUSINESS NAME REGISTRATION NO. Address P O Box 122 Signed Louis Kibby Date 2/27/74 AUTHORIZED REPRESENTATIVE									

USE A 2ND SHEET IF NEEDED



OCT 30 1972

WATER WELL RECORD

ACT 294 PA 1966

MICHIGAN DEPARTMENT OF PUBLIC HEALTH

SW SW NW

1 LOCATION OF WELL

County	Township Name	Fraction	Section Number	Town Number	Range Number
Kalkaska	Boardman	SW 1/4 NE 1/4	34	T26 N1	R8 W1

Distance And Direction from Road Intersections
 about 0.3 mi. west of Creighton Road
 about 100 Ft. North of Luce Rd.

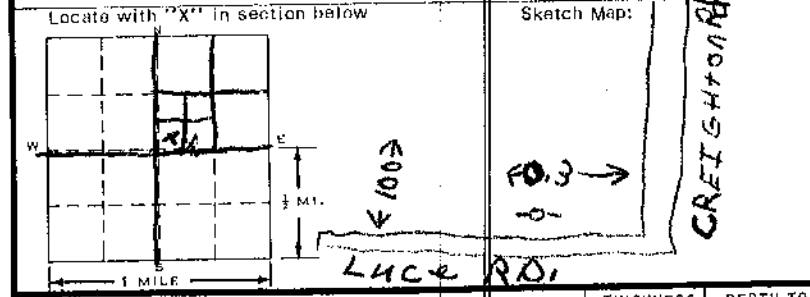

3 OWNER OF WELL:
 John SCHUILLING
 Address BOX 98
 So. Boardman, Mich.

4 WELL DEPTH: (completed) Date of Completion
 72 ft. 4/3/72

5 Cable tool Rotary Driven Dug
 Hollow rod Jetted Bored

6 USE: Domestic Public Supply Industry
 Irrigation Air Conditioning Commercial
 Test Well

7 CASING: Threaded Welded
 Diam. Height: ~~above~~ Below Surface _____ ft.
 2 in. to 68 ft. Depth Weight 3.75 lbs./ft.
 _____ in. to _____ ft. Depth Drive Shoe? Yes No

2 FORMATION

FORMATION	THICKNESS OF STRATUM	DEPTH TO BOTTOM OF STRATUM
Gray Sand	0	10
Sand, yellow	55	65
Coarse yellow sand	7	72

8 SCREEN:
 Type: Stainless Steel Dia.: 1 1/2
 Slot/Gauze 80 Length 4 FT
 Set between 68 ft. and 72 ft.
 Fittings: Check Valve

9 STATIC WATER LEVEL
 27 ft. below land surface

10 PUMPING LEVEL below land surface
 67 ft. after 1 hrs. pumping 8 g.p.m.
 _____ ft. after _____ hrs. pumping _____ g.p.m.

RECEIVED
 APR 17 1972
 DIST. HEALTH DEPT.

11 WATER QUALITY in Parts Per Million:
 Iron (Fe) _____ Chlorides (Cl) _____
 Hardness _____ Other _____

12 WELL HEAD COMPLETION: in Approved Pit
 Pitless Adapter 12" Above Grade

13 Well Grouted? Yes No
 Neat Cement Bentonite
 Depth: From _____ ft. to _____ ft.

14 Nearest Source of possible contamination
 50 feet NE. Direction Sewer Type
 Well disinfected upon completion Yes No

15 PUMP: Not installed
 Manufacturer's Name Rapidayton
 Model Number _____ HP 1 Volts 220
 Length of Drop Pipe 60 ft. capacity 8 G.P.M.
 Type: Submersible Jet Reciprocating

16 Remarks, elevation, source of data, etc.
 Done By Kibby's Well Drilling
 Box 81 South Boardman Mich.
 49680

17 WATER WELL CONTRACTOR'S CERTIFICATION:
 This well was drilled under my jurisdiction and this report is true to the best of my knowledge and belief.
 Gonyon Well Drilling 0849
 REGISTERED BUSINESS NAME REGISTRATION NO.
 Address 656 Chatterson Rd. Mackayon
 Signed Guy E. Gonyon 4/13/72
 AUTHORIZED REPRESENTATIVE

ADDED INFO. BY DRILLER, ITEM NO.
 CORRECTED BY:
 ADDITION BY:
 USE A 2ND SHEET IF NEEDED



MAR 06 1973 WATER WELL RECORD
ACT 294 PA 1965

MICHIGAN DEPARTMENT
OF
PUBLIC HEALTH

1 LOCATION OF WELL

County Kalamazoo Township Name Boonman Fraction SW 1/4 SE 1/4 NW 1/4 Section Number 34 Town Number 26 N Range Number 8 W

Distance And Direction from Road Intersections _____
Street address & City of Well Location _____
Locate with "X" in section below

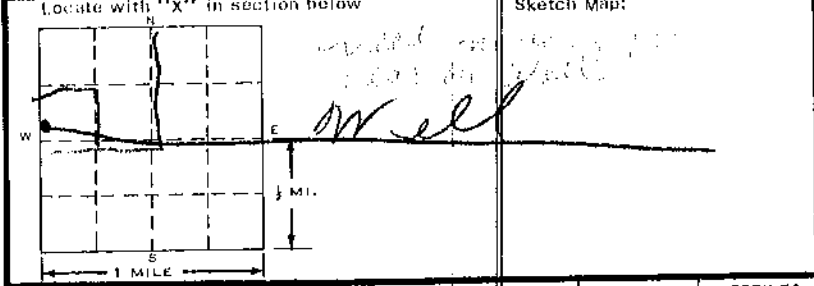

3 OWNER OF WELL:
Name Walter Spine
Address Butler Road

4 WELL DEPTH: (completed) 82 ft. Date of Completion 9-3-71

5 Cable tool Rotary Driven Dug
 Hollow rod Jetted Bored

6 USE: Domestic Public Supply Industry
 Irrigation Air Conditioning Commercial
 Test Well

7 CASING: Threaded Welded
Height: Above/Below Surface _____ ft.
Weight _____ lbs./ft.
Drive Shoe? Yes No

2 FORMATION

FORMATION	THICKNESS OF STRATUM	DEPTH TO BOTTOM OF STRATUM
<u>Sand & Gravel</u>	<u>0</u>	<u>20</u>
<u>Coarse yellow sand</u>	<u>20</u>	<u>40</u>
<u>yellow sand & gravel</u>	<u>40</u>	<u>60</u>
<u>Yellow Clay</u>	<u>60</u>	<u>68</u>
<u>Water bearing sand</u>	<u>68</u>	<u>82</u>
<u>unable to verify</u>		
<u>D 3/4</u>		

8 SCREEN:
Type Cast Iron Dia. 1 1/4 in
Slot/Gauze 40 Length 4 ft
Set between 78 ft. and 82 ft.
Fittings: 2 x 1/4 Reducing Coupl

9 STATIC WATER LEVEL
68 ft. below land surface

10 PUMPING LEVEL below land surface
_____ ft. after _____ hrs. pumping _____ g.p.m.
Unknown
_____ ft. after _____ hrs. pumping _____ g.p.m.

11 WATER QUALITY in Parts Per Million:
Iron (Fe) _____ Chlorides (Cl) _____
Unknown
Hardness _____ Other _____

12 WELL HEAD COMPLETION: In Approved Pit
 Pitless Adapter 12" Above Grade

13 Well Grouted? Yes No
 Neat Cement Bentonite
Depth: From _____ ft. to _____ ft.

14 Nearest Source of possible contamination
_____ feet _____ Direction _____ Type _____
Well disinfected upon completion Yes No

15 PUMP: Not installed
Manufacturer's Name _____
Model Number _____ HP _____ Volts _____
Length of Drop Pipe _____ ft. capacity _____ G.P.M.
Type: Submersible Jet Reciprocating

16 Remarks, elevation, source of data, etc.
ADDED INFO BY DRILLER, AGENS AND _____
CORRECTED BY _____
ADDITION _____

17 WATER WELL CONTRACTOR'S CERTIFICATION:
This well was drilled under my jurisdiction and this report is true to the best of my knowledge and belief.
Wayne P. Zylke REGISTRATION NO. _____
Address Pike Lake, Mich
Signed Wayne P. Zylke AUTHORIZED REPRESENTATIVE Date 9-3-71