

DEPARTMENT OF ENVIRONMENTAL QUALITY
 AIR QUALITY DIVISION
 ACTIVITY REPORT: Self Initiated Inspection

U6906009550976

FACILITY: UNKNOWN		SRN / ID: U69060095
LOCATION: OTSEGO COUNTY, OTSEGO		DISTRICT: Cadillac
CITY: OTSEGO		COUNTY: OTSEGO
CONTACT:		ACTIVITY DATE: 10/15/2019
STAFF: Sharon LeBlanc	COMPLIANCE STATUS: Compliance	SOURCE CLASS:
SUBJECT: Wescoat Pit- Martindale and North Townline Road, Vanderbilt, Otsego County, Michigan. Screening operation next to Reith Riley Pit. sgl		
RESOLVED COMPLAINTS:		

On Tuesday, October 15, 2019, AQD District Staff visited the Wescoat Pit, located at the NE corner of the intersection of North Townline Road, and Martindale Road, Vanderbilt, Michigan. A relocation notice for crushing equipment had been received by the District office on September 30, 2019, from Fisher Sand & Gravel, for relocation of crushing and screening equipment associated with their "stone pit" crusher (N5974). The relocation indicated that the equipment would relocate on October 7, 2019, to complete an approximately 50,000 ton job.

District Staff arrived onsite to find that the Fisher Plant had not yet been relocated, and that a small screening plant was located on the site. In addition to the feed hopper, the plant consisted of a Finlay 390 screen (ID 4490) and two Finlay conveyors with the same equipment IDs. A number of excavators and front end loaders were present, but operators for the equipment were not onsite. Photos of the equipment are attached.

Note that screening plants are exempt from permitting under Rule 285(2)(t) for Equipment for the mining and screening of uncrushed sand, gravel, soil and other inorganic soil-like materials.

District Staff spoke with Fisher Sand & Gravel representative regarding the equipment mobilization date, and was told that the stone pit crusher had broken down and would not be used for the job. That a relocation for P0806 had been submitted as soon as the equipment had broken down. Equipment for the job is anticipated to be relocated by the end of the month.

The adjacent Reith-Riley pit was also not operating at the time of the site inspection.

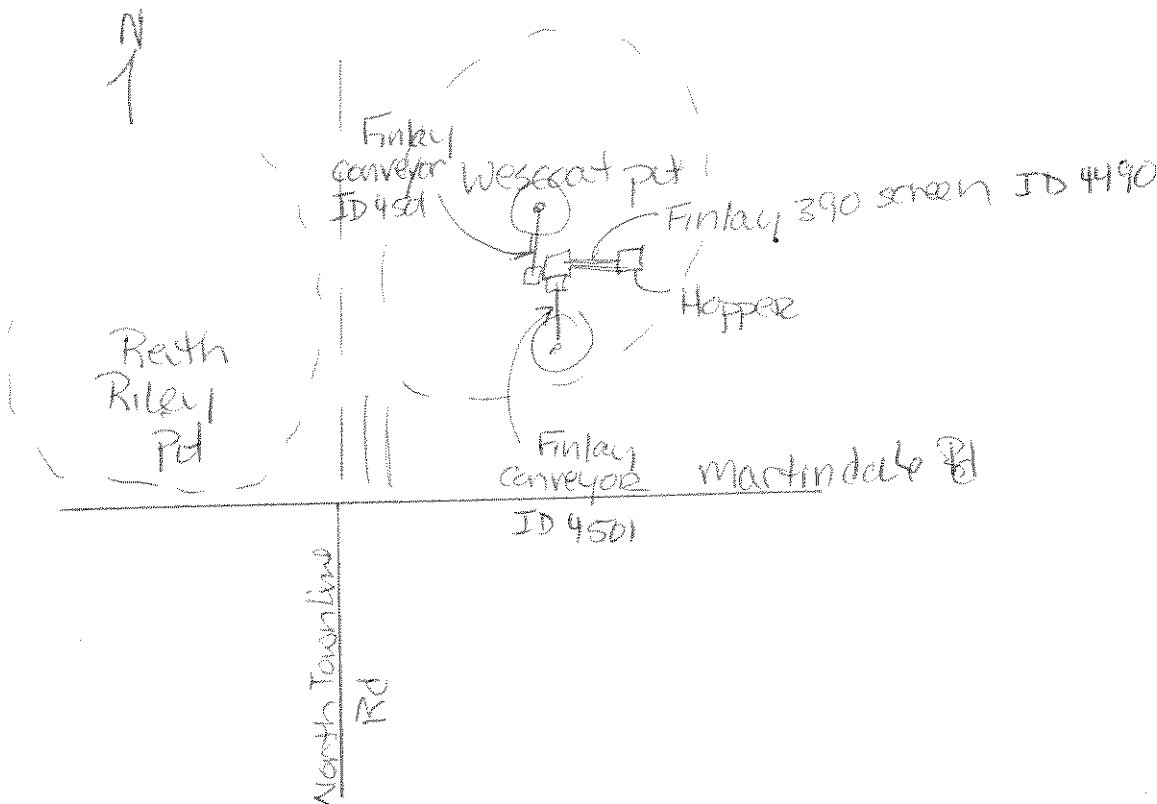



Image 1(screen discharge) : view of screen discharge points. Note that the Finlay 390 screen (Id 4490) discharges into 2 different conveyors. Both have the same ID no. "4501"



Image 2(sideview of screen) : sideview of finlay390 screen (Id 4490) showing the two discharge points onto conveyors, both finlay conveyors, with the same ID (Id 4501).



Image 3(feedhopper) : view of feed hopper and prescreen portion of finlay 390 screen (ID 4490)

NAME Sharon DeBlac

DATE 10/15/19

SUPERVISOR SN